

Sports Illustrated Stadium, Harrison, New Jersey, USA



UBS Arena, Elmont, New York, USA



Tottenham Hotspur FC Training Ground, Tottenham, London, UK



Iowa Women of Achievement Bridge, Des Moines, Iowa, USA

## Anchor Park

Port Wentworth, GA



Sales Representative: Josiah Smith · Designed By: Kolten Hinrichsen · Design No.: 246162A · June 19, 2025

**Anchor Park**  
Port Wentworth, GA

**LIGHTING SYSTEM**

Structure/Fixture Summary						
Structure ID	Structure Height	Fixt. Attachment Ht.	Fixture Qty	Fixture Type	Design Load	Circuit
F1-F2	70'	70'	1	TLC-LED-1200	1.16 kW	A
		70'	2	TLC-LED-1200	2.33 kW	D
		70'	7	TLC-LED-1500	9.78 kW	A
		16'	2	TLC-BT-575	1.15 kW	A
F3-F4	70'	70'	1	TLC-LED-1200	1.16 kW	A
		70'	7	TLC-LED-1500	9.78 kW	A
		16'	2	TLC-BT-575	1.15 kW	A
F5-F6	70'	70'	1	TLC-LED-1200	1.16 kW	B
		70'	2	TLC-LED-1200	2.33 kW	C
		70'	7	TLC-LED-1500	9.78 kW	B
F7-F8	70'	16'	2	TLC-BT-575	1.15 kW	B
		70'	1	TLC-LED-1200	1.16 kW	B
		70'	2	TLC-LED-1200	2.33 kW	D
		70'	7	TLC-LED-1500	9.78 kW	B
		16'	2	TLC-BT-575	1.15 kW	B
<b>8</b>			<b>92</b>		<b>110.73 kW</b>	

\*Fixtures in this design have dimmed output values to meet design specific needs.

Circuit Summary			
Circuit	Description	Design Load	Fixture Qty
A	Football/Soccer 1	48.38 kW	40
B	Football/Soccer 2	48.38 kW	40
C	Playground	4.66 kW	4
D	Bleachers/Concourse	9.32 kW	8

Fixture Type Summary								
Type	Circuit	Source	Avg. Wattage	Avg. Lumens	L90	L80	L70	Quantity
TLC-BT-575	A	LED 5700K - 75 CRI	575W	52,651	>120,000	>120,000	>120,000	8
TLC-BT-575	B	LED 5700K - 75 CRI	575W	52,651	>120,000	>120,000	>120,000	8
TLC-LED-1200	A	LED 5700K - 75 CRI	1165W	156,661	>120,000	>120,000	>120,000	4
TLC-LED-1200	B	LED 5700K - 75 CRI	1165W	156,661	>120,000	>120,000	>120,000	4
TLC-LED-1200	C	LED 5700K - 75 CRI	1165W	155,852	>120,000	>120,000	>120,000	4
TLC-LED-1200	D	LED 5700K - 75 CRI	1165W	145,186	>120,000	>120,000	>120,000	8
TLC-LED-1500	A	LED 5700K - 75 CRI	1397W	184,814	>120,000	>120,000	>120,000	28
TLC-LED-1500	B	LED 5700K - 75 CRI	1397W	184,814	>120,000	>120,000	>120,000	28

Single Fixture Amperage Draw Chart							
Driver Specifications (.90 min power factor)	Line Amperage Per Fixture (max draw)						
	Single Phase Voltage	208 (60)	220 (60)	240 (60)	277 (60)	347 (60)	380 (60)
TLC-LED-1500	8.4	7.9	7.3	6.3	5.0	4.6	3.6
TLC-LED-1200	6.9	6.5	6.0	5.2	4.2	3.8	3.0
TLC-BT-575	3.3	3.2	2.9	2.5	2.0	1.8	1.5

\*Amp draw based on 100% fixture output, consult design specific datasheet for adjusted amperage draw chart

**Light Level Summary**

Calculation Grid Summary								
Grid Name	Calculation Metric	Illumination Ave					Circuits	Fixture Qty
		Ave	Min	Max	Max/Min	Ave/Min		
Bleachers/Concourse	Horizontal	28.35	14.54	43.71	3.01	1.95	D	8
Football 1	Horizontal Illuminance	54.39	44.81	65.14	1.45	1.21	A	40
Football 2	Horizontal Illuminance	54.40	43.52	63.26	1.45	1.25	B	40
Playground	Horizontal	13.54	2.60	28.17	10.82	5.20	C	4
Playground 2	Horizontal	14.20	3.78	28.20	7.46	3.76	C	4
Project Spill @ 3.00ft.	Horizontal Illuminance	0.0475	0.0024	0.1751	72.278	19.622	A,B,D	88
Project Spill @ 5.00ft.	Max Candela Metric	3631.5957	305.7612	8148.0610	26.648	11.877	A,B,D	88
Project Spill @ 5.00ft.	Max Vertical Illuminance Metric	0.1103	0.0045	0.2804	62.471	24.582	A,B,D	88
Project Spill @ 5.00ft.	True Max Vert Illuminance Metric	0.1097	0.0040	0.2680	66.531	27.233	A,B,D	88
Soccer 1	Horizontal Illuminance	54.08	44.81	65.14	1.45	1.21	A	40
Soccer 2	Horizontal Illuminance	54.11	43.52	63.26	1.45	1.24	B	40

**Guaranteed Performance:** The ILLUMINATION described above is guaranteed per your Musco Warranty document.

**Field Measurements:** Individual field measurements may vary from computer-calculated predictions.

**Electrical System Requirements:** Refer to Amperage Draw Chart and/or the "Musco Control System Summary" for electrical sizing.

**Installation Requirements:** Results assume ± 3% nominal voltage at line side of the driver and structures located within 3 feet (1m) of design locations.



Structure				Fixtures				
QTY	STRUCTURE ID	SIZE	GRADE ELEVATION	ABOVE FIELD LEVEL	FIXTURE TYPE	QTY/POLE	THIS GRID	OTHER GRIDS
2	F1-F2	70'	-	70'	TLC-LED-1200	1/2*	1	2
				70'	TLC-LED-1500	7	7	0
				15.5'	TLC-BT-575	2	2	0
2	F3-F4	70'	-	70'	TLC-LED-1200	1	1	0
				70'	TLC-LED-1500	7	7	0
				15.5'	TLC-BT-575	2	2	0
4	Totals					44	40	4

Above Field Level is height of fixtures above area shown  
 \*This structure utilizes a back-to-back mounting configuration

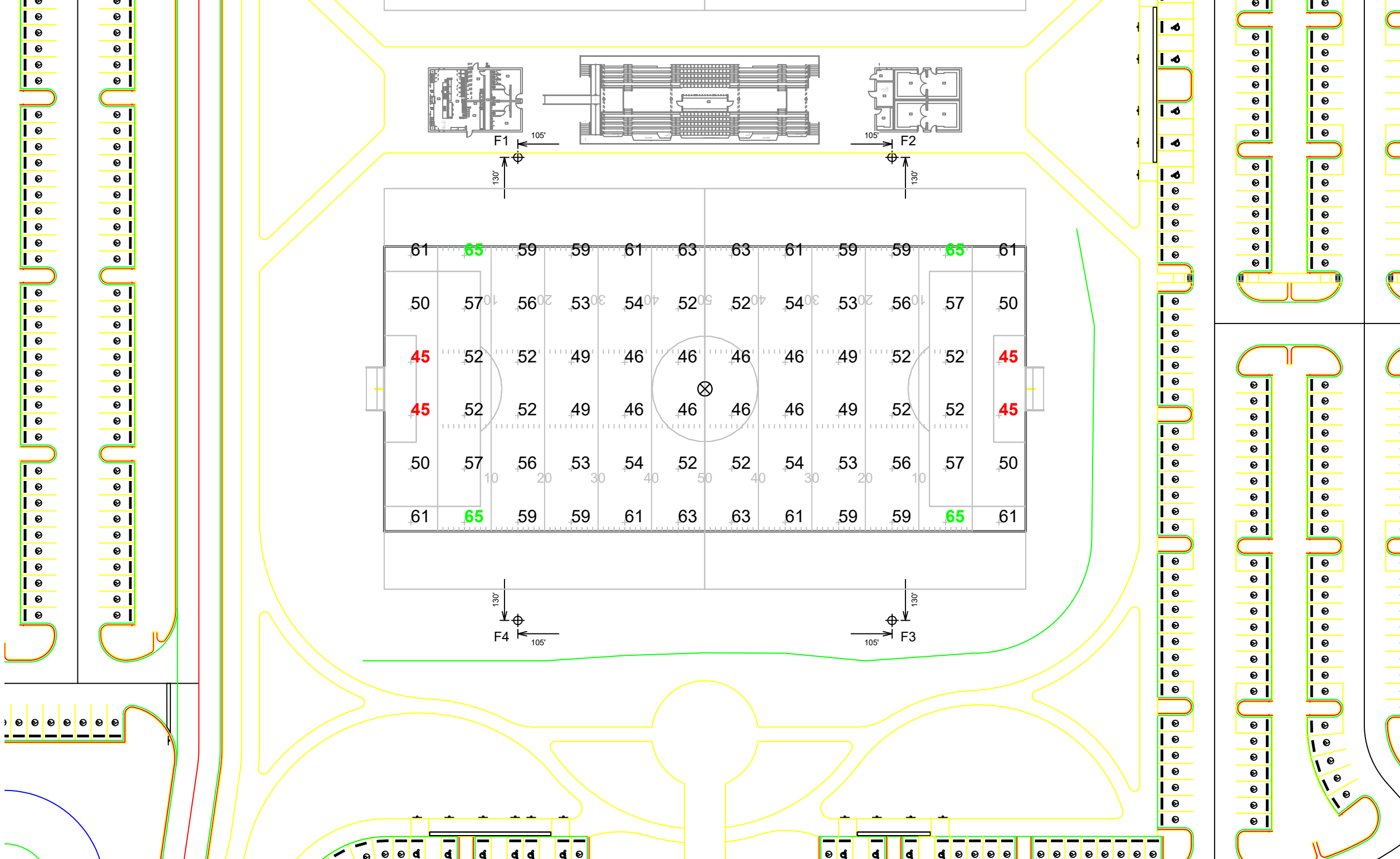

### Anchor Park

Port Wentworth, GA

Grid Summary	
Name:	Football 1
Size:	360' x 160'
Spacing:	30.0' x 30.0'
Height:	3.0' above grade

Illumination Summary	
MAINTAINED HORIZONTAL FOOTCANDLES	
Entire Grid	
<b>Guaranteed Average:</b>	<b>50</b>
Scan Average:	54.39
Maximum:	65.14
Minimum:	44.81
Avg/Min:	1.21
<b>Guaranteed Max/Min:</b>	<b>2</b>
Max/Min:	1.45
UG (adjacent pts):	1.22
CU:	0.57
No. of Points:	72
<b>FIXTURE INFORMATION</b>	
Applied Circuits:	A
<b>No. of Fixtures:</b>	<b>40</b>
Total Load:	48.38 kW

**Guaranteed Performance:** The ILLUMINATION described above is guaranteed per your Musco Warranty document.

**Field Measurements:** Individual field measurements may vary from computer-calculated predictions.

**Electrical System Requirements:** Refer to Amperage Draw Chart and/or the "Musco Control System Summary" for electrical sizing.

**Installation Requirements:** Results assume ± 3% nominal voltage at line side of the driver and structures located within 3 feet (1m) of design locations.

Pole location(s) ⊕ dimensions are relative to 0,0 reference point(s) ⊗



Structure				Fixtures				
QTY	STRUCTURE ID	SIZE	GRADE ELEVATION	ABOVE FIELD LEVEL	FIXTURE TYPE	QTY/POLE	THIS GRID	OTHER GRIDS
2	F1-F2	70'	-	70'	TLC-LED-1200	1/2*	1	2
				70'	TLC-LED-1500	7	7	0
				15.5'	TLC-BT-575	2	2	0
2	F3-F4	70'	-	70'	TLC-LED-1200	1	1	0
				70'	TLC-LED-1500	7	7	0
				15.5'	TLC-BT-575	2	2	0
4	Totals					44	40	4

Above Field Level is height of fixtures above area shown  
 \*This structure utilizes a back-to-back mounting configuration

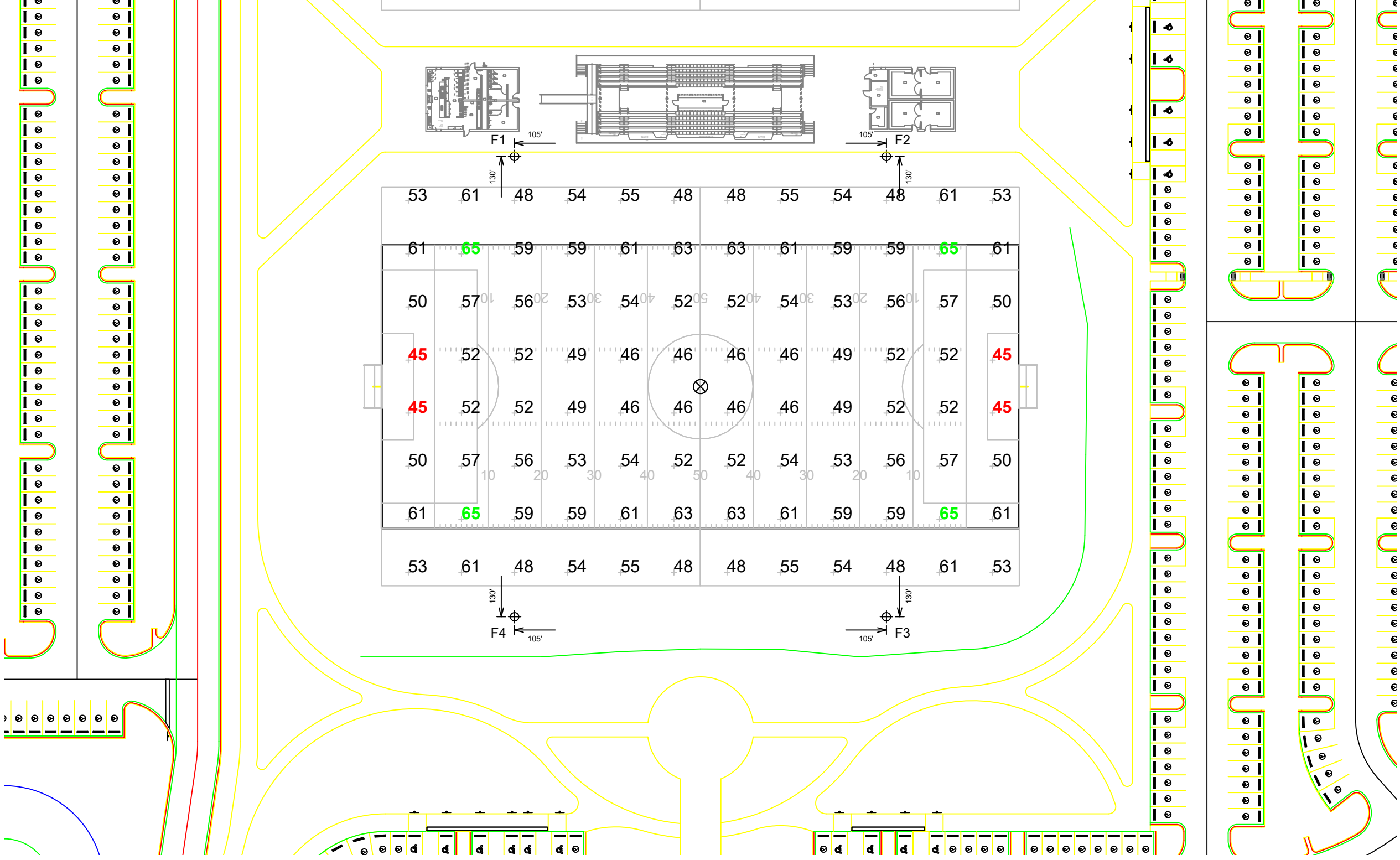

### Anchor Park Port Wentworth, GA

Grid Summary	
Name:	Soccer 1
Size:	360' x 225'
Spacing:	30.0' x 30.0'
Height:	3.0' above grade

Illumination Summary	
	ENTIRE GRID
Guaranteed Average:	50
Scan Average:	54.08
Maximum:	65.14
Minimum:	44.81
Avg/Min:	1.21
Guaranteed Max/Min:	2
Max/Min:	1.45
UG (adjacent pts):	1.31
CU:	0.75
No. of Points:	96
<b>FIXTURE INFORMATION</b>	
Applied Circuits:	A
No. of Fixtures:	40
Total Load:	48.38 kW

**Guaranteed Performance:** The ILLUMINATION described above is guaranteed per your Musco Warranty document.

**Field Measurements:** Individual field measurements may vary from computer-calculated predictions.

**Electrical System Requirements:** Refer to Amperage Draw Chart and/or the "Musco Control System Summary" for electrical sizing.

**Installation Requirements:** Results assume ± 3% nominal voltage at line side of the driver and structures located within 3 feet (1m) of design locations.

Pole location(s) ⊕ dimensions are relative to 0,0 reference point(s) ⊗



Equipment List For Areas Shown								
Structure				Fixtures				
QTY	STRUCTURE ID	SIZE	GRADE ELEVATION	ABOVE FIELD LEVEL	FIXTURE TYPE	QTY/POLE	THIS GRID	OTHER GRIDS
4	F1-F2 F7-F8	70'	-	70'	TLC-LED-1200	1/2*	2	1
				70'	TLC-LED-1500	7	0	7
				15.5'	TLC-BT-575	2	0	2
4	Totals					48	8	40

Above Field Level is height of fixtures above area shown  
 \*This structure utilizes a back-to-back mounting configuration

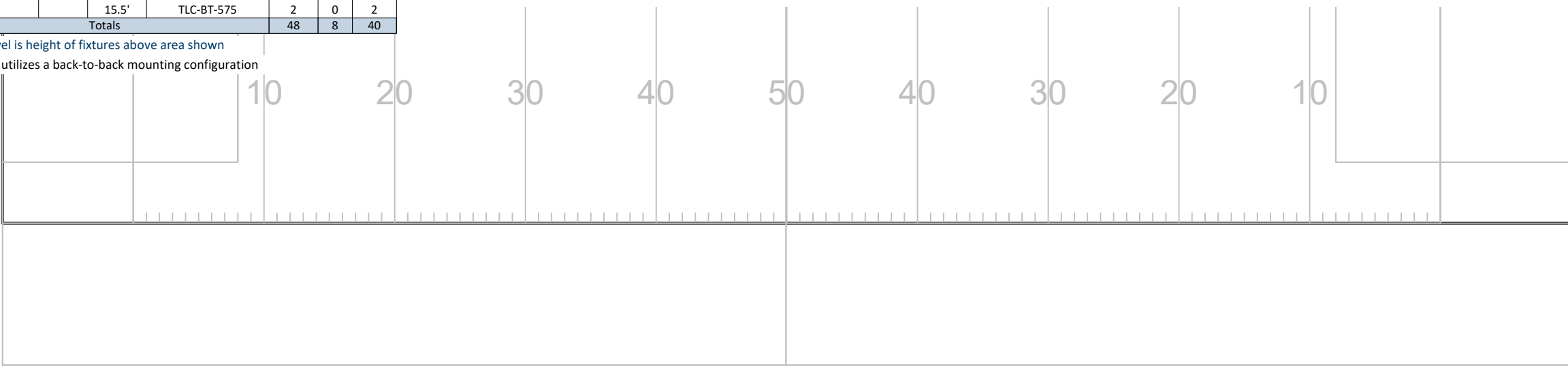

### Anchor Park Port Wentworth, GA

Grid Summary	
Name:	Bleachers/Concourse
Size:	360' x 160'
Spacing:	10.0' x 10.0'
Height:	3.0' above grade

Illumination Summary	
MAINTAINED HORIZONTAL FOOTCANDLES	
Scan Average:	28.35
Maximum:	43.71
Minimum:	14.54
Avg/Min:	1.95
Max/Min:	3.01
UG (adjacent pts):	1.27
CU:	0.39
No. of Points:	160
FIXTURE INFORMATION	
Applied Circuits:	D
No. of Fixtures:	8
Total Load:	9.32 kW

**Guaranteed Performance:** The ILLUMINATION described above is guaranteed per your Musco Warranty document.

**Field Measurements:** Individual field measurements may vary from computer-calculated predictions.

**Electrical System Requirements:** Refer to Amperage Draw Chart and/or the "Musco Control System Summary" for electrical sizing.

**Installation Requirements:** Results assume ± 3% nominal voltage at line side of the driver and structures located within 3 feet (1m) of design locations.

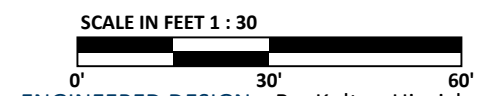
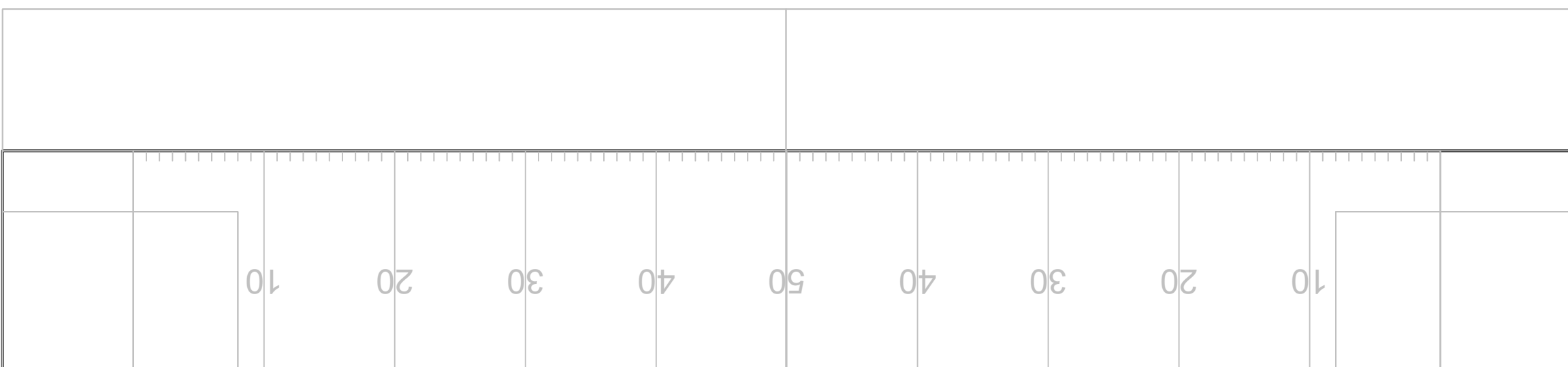
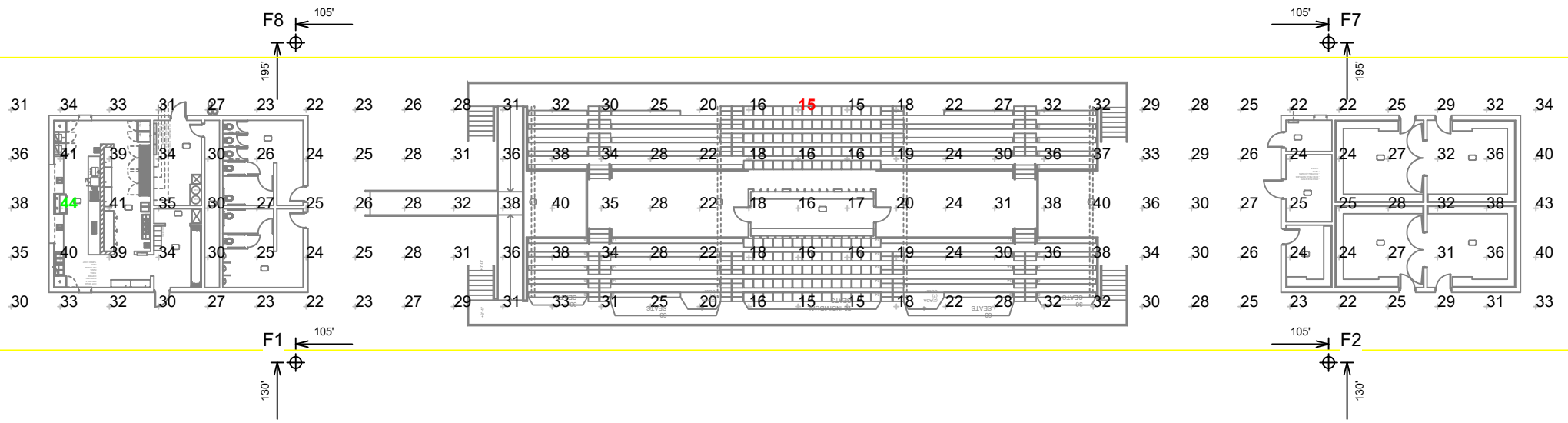

Pole location(s) ⊕ dimensions are relative to 0,0 reference point(s) ⊗



Equipment List For Areas Shown				Structure				Fixtures			
QTY	STRUCTURE ID	SIZE	GRADE ELEVATION	ABOVE FIELD LEVEL	FIXTURE TYPE	QTY/POLE	THIS GRID	OTHER GRIDS	QTY/POLE	THIS GRID	OTHER GRIDS
4	F5-F8	70'	-	70'	TLC-LED-1200	1/2*	1	2	7	7	0
				70'	TLC-LED-1500				2	2	0
				15.5'	TLC-BT-575						
4	Totals					48	40	8			

Above Field Level is height of fixtures above area shown  
 \*This structure utilizes a back-to-back mounting configuration

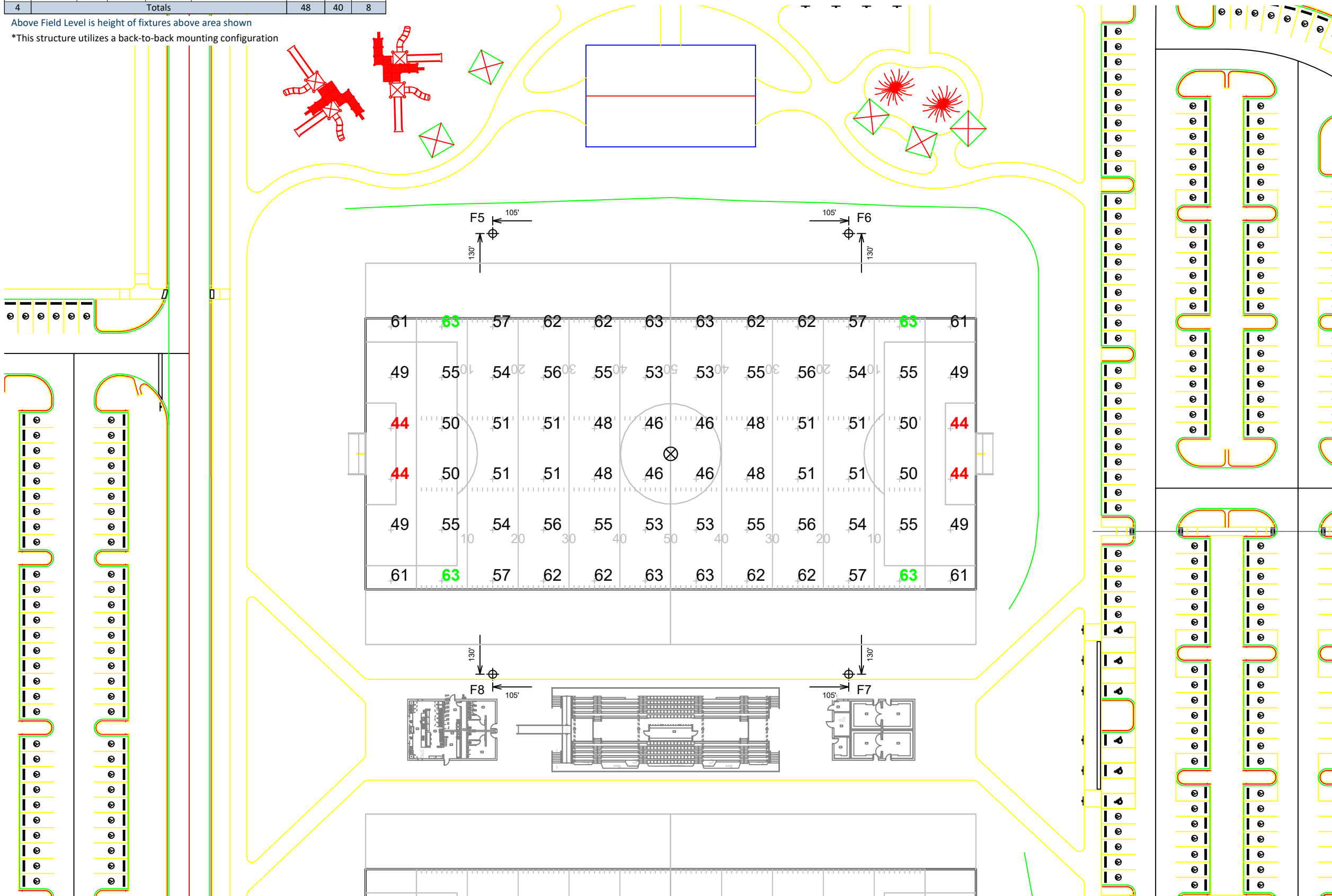

### Anchor Park Port Wentworth, GA

Grid Summary	
Name:	Football 2
Size:	360' x 160'
Spacing:	30.0' x 30.0'
Height:	3.0' above grade

Illumination Summary	
MAINTAINED HORIZONTAL FOOTCANDLES	
Guaranteed Average:	Entire Grid 50
Scan Average:	54.40
Maximum:	63.26
Minimum:	43.52
Avg/Min:	1.25
Guaranteed Max/Min:	2
Max/Min:	1.45
UG (adjacent pts):	1.24
CU:	0.57
No. of Points:	72
FIXTURE INFORMATION	
Applied Circuits:	B
No. of Fixtures:	40
Total Load:	48.38 kW

**Guaranteed Performance:** The ILLUMINATION described above is guaranteed per your Musco Warranty document.

**Field Measurements:** Individual field measurements may vary from computer-calculated predictions.

**Electrical System Requirements:** Refer to Amperage Draw Chart and/or the "Musco Control System Summary" for electrical sizing.

**Installation Requirements:** Results assume ± 3% nominal voltage at line side of the driver and structures located within 3 feet (1m) of design locations.

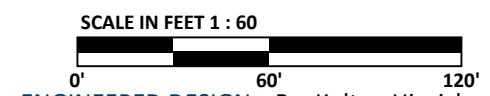

Pole location(s) ⊕ dimensions are relative to 0,0 reference point(s) ⊗



Structure				Fixtures				
QTY	STRUCTURE ID	SIZE	GRADE ELEVATION	ABOVE FIELD LEVEL	FIXTURE TYPE	QTY/POLE	THIS GRID	OTHER GRIDS
4	F5-F8	70'	-	70'	TLC-LED-1200	1/2*	1	2
				70'	TLC-LED-1500	7	7	0
				15.5'	TLC-BT-575	2	2	0
4	Totals					48	40	8

Above Field Level is height of fixtures above area shown  
 \*This structure utilizes a back-to-back mounting configuration

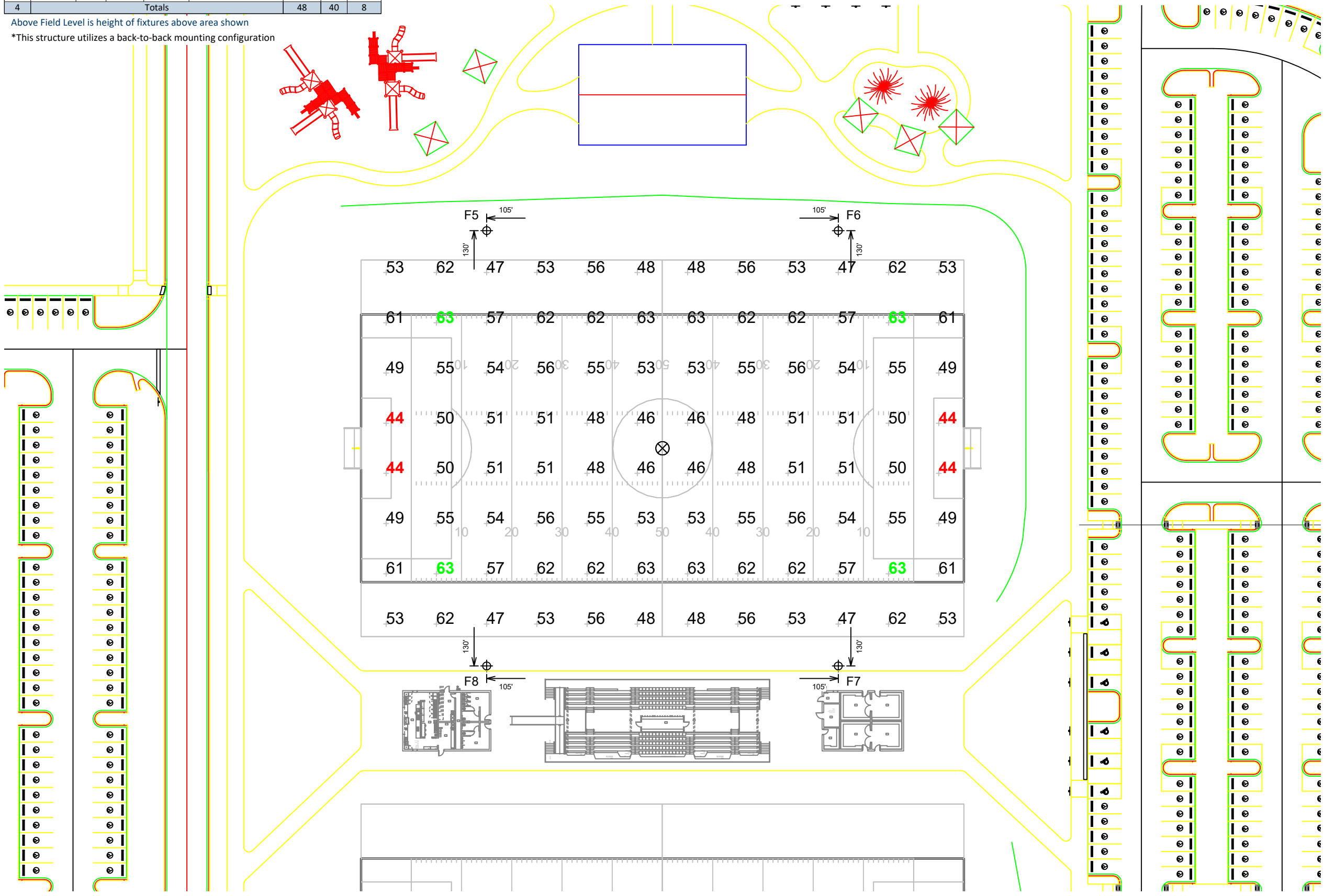

### Anchor Park

Port Wentworth, GA

Grid Summary	
Name:	Soccer 2
Size:	360' x 225'
Spacing:	30.0' x 30.0'
Height:	3.0' above grade

Illumination Summary	
MAINTAINED HORIZONTAL FOOTCANDLES	
Guaranteed Average:	Entire Grid: 50
Scan Average:	54.11
Maximum:	63.26
Minimum:	43.52
Avg/Min:	1.24
Guaranteed Max/Min:	2
Max/Min:	1.45
UG (adjacent pts):	1.31
CU:	0.75
No. of Points:	96
<b>FIXTURE INFORMATION</b>	
Applied Circuits:	B
No. of Fixtures:	40
Total Load:	48.38 kW

**Guaranteed Performance:** The ILLUMINATION described above is guaranteed per your Musco Warranty document.

**Field Measurements:** Individual field measurements may vary from computer-calculated predictions.

**Electrical System Requirements:** Refer to Amperage Draw Chart and/or the "Musco Control System Summary" for electrical sizing.

**Installation Requirements:** Results assume ± 3% nominal voltage at line side of the driver and structures located within 3 feet (1m) of design locations.

Pole location(s) ⊕ dimensions are relative to 0,0 reference point(s) ⊗



Equipment List For Areas Shown				Structure					Fixtures		
QTY	STRUCTURE ID	SIZE	GRADE ELEVATION	ABOVE FIELD LEVEL	FIXTURE TYPE	QTY/POLE	THIS GRID	OTHER GRIDS			
2	F5-F6	70'	-	70'	TLC-LED-1200	1/2*	2	1			
				70'	TLC-LED-1500	7	0	7			
				15.5'	TLC-BT-575	2	0	2			
2	Totals					24	4	20			

Above Field Level is height of fixtures above area shown  
 \*This structure utilizes a back-to-back mounting configuration

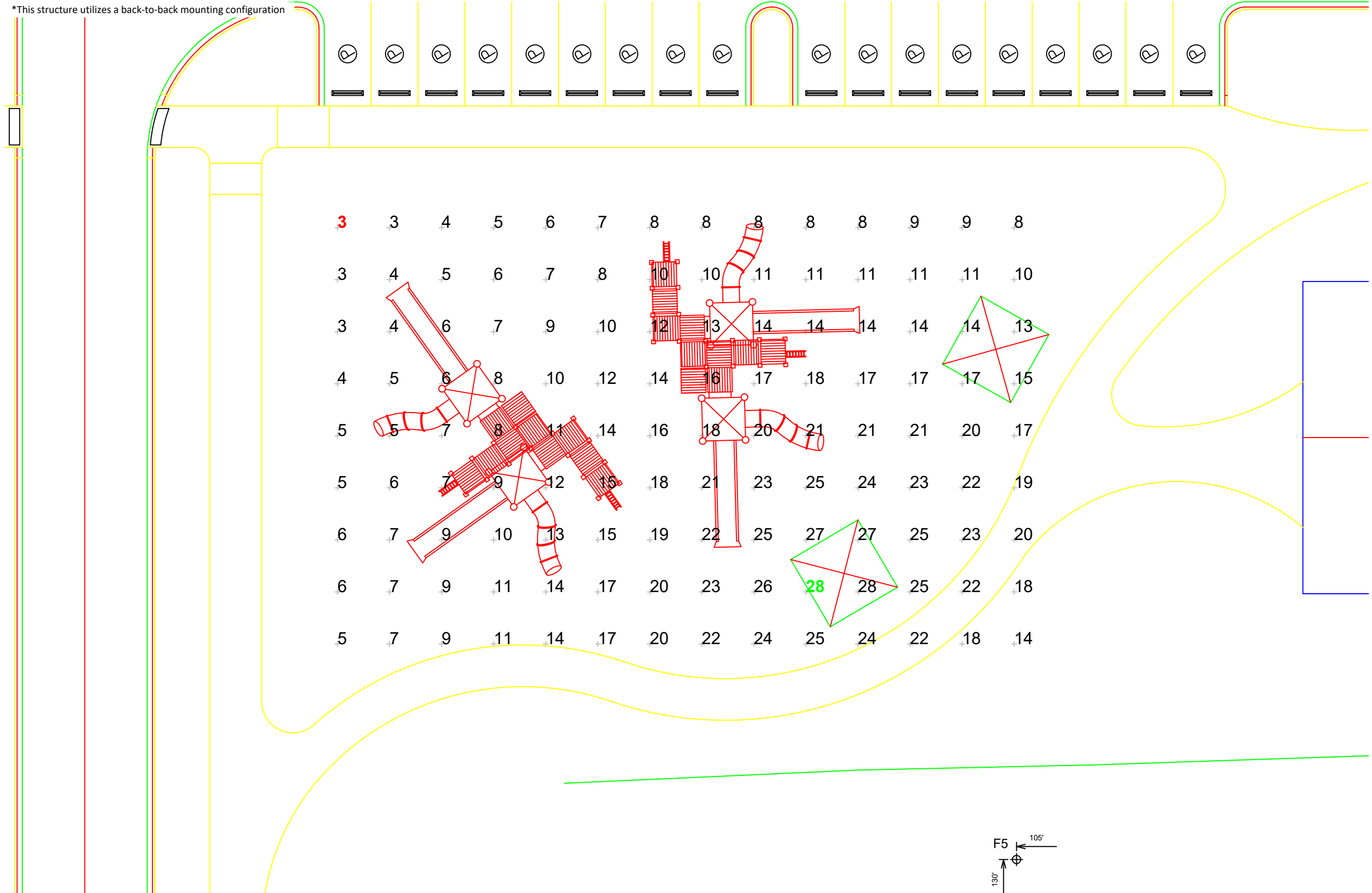

### Anchor Park

Port Wentworth, GA

Grid Summary	
Name:	Playground
Size:	360' x 160'
Spacing:	10.0' x 10.0'
Height:	3.0' above grade

Illumination Summary	
MAINTAINED HORIZONTAL FOOTCANDLES	
Entire Grid	
Scan Average:	13.54
Maximum:	28.17
Minimum:	2.60
Avg/Min:	5.20
Max/Min:	10.82
UG (adjacent pts):	1.33
CU:	0.27
No. of Points:	126
FITTURE INFORMATION	
Applied Circuits:	C
No. of Fixtures:	4
Total Load:	4.66 kW

**Guaranteed Performance:** The ILLUMINATION described above is guaranteed per your Musco Warranty document.

**Field Measurements:** Individual field measurements may vary from computer-calculated predictions.

**Electrical System Requirements:** Refer to Amperage Draw Chart and/or the "Musco Control System Summary" for electrical sizing.

**Installation Requirements:** Results assume ± 3% nominal voltage at line side of the driver and structures located within 3 feet (1m) of design locations.

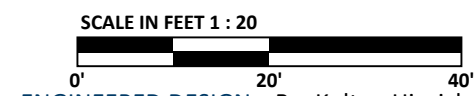

Pole location(s) ⊕ dimensions are relative to 0,0 reference point(s) ⊗

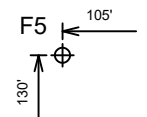

Equipment List For Areas Shown				Structure					Fixtures		
QTY	STRUCTURE ID	SIZE	GRADE ELEVATION	ABOVE FIELD LEVEL	FIXTURE TYPE	QTY/POLE	THIS GRID	OTHER GRIDS			
2	F5-F6	70'	-	70'	TLC-LED-1200	1/2*	2	1			
				70'	TLC-LED-1500	7	0	7			
				15.5'	TLC-BT-575	2	0	2			
2	Totals					24	4	20			

- Above Field Level is height of fixtures above area shown  
 \*This structure utilizes a back-to-back mounting configuration

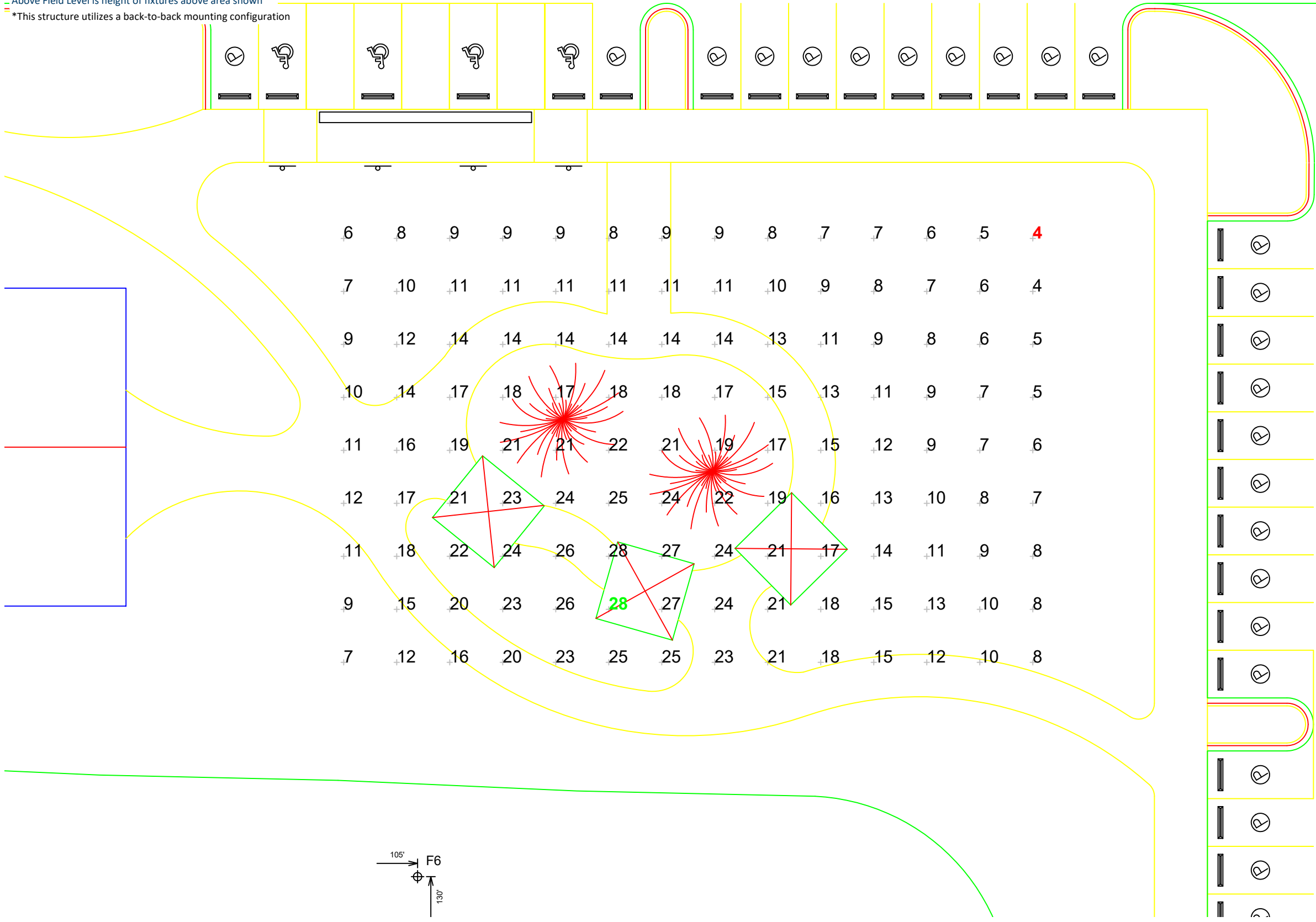

### Anchor Park

Port Wentworth, GA

Grid Summary	
Name:	Playground 2
Size:	360' x 160'
Spacing:	10.0' x 10.0'
Height:	3.0' above grade

Illumination Summary	
MAINTAINED HORIZONTAL FOOTCANDLES	
Scan Average:	14.20
Maximum:	28.20
Minimum:	3.78
Avg/Min:	3.76
Max/Min:	7.46
UG (adjacent pts):	1.66
CU:	0.29
No. of Points:	126
FIXTURE INFORMATION	
Applied Circuits:	C
No. of Fixtures:	4
Total Load:	4.66 kW

**Guaranteed Performance:** The ILLUMINATION described above is guaranteed per your Musco Warranty document.

**Field Measurements:** Individual field measurements may vary from computer-calculated predictions.

**Electrical System Requirements:** Refer to Amperage Draw Chart and/or the "Musco Control System Summary" for electrical sizing.

**Installation Requirements:** Results assume ± 3% nominal voltage at line side of the driver and structures located within 3 feet (1m) of design locations.



Pole location(s) ⊕ dimensions are relative to 0,0 reference point(s) ⊗

# Anchor Park

Port Wentworth, GA

## Equipment Layout

- INCLUDES:**
- Football 1
  - Football 2
  - Soccer 1
  - Soccer 2

**Electrical System Requirements:** Refer to Amperage Draw Chart and/or the "Musco Control System Summary" for electrical sizing.

**Installation Requirements:** Results assume ± 3% nominal voltage at line side of the driver and structures located within 3 feet (1m) of design locations.

## Equipment List For Areas Shown

QTY	Structure			Fixtures		QTY/POLE
	STRUCTURE ID	SIZE	GLOBAL ELEVATION	ABOVE GLOBAL LEVEL	FIXTURE TYPE	
6	F1-F2 F5-F8	70'	-	70'	TLC-LED-1200	1/2*
				15.5'	TLC-LED-1500 TLC-BT-575	7 2
2	F3-F4	70'	-	70'	TLC-LED-1200	1
				15.5'	TLC-LED-1500 TLC-BT-575	7 2
8	Totals					92

\*This structure utilizes a back-to-back mounting configuration  
Above Global Level is height of fixtures above design (0,0,0)

## Single Fixture Amperage Draw Chart

Driver Specifications (.90 min power factor)	Line Amperage Per Fixture (max draw)						
	208 (60)	220 (60)	240 (60)	277 (60)	347 (60)	380 (60)	480 (60)
Single Phase Voltage							
TLC-LED-1500	8.4	7.9	7.3	6.3	5.0	4.6	3.6
TLC-LED-1200	6.9	6.5	6.0	5.2	4.2	3.8	3.0
TLC-BT-575	3.3	3.2	2.9	2.5	2.0	1.8	1.5

\*Amp draw based on 100% fixture output, consult design specific datasheet for adjusted amperage draw chart

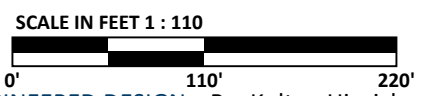
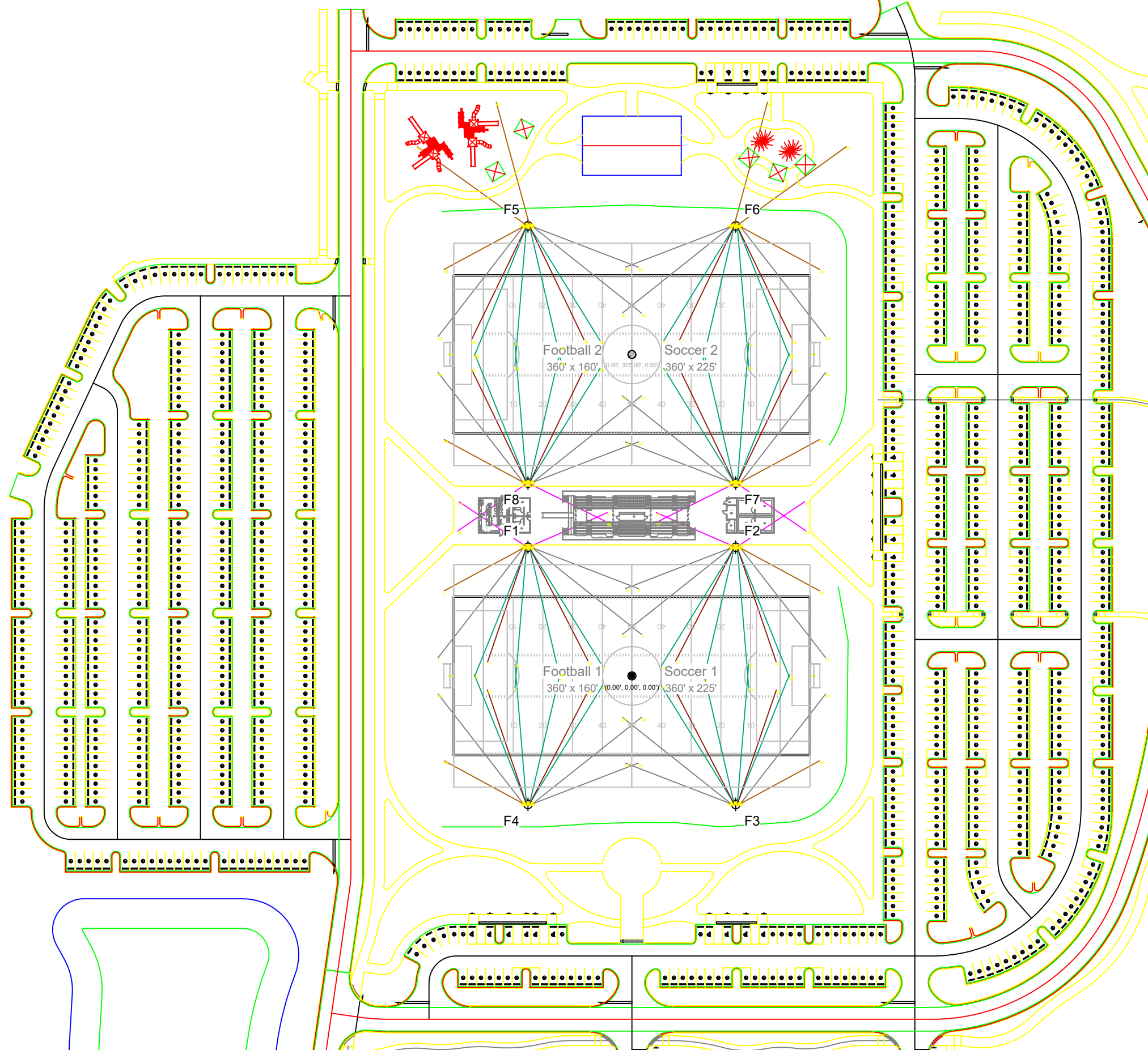

Pole location(s) ⊕ dimensions are relative to 0,0 reference point(s) ⊗



Equipment List For Areas Shown								
Structure				Fixtures				
QTY	STRUCTURE ID	SIZE	GRADE ELEVATION	ABOVE FIELD LEVEL	FIXTURE TYPE	QTY/POLE	THIS GRID	OTHER GRIDS
4	F1-F2 F7-F8	70'	-	70'	TLC-LED-1200	1/2*	3	0
				70'	TLC-LED-1500	7	7	0
				15.5'	TLC-BT-575	2	2	0
2	F3-F4	70'	-	70'	TLC-LED-1200	1	1	0
				70'	TLC-LED-1500	7	7	0
				15.5'	TLC-BT-575	2	2	0
2	F5-F6	70'	-	70'	TLC-LED-1200	1/2*	1	2
				70'	TLC-LED-1500	7	7	0
				15.5'	TLC-BT-575	2	2	0
8	Totals					92	88	4

Above Field Level is height of fixtures above area shown  
 \*This structure utilizes a back-to-back mounting configuration

### Anchor Park

Port Wentworth, GA

Grid Summary	
Name:	Project Spill @ 3.00ft.
Spacing:	30.0'
Height:	3.0' above grade

Illumination Summary	
INITIAL HORIZONTAL FOOTCANDLES	
Scan Average:	0.0475
Maximum:	0.1751
Minimum:	0.0024
CU:	0.00
No. of Points:	91
<b>FIXTURE INFORMATION</b>	
Applied Circuits:	A,B,D
No. of Fixtures:	88
Total Load:	106.07 kW

**Guaranteed Performance:** The ILLUMINATION described above is guaranteed per your Musco Warranty document.

**Field Measurements:** Individual field measurements may vary from computer-calculated predictions.

**Electrical System Requirements:** Refer to Amperage Draw Chart and/or the "Musco Control System Summary" for electrical sizing.

**Installation Requirements:** Results assume ± 3% nominal voltage at line side of the driver and structures located within 3 feet (1m) of design locations.

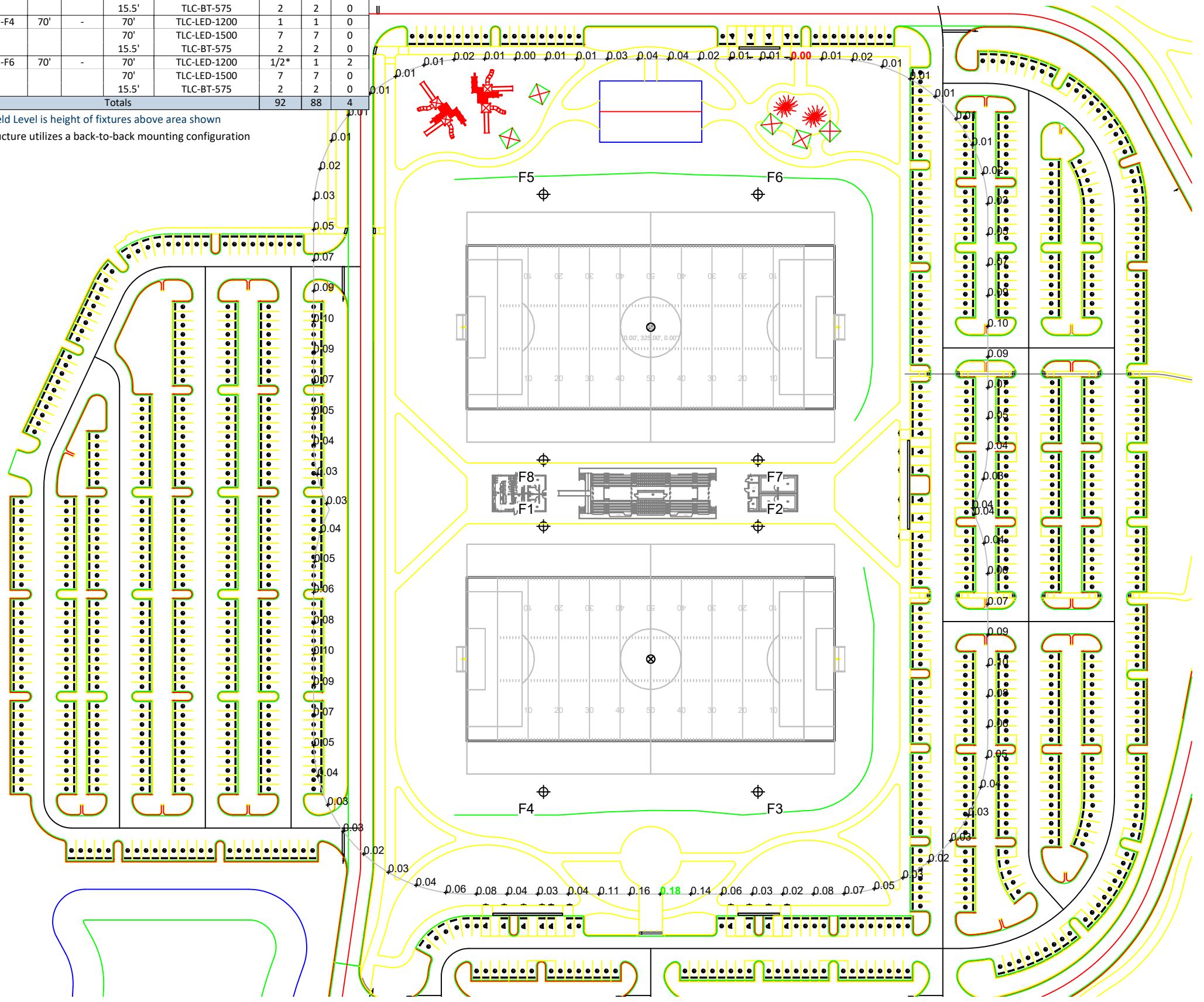

SCALE IN FEET 1 : 110

ENGINEERED DESIGN By: Kolten Hinrichsen • File #246162A • 20-Jun-25

Pole location(s) ⊕ dimensions are relative to 0,0 reference point(s) ⊗



Equipment List For Areas Shown								
Structure				Fixtures				
QTY	STRUCTURE ID	SIZE	GRADE ELEVATION	ABOVE FIELD LEVEL	FIXTURE TYPE	QTY/POLE	THIS GRID	OTHER GRIDS
4	F1-F2 F7-F8	70'	-	70'	TLC-LED-1200	1/2*	3	0
				70'	TLC-LED-1500	7	7	0
				15.5'	TLC-BT-575	2	2	0
2	F3-F4	70'	-	70'	TLC-LED-1200	1	1	0
				70'	TLC-LED-1500	7	7	0
				15.5'	TLC-BT-575	2	2	0
2	F5-F6	70'	-	70'	TLC-LED-1200	1/2*	1	2
				70'	TLC-LED-1500	7	7	0
				15.5'	TLC-BT-575	2	2	0
8	Totals					92	88	4

Above Field Level is height of fixtures above area shown  
 \*This structure utilizes a back-to-back mounting configuration

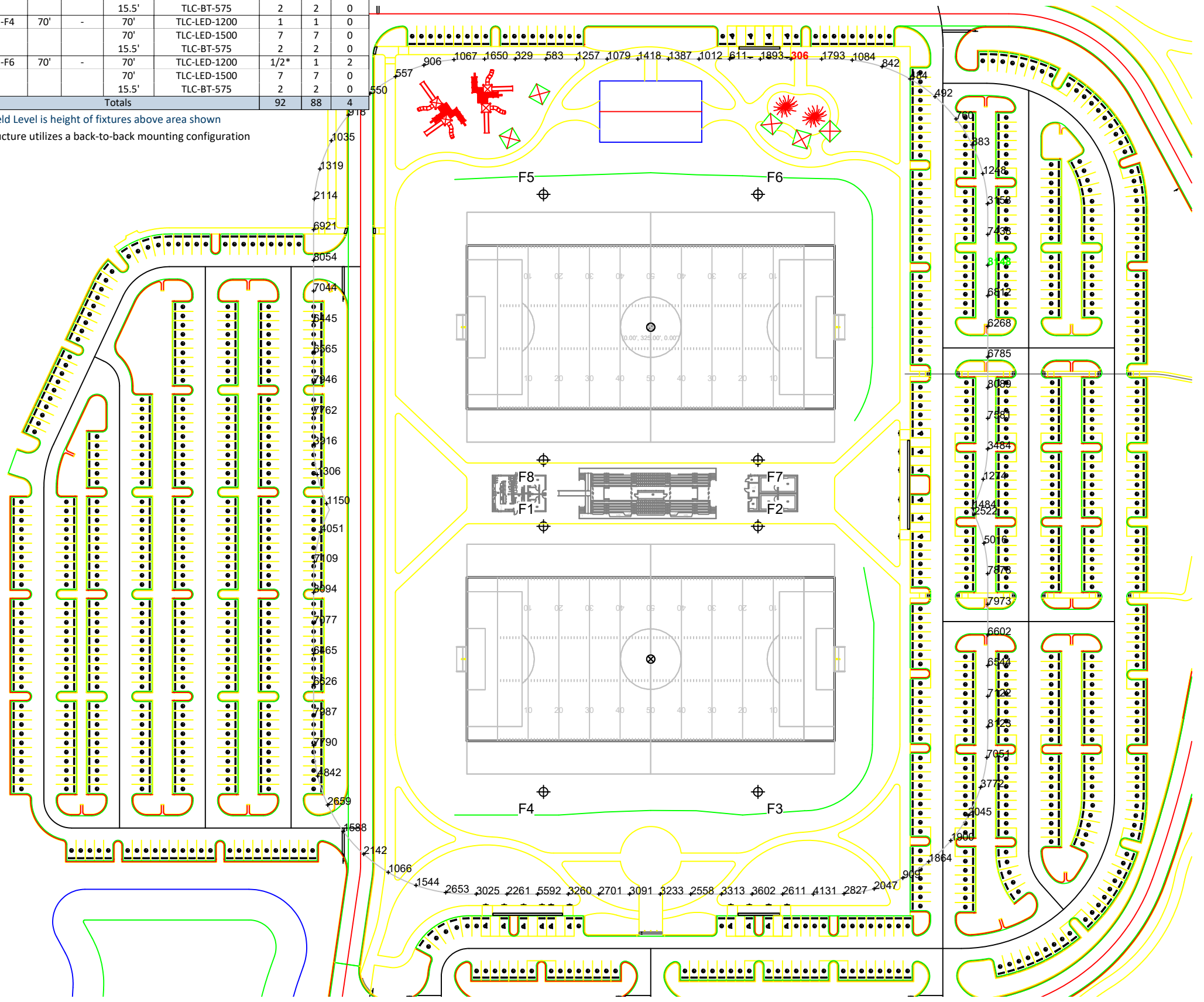

### Anchor Park

Port Wentworth, GA

Grid Summary	
Name:	Project Spill @ 5.00ft.
Spacing:	30.0'
Height:	5.0' above grade

Illumination Summary	
	INITIAL CANDELA (PER FIXTURE)
Scan Average:	Entire Grid: <b>3631.5952</b>
Maximum:	8148.0610
Minimum:	305.7612
CU:	0.00
No. of Points:	91
<b>FIXTURE INFORMATION</b>	
Applied Circuits:	A,B,D
No. of Fixtures:	<b>88</b>
Total Load:	106.07 kW

**Guaranteed Performance:** The ILLUMINATION described above is guaranteed per your Musco Warranty document.

**Field Measurements:** Individual field measurements may vary from computer-calculated predictions.

**Electrical System Requirements:** Refer to Amperage Draw Chart and/or the "Musco Control System Summary" for electrical sizing.

**Installation Requirements:** Results assume ± 3% nominal voltage at line side of the driver and structures located within 3 feet (1m) of design locations.

SCALE IN FEET 1 : 110

ENGINEERED DESIGN By: Kolten Hinrichsen • File #246162A • 20-Jun-25

Pole location(s) ⊕ dimensions are relative to 0,0 reference point(s) ⊗



Equipment List For Areas Shown								
Structure				Fixtures				
QTY	STRUCTURE ID	SIZE	GRADE ELEVATION	ABOVE FIELD LEVEL	FIXTURE TYPE	QTY/POLE	THIS GRID	OTHER GRIDS
4	F1-F2 F7-F8	70'	-	70'	TLC-LED-1200	1/2*	3	0
				70'	TLC-LED-1500	7	7	0
				15.5'	TLC-BT-575	2	2	0
2	F3-F4	70'	-	70'	TLC-LED-1200	1	1	0
				70'	TLC-LED-1500	7	7	0
				15.5'	TLC-BT-575	2	2	0
2	F5-F6	70'	-	70'	TLC-LED-1200	1/2*	1	2
				70'	TLC-LED-1500	7	7	0
				15.5'	TLC-BT-575	2	2	0
8	Totals					92	88	4

Above Field Level is height of fixtures above area shown  
 \*This structure utilizes a back-to-back mounting configuration

### Anchor Park Port Wentworth, GA

Grid Summary	
Name:	Project Spill @ 5.00ft.
Spacing:	30.0'
Height:	5.0' above grade

Illumination Summary	
INITIAL MAX VERTICAL FOOTCANDLES	
Scan Average:	0.1103
Maximum:	0.2801
Minimum:	0.0045
CU:	0.00
No. of Points:	91
<b>FIXTURE INFORMATION</b>	
Applied Circuits:	A,B,D
No. of Fixtures:	88
Total Load:	106.07 kW

**Guaranteed Performance:** The ILLUMINATION described above is guaranteed per your Musco Warranty document.

**Field Measurements:** Individual field measurements may vary from computer-calculated predictions.

**Electrical System Requirements:** Refer to Amperage Draw Chart and/or the "Musco Control System Summary" for electrical sizing.

**Installation Requirements:** Results assume ± 3% nominal voltage at line side of the driver and structures located within 3 feet (1m) of design locations.

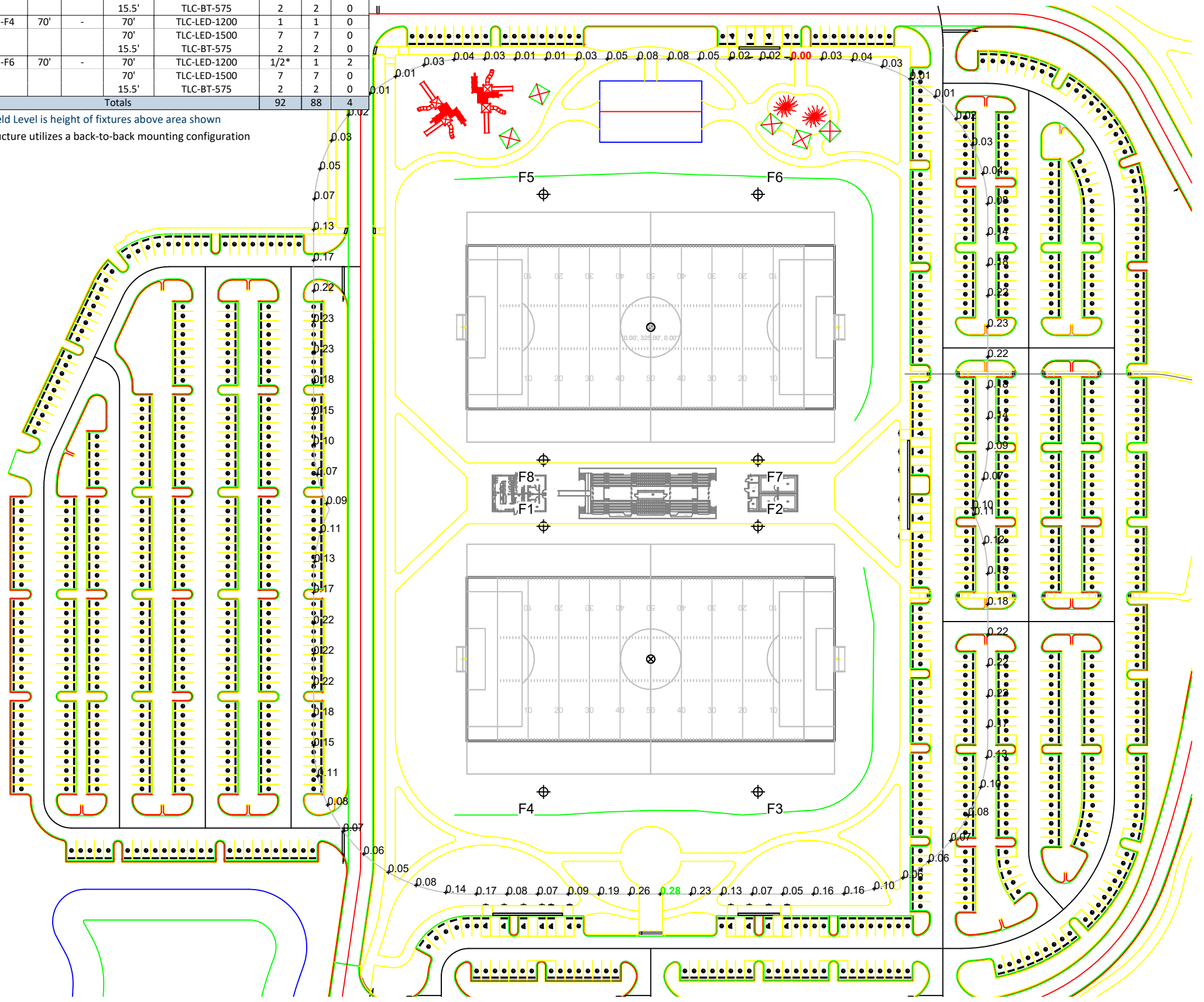

Pole location(s) ⊕ dimensions are relative to 0,0 reference point(s) ⊗



# Anchor Park

Port Wentworth, GA

## Equipment Layout

- INCLUDES:**
- Football 1
  - Football 2
  - Soccer 1
  - Soccer 2

**Electrical System Requirements:** Refer to Amperage Draw Chart and/or the "Musco Control System Summary" for electrical sizing.

**Installation Requirements:** Results assume ± 3% nominal voltage at line side of the driver and structures located within 3 feet (1m) of design locations.

## Equipment List For Areas Shown

QTY	Structure			Fixtures		QTY/POLE
	STRUCTURE ID	SIZE	GLOBAL ELEVATION	ABOVE GLOBAL LEVEL	FIXTURE TYPE	
6	F1-F2 F5-F8	70'	-	70'	TLC-LED-1200	1/2*
				15.5'	TLC-LED-1500 TLC-BT-575	7 2
2	F3-F4	70'	-	70'	TLC-LED-1200	1
				15.5'	TLC-LED-1500 TLC-BT-575	7 2
8	Totals					92

\*This structure utilizes a back-to-back mounting configuration  
Above Global Level is height of fixtures above design (0,0,0)

## Single Fixture Amperage Draw Chart

Driver Specifications (.90 min power factor)	Line Amperage Per Fixture (max draw)						
	208 (60)	220 (60)	240 (60)	277 (60)	347 (60)	380 (60)	480 (60)
Single Phase Voltage							
TLC-LED-1500	8.4	7.9	7.3	6.3	5.0	4.6	3.6
TLC-LED-1200	6.9	6.5	6.0	5.2	4.2	3.8	3.0
TLC-BT-575	3.3	3.2	2.9	2.5	2.0	1.8	1.5

\*Amp draw based on 100% fixture output, consult design specific datasheet for adjusted amperage draw chart

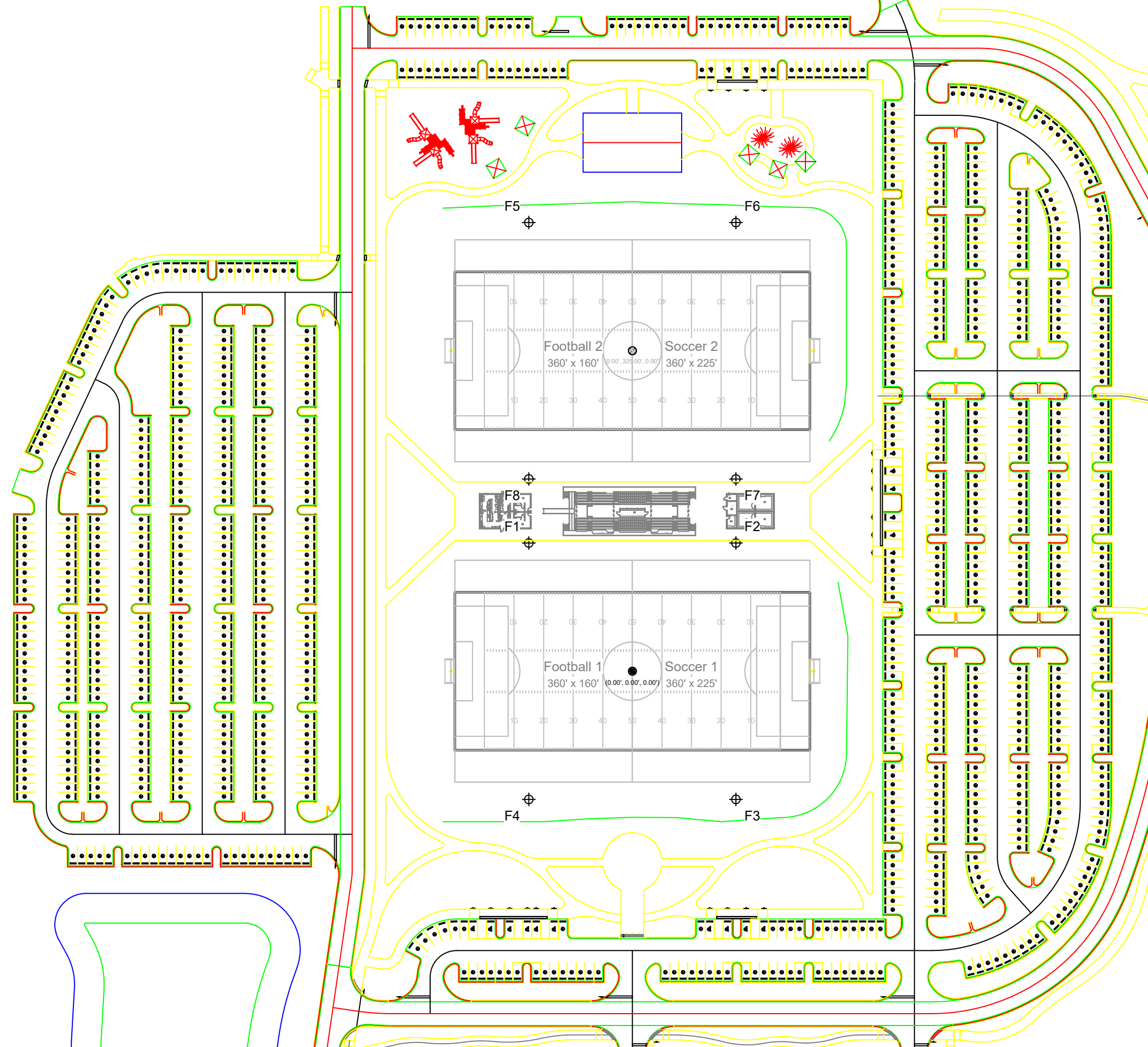

Pole location(s) ⊕ dimensions are relative to 0,0 reference point(s) ⊗

