



CITY OF PORT WENTWORTH
CITY COUNCIL
AUGUST 21, 2025

Council Meeting Room

Regular Session

7:00 PM

7224 GA HIGHWAY 21
PORT WENTWORTH, GA 31407

- 1. CALL MEETING TO ORDER**
- 2. PRAYER AND PLEDGE OF ALLEGIANCE**
- 3. ROLL CALL - CLERK OF COUNCIL**
- 4. APPROVAL OF AGENDA**
- 5. RECOGNITION OF SPECIAL GUESTS**
- 6. PUBLIC COMMENTS - REGISTERED SPEAKERS**
- 7. ELECTIONS & APPOINTMENTS**
- 8. ADOPTION OF MINUTES**
 - A. Regular Council Meeting Minutes - July 29, 2025**
- 9. COMMUNICATIONS & PETITIONS**
 - A. FBILEEDA Award**
 - B. Recognition of Officer of the Quarter**
 - C. City Manager Update**
 - D. Black Business Month Proclamation**
 - E. National Wellness Month Proclamation**
- 10. COMMITTEE REPORTS**
- 11. CONSENT AGENDA**
 - A. Annual Renewal of Emergency Debris Removal and Management Services**
 - B. Annual Renewal of Disaster Debris Monitoring and Related Services**
- 12. UNFINISHED BUSINESS**
 - A. Consideration of the Second Reading for a Zoning Map Amendment Application submitted by Phillip McCorkle as Agent for SPH 21, LLC, requesting to rezone 23.02 acres from R-1 to R-4, to allow the expansion of a residential townhome development. PIN # 700976 02038, located in the 1st Council District, off Highway 30.**

13. NEW BUSINESS

- A. Phillip McCorkle, as Agent for SPH 21, LLC, requests the approval of a Concept Site Plan "Arbor View PH 2". PIN# 70976 02038 located off Highway 30 in the 1st Council District. Zoned R-1, proposed zoning R-4.
- B. Engineering Services for the expansion of the Wastewater Treatment Plant
- C. Right of Way Maintenance
- D. Update to the FY 2026 Fee Schedule- 1st Reading
 - Public Hearing

14. RESOLUTIONS/ORDINANCES/PROCLAMATIONS

- A. Resolution Establishing a Port Wentworth Youth Council

15. EXECUTIVE SESSION

- A. Litigation**
- B. Personnel**
- C. Real Estate**

16. ADJOURNMENT



City Council
7224 GA Highway 21
Port Wentworth, GA 31407

Meeting: 08/21/25
Department: Administration
Category: Agreement
Prepared By: Zahnay Smoak
Department Head:

SCHEDULED

AGENDA ITEM (ID)

DOC ID:

Annual Renewal of Emergency Debris Removal and Management Services

Issue/Item: Annual renewal of the City’s contract for emergency debris removal and management services.

Background: Effective and timely debris removal is critical to maintaining public safety, ensuring continuity of essential services, and supporting community recovery after severe weather events, natural disasters, or other emergencies. The City maintains a standing agreement with a qualified contractor to provide emergency debris clearance, collection, reduction, and disposal in accordance with federal, state, and local requirements. This arrangement ensures that, in the event of a declared emergency, the contractor can mobilize quickly without delay caused by procurement procedures.

Facts and Finding:

The current contract for emergency debris removal and management is set to expire in September. Annual renewal is necessary to maintain uninterrupted readiness and compliance with FEMA reimbursement guidelines. The contractor’s performance over the past year has been satisfactory, meeting all required response times, safety standards, and reporting obligations. Renewing the contract will preserve the City’s ability to:

- Rapidly deploy debris removal resources following a disaster.
- Coordinate with local, state, and federal agencies for recovery operations.
- Ensure eligibility for potential FEMA cost recovery under the Public Assistance Program.

City staff recommend continuing with the current contractor based on demonstrated capability, cost-effectiveness, and familiarity with the City’s emergency response plans.

Funding: Costs are only incurred upon activation during an emergency event. Funding is provided through the City’s Emergency Management budget, with potential reimbursement from FEMA or other applicable sources following a declared disaster.

Recommendation: Approval of the annual renewal of the emergency debris removal and management services contract, to ensure continuous preparedness and compliance with disaster response and recovery standards.



ADMINISTRATIVE OFFICE
5629 Commerce Blvd East
Mobile, AL 36619

OFFICE : 800-992-6207
FAX : 251-459-7433

August 18, 2025

Chief Lance Moore
City of Port Wentworth
317 Cantyre Street
Port Wentworth, GA 31407

via email: lmoore@portwentworthga.gov

Re: Contract Renewal for Disaster Recovery Assistance Following a Natural or Manmade Disaster

Dear Chief Moore:

CrowderGulf has been providing the City of Port Wentworth, Disaster Recovery Assistance Following a Natural or Manmade Disaster per the contract that commenced on May 06, 2022. The term of this Agreement shall be for a period of three (3) years with the option to renew for two (2) additional years. At the direction of the City, CrowderGulf agrees to renew this contract for one (1) year increments.

According to the U.S. Department of Labor, Bureau of Labor Statistics Consumer Price Index, over the last twelve (12) months, the all items index increased 2.9 percent. At this time CrowderGulf is requesting a price increase of 2.9 percent.

If the City of Port Wentworth is in agreement to renew the contract, please sign the renewal acceptance below and return to CrowderGulf. Upon execution of this acknowledgement the contract will continue with the updated pricing sheet (attached) until its new expiration date of May 05, 2026.

We appreciate the opportunity to renew this contract and stand ready to respond immediately in the event the community of the City of Port Wentworth requests our services. If you have any questions or if we can be of any further assistance, please do not hesitate to contact me at the Disaster Administration Office (DAO) at 800-992-6207 or by e-mail at jramsay@crowderygulf.com.

Best regards,

Ashley Ramsay-Naile
President

RENEWAL ACCEPTANCE - City of Port Wentworth, GA

Signature

Name/Title

Date

ATTACHMENT I - FEE SCHEDULE

City of Port Wentworth, GA
CrowderGulf CPI Pricing (2.9%)

DEBRIS REMOVAL, PROCESSING AND DISPOSAL

ITEM	DESCRIPTION OF SERVICE	COST	UNIT
1	Mobilization and Demobilization	NA	NA
2	Vegetative and C&D Debris Removal from Public Property (Right-of-Way) and Hauling to Debris Management Sites (DMS/TDSRS) or other disposal sites Note 1 and 6	\$8.13	CY
3	Vegetative and C&D Debris Removal from Private Property (Right-of-Entry Program) and Publicly Owner Property (other than Right-of-Way) and hauled to DMS/TDSRS or other disposal sites Note 1 and 6	\$10.24	CY
4	Vegetative and C&D Debris Removal from Public Property (Right-of-Way) and Hauling Directly to Final Disposal Site Note 1 and 6	\$9.16	CY
5	Vegetative and C&D Debris Removal from Debris Management Sites (DMS/TDSRS) and Hauling to Final Disposal Site Note 2 and 7	\$4.63	CY
6	Management of DMS/TDSRS Note 6	\$1.13	CY
7	Processing (Grinding/Chipping) of Vegetative Debris at DMS/TDSRS or Final Disposal Note 6	\$3.29	CY
8	Grinding or consolidation of C&D debris at DMS/TSDSRS or compaction Note 6	\$3.09	CY
9	Processing (Open Burning) of Vegetative Debris at DMS/TDSRS or Final Disposal Note 6	\$2.47	CY
10	Processing Burning of Vegetative debris using air curtain incinerators at DMS/TDSRS or final disposal Note 6	\$2.93	CY
11	Pick Up and Haul of White Goods	\$41.16	UNIT
12	Pick Up and Disposal of Hazardous Material	\$7.20	LB
15	Freon Management and Recycling	\$36.02	UNIT
16	Dead Animal Collection, Transportation and Disposal	\$1.03	LB
Removal of hazardous stumps resulting from trees growing on the right of way and Hauling to Final Disposal Site			
17	24 inch diameter to 47.99 inch diameter	\$360.15	STUMP
18	48 inch diameter and greater	\$463.05	STUMP
Debris from leaners and hangers will be piled on right of ways and will be hauled and disposed of under items 2 – 9			
19	Removal of hazardous hanging limbs greater than 2 inches	\$82.32	PER TREE
20	Removal of hazardous standing trees 6" – 12" in diameter	\$51.45	EACH
21	Removal of hazardous standing trees 13" – 24" in diameter	\$154.35	EACH
22	Removal of hazardous standing trees 25" – 36" in diameter	\$257.25	EACH
23	Removal of hazardous standing trees 37" – 48" in diameter	\$349.86	EACH
24	Removal of hazardous standing trees greater than 48" in diameter	\$406.46	EACH

Marine Debris Removal			
25	Canals, bayous and ditches	\$43.22	PER LF
26	Bays and other open waters	\$668.85	PER ACRE
27	Boat removal	\$66.89	PER LF
The following items shall be billed on a time and material basis according to the attached schedules:			
28	Emergency Road Clearance	See Equipment & Labor Rates	

NOTES:

1. This price assumes that DMS/ TDSRS's, final disposal site or other approved disposal sites are within 10 miles. For all distances, over 10 miles add **\$0.21** per cubic yard per mile.
2. This price assumes final disposal is within 30 miles of DMS/TDSRS. For all distances, over 30 miles add **\$0.21** per cubic yard per mile.
3. The Contractor will pay tipping fee at final disposal site(s) and back charge City at cost.
4. Includes management of site remediation.
5. All stumps placed on the right of way by citizens will be converted to cubic yards per the FEMA Stump Conversion Chart and charged as regular debris under items.
6. Invoices to be based on incoming load tickets.
7. Invoices to be based on outgoing load tickets.
8. For a multi-year contract, the above prices would be adjusted up or down on the anniversary date of the contract according a percentage equal to the percent change in the Consumer Price Index as published by the U. S. Department of Labor, Bureau of Labor Statistics.

ATTACHMENT II - FEE SCHEDULE

The proposed fees shall include all labor, material and equipment to deliver and provide the equipment and services as outlined in the RFP and should include any travel or per diem expenses and any other miscellaneous expense involved. The fee for providing the required equipment and services are:

SCHEDULE 1 – HOURLY EQUIPMENT

Equipment Type	Hourly Equipment Rate
Bobcat Loader	\$128.63
Bucket Truck w/Operator	\$190.37
Crash Truck w/Impact Attenuator	\$102.90
Dozer, Tracked, D5 or similar	\$144.06
Dozer, Tracked, D6 or similar	\$164.64
Dozer, Tracked, D7 or similar	\$185.22
Dozer, Tracked, D8 or similar	\$205.80
Dump Truck, 18 CY-20 CY	\$97.76
Dump Truck, 21 CY-30 CY	\$108.05
Generator and Lighting	\$41.16
Grader w/12' Blade	\$123.48
Hydraulic Excavator, 1.5 CY	\$149.21
Hydraulic Excavator, 2.5 CY	\$169.79
Knuckleboom Loader	\$216.09
Lowboy Trailer w/Tractor	\$149.21
Mobile Crane (Adequate for hanging limbs/leaning trees) 25 Ton	\$180.08
Pickup Truck, .5 Ton	\$20.58
Truck, Flatbed	\$41.16
Water Truck	\$77.18
Wheel Loader, 2.5 CY, 950 or similar	\$154.35
Wheel Loader, 3.5 – 4.0 CY, 966 or similar	\$169.79
Wheel Loader, 4.5 CY, 980, or similar	\$185.22
Wheel Loader-Backhoe, 1.0-1.5 CY	\$144.06

Other – Please list	
Labor Category	Hourly Labor Rate
Operations Manager w/Cell Phone and Pickup	\$87.47
Crew Foreman w/Cell Phone and Pickup	\$77.18
Tree Climber w/Chainsaw	\$128.63
Laborer w/Chainsaw	\$49.39
Laborer w/small tools, traffic control, or flag-person	\$43.22
Materials	
Fill dirt for Stump Holes and Ruts – Delivered, Placed & Graded	\$20.58



City Council
7224 GA Highway 21
Port Wentworth, GA 31407

Meeting: 08/21/25
Department: Administration
Category: Agreement
Prepared By: Zahnay Smoak
Department Head:

SCHEDULED

AGENDA ITEM (ID)

DOC ID:

Annual Renewal of Disaster Debris Monitoring and Related Services

Issue/Item: Annual renewal of the City’s contract for emergency debris monitoring and management services.

Background: Background: Effective and timely debris removal is critical to maintaining public safety, ensuring continuity of essential services, and supporting community recovery after severe weather events, natural disasters, or other emergencies. Tetra Tech is responsible for overseeing all the debris removal that is conducted by the removal company. This is done to ensure compliance for FEMA reimbursement, that the City is charged accurately charged for collected debris, and that all safety standards are met. The City maintains a standing agreement with a qualified contractor to provide emergency debris monitoring and services in accordance with federal, state, and local requirements. This arrangement ensures that, in the event of a declared emergency, the contractor can mobilize quickly without delay caused by procurement procedures.

Facts and Finding:

The current contract for emergency debris monitoring and related services is set to expire in September. Annual renewal is necessary to maintain uninterrupted readiness and compliance with FEMA reimbursement guidelines. The contractor’s performance over the past year has been satisfactory, meeting all required response times, safety standards, and reporting obligations. Renewing the contract will preserve the City’s ability to:

- Rapidly deploy debris removal resources following a disaster.
- Coordinate with local, state, and federal agencies for recovery operations.
- Ensure eligibility for potential FEMA cost recovery under the Public Assistance Program.

City staff recommend continuing with the current contractor based on demonstrated capability, cost-effectiveness, and familiarity with the City’s emergency response plans.

Funding: Costs are only incurred upon activation during an emergency event. Funding is provided through the City’s Emergency Management budget, with potential reimbursement from FEMA or other applicable sources following a declared disaster.

Recommendation: Approval of the annual renewal of the emergency debris monitoring and related services contract, effective September 8, 2025, to ensure continuous preparedness and compliance with disaster response and recovery standards.

CITY OF PORT WENTWORTH, GEORGIA
Disaster Debris Monitoring Services
Contract No. 05-2017

FOURTH CONTRACT RENEWAL

THIS **FOURTH CONTRACT RENEWAL** is by and between the **CITY OF PORT WENTWORTH, GEORGIA** (hereinafter referred to as "CLIENT"), and **TETRA TECH, INC.** (hereinafter referred to as "CONTRACTOR").

WITNESSETH:

WHEREAS, CLIENT has entered into a Contract for Disaster Debris Monitoring Services with CONTRACTOR for a period beginning on September 8, 2017 through September 7, 2022 with the option to renew the contract term annually by mutual written agreement of the parties;

WHEREAS, the CLIENT and CONTRACTOR have previously exercised the first renewal option for one (1) additional year from September 8, 2022, through September 7, 2023, a second renewal option for one (1) additional year from September 8, 2023, through September 7, 2024, and a third renewal option for one (1) additional year from September 8, 2024 through September 7, 2025; and

WHEREAS, the CLIENT and CONTRACTOR would like to exercise the fourth renewal option for one (1) additional year; and

NOW, THEREFORE, the parties hereby agree as follows:

1. **CONTRACT TERM.** The Contract is renewed from September 8, 2025 through September 7, 2026. All other terms and conditions remain unchanged.
2. **MODIFICATIONS.** This Contract Renewal, any prior contract renewals, and the Contract, taken together, constitute the final agreement between the CLIENT and CONTRACTOR. Any modification of or additions to the terms of this Contract Renewal or Contract must be in writing and executed by the parties.

IN WITNESS WHEREOF, the parties have duly executed this Fourth Contract Renewal by the authorized representatives below.

CITY OF PORT WENTWORTH, GEORGIA

TETRA TECH, INC.

By:
Title:

By: Jonathan Burgiel
Title: Business Unit President

ATTEST:

ATTEST:

Kayla Lemaire, Contract Administrator II



City Council
7224 GA Highway 21
Port Wentworth, GA 31407

Meeting: 08/21/25
Department: Development Services
Category: Ordinance
Prepared By: Katie Dunnigan
Department Head: Katie Dunnigan

SCHEDULED

AGENDA ITEM (ID)

DOC ID:

Consideration of the Second Reading for a Zoning Map Amendment Application submitted by Phillip McCorkle as Agent for SPH 21, LLC, requesting to rezone 23.02 acres from R-1 to R-4, to allow the expansion of a residential townhome development. PIN # 700976 02038, located in the 1st Council District, off Highway 30.

Issue/Item: A Zoning Map Amendment Application has been submitted by Phillip McCorkle as Agent for SPH 21, LLC requesting to rezone 23.02 acres from R-1 to R-4, to allow the expansion of a residential townhome development. PIN # 700976 02038, located in the 1st Council District, off Highway 30.

Background:

- The applicant requests R-4 zoning for the proposed expansion of a residential townhome development.
- The development would be a new phase to the existing Arbor View community and proposes 63 townhomes.
- Adjacent property to the north is zoned I-1, properties to the east and west are zoned R-1, the adjacent parcels to the south are zoned R-4 and R-5.
- Approval of this rezoning would cause a shift of total land use acreage by approximately .24% from the R-1 to the R-4 zoning district.

Facts and Finding:

- The site proposes access through the existing Arbor View development, this parcel has no direct access to public Right of Way.
- The property has significant wetlands which will remain undisturbed.
- The Future Land Use Map shows this parcel within the Residential use category.

Suggested Action:

At the June 2, 2025 meeting, the Planning Commission voted to recommend approval of this item.

Funding: N/A

Recommendation:

APPLICATION TO AMEND THE ZONING MAP OF PORT WENTWORTH, GEORGIA

Applicant: Phillip R. McCorkle

Phone # (912) 232-7416

Mailing Address: 319 Tattnell Street, Savannah, Georgia 31401

Property Owner: SPH 21, LLC

Phone # (404) 358-1178

Use back if more than one owner

Owner Address: 5 Concourse Parkway, Suite 200, Atlanta, Georgia 30328

PIN #(s): 7-0976-02-038

of Acres 23.021

Zoning Classification: Present R-1

Requested R-4

Use of Property: Present Vacant

Requested Townhomes

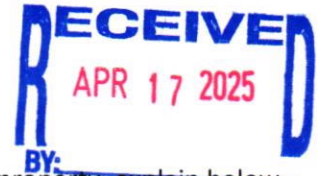

X If the requested change is to extend an existing adjacent zoning district to include this property, explain below why the proposed change should be made.

If the requested change is not to extend an adjacent zoning district, explain below why this property should be placed in a different zoning district than all adjoining properties. (How does it differ from adjoining properties and why should it be subject to different restrictions than those applying to adjoining properties?)

TMGRI has contracted to acquire 23 acres from SPH 21. More than half of the tract is wetlands that will not be developed. The uplands provide the opportunity to add 63 townhome units to Arbor View, a 162 unit development currently under construction. This use of the property is a natural extension of an existing use. Moreover, there is no other access to the 23 acre tract except Berrien Road, a substandard local road.

Attach the following documents:

- 1. Written legal description of the property (e.g. copy of deed) – full metes and bounds description rather than plat reference.
2. Name, PIN #, property address and mailing address of property owners within 300 feet of this property.
3. Plat showing property lines with lengths and bearings, adjoining streets, locations of existing buildings, north arrow and scale. Submit three (3) copies of in 11" x 17", one 1 copy in 8.5" x 11", and a PDF on a flash drive.
4. Site Plan of proposed use of property. Submit three (3) copies in 11" x 17", one 1 copy in 8.5" x 11", and a PDF on a flash drive.
5. Disclosure of Campaign Contributions and Gifts form.
6. Disclosure of Financial Interests form
7. If property owner and applicant are not the same, Authorization by Property Owner form or Authorizations of Attorney form.
8. Filing fee of Zoning Map Amendment Fee + per acre + Administrative Fee = Total, payable to the City of Port Wentworth. (Please refer to the Business User Fee Schedule for the current year)

APPLICATION MUST BE FILED 20 BUSINESS DAYS PRIOR TO THE PLANNING COMMISSION MEETING AT WHICH THEY ARE TO BE CONSIDERED.

I hereby authorize the staff of the City of Port Wentworth to inspect the premises of the above described property and to post this property with the duly required notices. I hereby depose and say that all statements herein and attached statements submitted are true and correct to the best of my knowledge and belief.

Sworn to and subscribed before me this

17 day of April, 2025

[Signature]
Notary Public



[Signature]
Signature of Applicant



DISCLOSURE OF CAMPAIGN CONTRIBUTIONS
(Required by Title 36, Chapter 67A, Official Code of Georgia Annotated)

Reference: Application filed on _____, 20_____, to rezone real property described as follows:

See Exhibit Attached hereto

Within the two years preceding the above filing date, the applicant has made campaign contributions aggregating \$250.00 or more to each member of the City Council of the City of Port Wentworth who will consider the application and is listed below. List (1) the name and official position of the local government official and (2) the dollar amount, description and date of each campaign contribution.

None

I hereby depose and say that all statements herein are true, correct and complete to the best of my knowledge and belief.

Sworn to and subscribed before me this
17 day of April, 20 25.

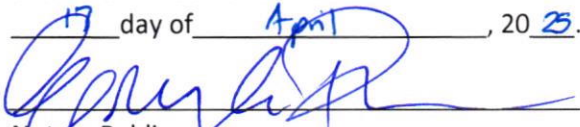
Notary Public



Signature of Applicant
Phillip R. McCorkle



DISCLOSURE OF FINANCIAL INTERESTS

(Required by Title 36, Chapter 67A, Official Code of Georgia Annotated)

Reference: Application filed on _____, 20_____, to rezone real property described as follows:

The undersigned official of the City of Port Wentworth has a property interest (Note 1) in said property as follows:

The undersigned official of the City of Port Wentworth has financial interest (Note 2) in a business entity (Note 3) which has property interest in said property, which financial interests as follows:

The undersigned official of the City of Port Wentworth has a member of the family (Note 4) having a property interest in said property or a financial interest in a business entity which has a property interest in said property, which family member and property interest or financial interest are as follows:

Note 1: Property Interest – Direct ownership of real property, including any percentage of ownership less than total ownership

Note 2: Financial Interest – All direct ownership interest of the total assets or capital stock of a business entity where such ownership interest is 10 percent or more

Note 3: business entity – Corporation, partnership, limited partnership, firm, enterprise, franchise, association or trust

Note 4: Member of family – Spouse, mother, father, brother, sister, son, or daughter

I hereby depose and say that all statements herein are true, correct and complete to the best of my knowledge and belief.

Sworn to and subscribed before me this _____ day of _____, 20____.

Signature of Official

Notary Public

Updated 8/25/2023

AUTHORIZATION OF PROPERTY OWNER

Application for Rezoning or Variance

I swear that I am the owner of the property which is the subject matter of the attached application, as is shown in the records of Port Wentworth, Georgia.

I authorize the person named below to act as applicant in the pursuit of a variance or for the rezoning of this property.

Name of Applicant: Phillip R. McCorkle

Address: 319 Tattnall Street, Savannah, Georgia 31401

Telephone Number: (912) 232-7416

SPH 21, LLC

By: 
Signature of Owner
Manager

Personally appeared before me

David G. Hanna

who swears that the information contained in this authorization is true and correct to the best of his or her knowledge and belief.

Kendra L Noyes
Notary Public

4-15-25
Date



Property Owners Within 300 Feet



F3 GA HWY 30 BTR PROPERTY OWNER
LLC
PIN: 70976 02027
Parcel Address: 300 Highway 30, Port
Wentworth, Georgia 31407
Mailing Address: 3 Bethesda Metro Center,
Suite 1400, Bethesda, Maryland 20814

Estate of Alvin Williams
PIN: 70976 02005
Parcel Address: Berrien Ave, Port Wentworth,
Georgia 31407
Mailing Address: c/o Gary Heywood, 24
Litchfield Drive, Savannah, Georgia 31419

Rosetta Foreman Graham
PIN: 70976 02046
Parcel Address: Berrien Ave, Port Wentworth,
Georgia 31407
Mailing Address: 601 E. 7th Street, Vidalia,
Georgia 30474

Lonnie L. Oglesby
PIN: 700976 02045
Parcel Address: Berrien Ave, Port Wentworth,
Georgia 31407
Mailing Address: 1015 Elliott Avenue,
Savannah, Georgia 31415

Zachary D. Mucha
PIN: 70976 02008
Parcel Address: 250 Berrien Ave, Port
Wentworth, Georgia 31407
Mailing Address: 32 Silverstone Circle,
Savannah, Georgia 31406

EDWARD B. DEAL PROPERTIES NO. 2 LLC
PIN: 70976 02009
Parcel Address: Berrien Ave, Port Wentworth,
Georgia 31407
Mailing Address: 301 Oxford Lane, Savannah,
Georgia 31405

Raddie Jackson, Et Al.
PIN: 70976 02010
Parcel Address: Berrien Ave, Port Wentworth,
Georgia 31407
Mailing Address: 725 W. 46th Street, Savannah,
Georgia 31405

SPH 21, LLC
PIN: 70976 02037
Parcel Address: Saussy Road, Port Wentworth,
Georgia 31407
Mailing Address: 6 Concourse Parkway, Suite
200, Atlanta, Georgia 30328

Willie Steele Place, LLC
PIN: 70976 02007
Parcel Address: Punkin Bridge Road, Port
Wentworth, Georgia 31407
Mailing Address: 4 Marsh Harbor Drive N,
Savannah, Georgia 31401

Parkside Port Wentworth, LLC
PIN: 70976C01004
Parcel Address: 436 Highway 30, Port
Wentworth, Georgia 31407
Mailing Address: 3565 Piedmont Road NE,
Building One, Suite 200, Atlanta, Georgia 30305



LEGAL DESCRIPTION
PARCEL N

ALL THAT CERTAIN LOT, TRACT OR PARCEL OF LAND SITUATE, LYING AND BEING IN THE 8TH G.M. DISTRICT, CITY OF PORT WENTWORTH, CHATHAM COUNTY, STATE OF GEORGIA, AND BEING SHOWN AND DEPICTED AS 'PARCEL N' ON THAT PLAT ENTITLED "A SUBDIVISION PLAT OF 823.603 ACRES", PREPARED FOR SPH 21, LLC, BY ATLAS SURVEYING, INC., DATED MARCH 19, 2025, RECORDED IN PLAT BOOK 54, PAGE 704, CHATHAM COUNTY, GEORGIA RECORDS, HAVING AN AREA OF 975, 393 SQUARE FEET OR 22.392 ACRES OF LAND.

RECEIVED
APR 17 2025
BY: [Signature]

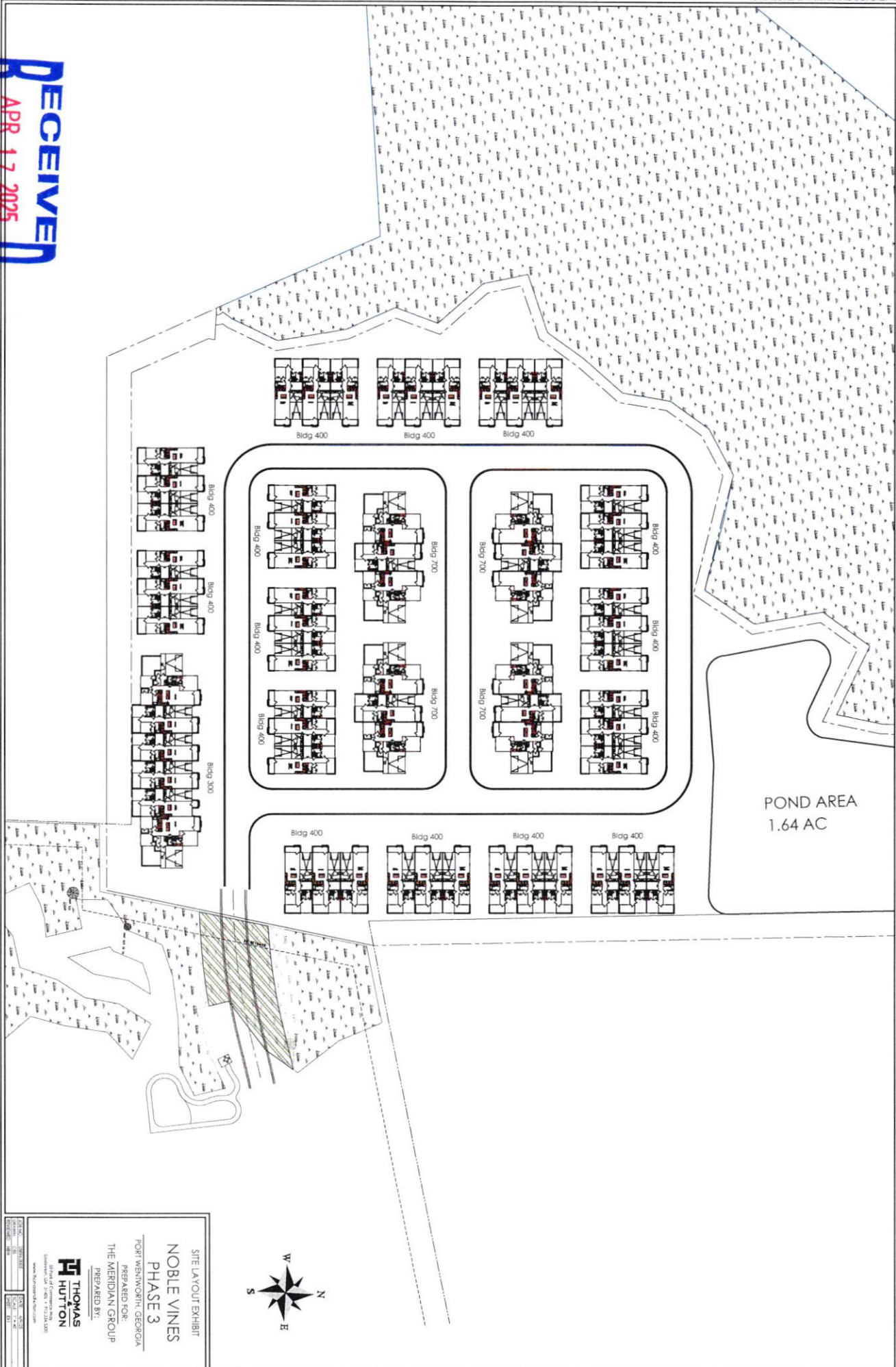

SITE LAYOUT EXHIBIT
NOBLE VINES
PHASE 3
 FORT WASHINGTON, GEORGIA
 PREPARED FOR:
 THE MERIDIAN GROUP
 PREPARED BY:
THOMAS HUTTON
 ARCHITECTS
 1000 W. WASHINGTON AVENUE
 SUITE 100
 ATLANTA, GA 30335
 www.thomashutton.com

RECEIVED
APR 17 2025

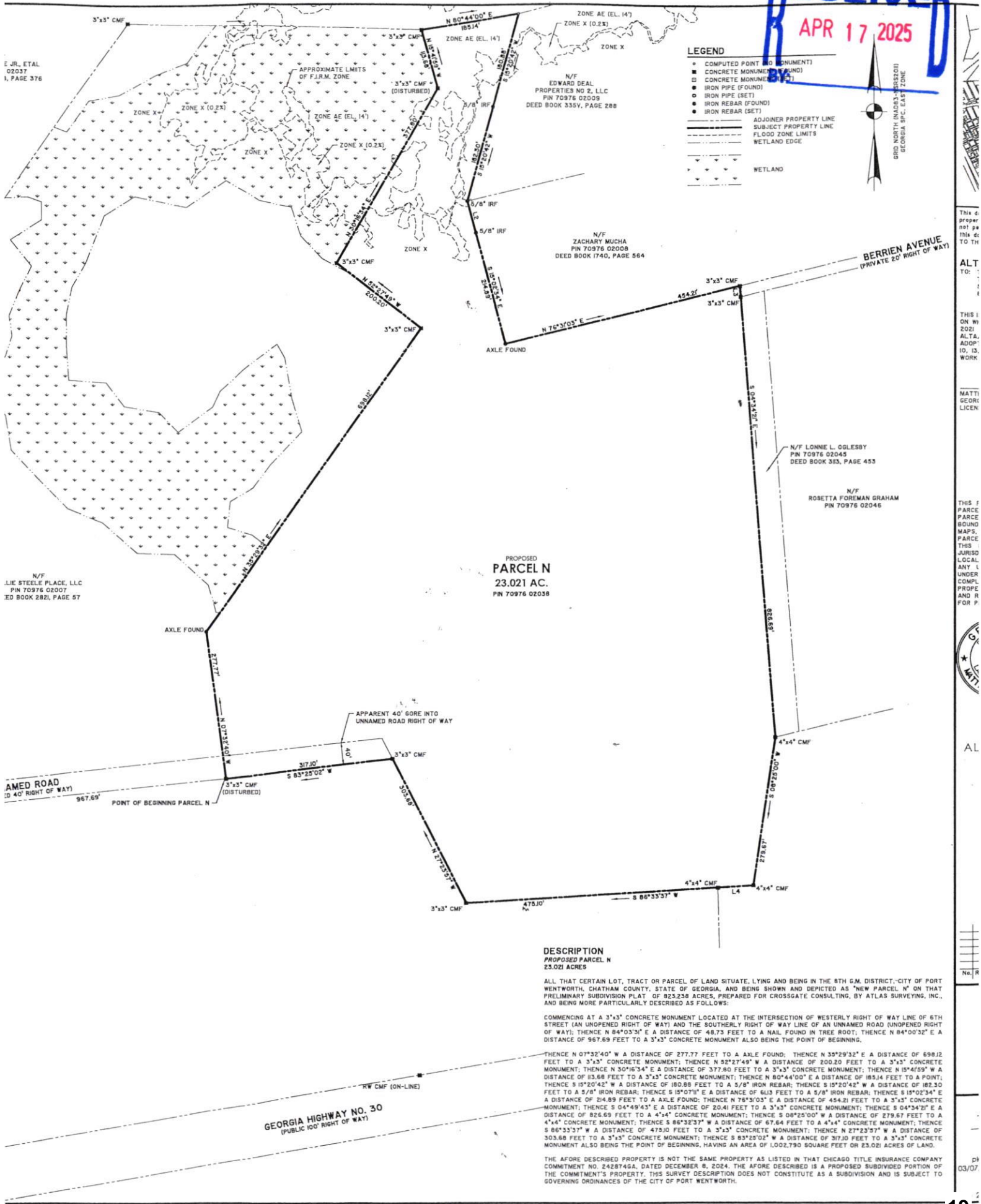

LEGEND

- COMPUTED POINT (NO MONUMENT)
- CONCRETE MONUMENT (FOUND)
- CONCRETE MONUMENT (SET)
- IRON PIPE (FOUND)
- IRON PIPE (SET)
- IRON REBAR (FOUND)
- IRON REBAR (SET)
- ADJOINER PROPERTY LINE
- SUBJECT PROPERTY LINE
- - - FLOOD ZONE LIMITS
- - - WETLAND EDGE
- WETLAND

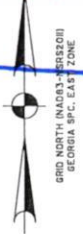

PROPOSED PARCEL N
 23.021 AC.
 PIN 70976 02058

DESCRIPTION
 PROPOSED PARCEL N
 23.021 ACRES

ALL THAT CERTAIN LOT, TRACT OR PARCEL OF LAND SITUATE, LYING AND BEING IN THE 8TH G.M. DISTRICT, CITY OF PORT WENTWORTH, CHATHAM COUNTY, STATE OF GEORGIA, AND BEING SHOWN AND DEPICTED AS "NEW PARCEL N" ON THAT PRELIMINARY SUBDIVISION PLAT OF 823.238 ACRES, PREPARED FOR CROSSGATE CONSULTING, BY ATLAS SURVEYING, INC., AND BEING MORE PARTICULARLY DESCRIBED AS FOLLOWS:

COMMENCING AT A 3"x3" CONCRETE MONUMENT LOCATED AT THE INTERSECTION OF WESTERLY RIGHT OF WAY LINE OF 6TH STREET (AN UNOPENED RIGHT OF WAY) AND THE SOUTHERLY RIGHT OF WAY LINE OF AN UNNAMED ROAD (UNOPENED RIGHT OF WAY); THENCE N 84°03'31" E A DISTANCE OF 487.73 FEET TO A NAIL FOUND IN TREE ROOT; THENCE N 84°00'32" E A DISTANCE OF 967.69 FEET TO A 3"x3" CONCRETE MONUMENT ALSO BEING THE POINT OF BEGINNING;

THENCE N 07°32'40" W A DISTANCE OF 277.77 FEET TO AN AXLE FOUND; THENCE N 35°29'32" E A DISTANCE OF 698.12 FEET TO A 3"x3" CONCRETE MONUMENT; THENCE N 92°27'49" W A DISTANCE OF 200.20 FEET TO A 3"x3" CONCRETE MONUMENT; THENCE N 30°46'34" E A DISTANCE OF 377.80 FEET TO A 3"x3" CONCRETE MONUMENT; THENCE N 19°46'59" W A DISTANCE OF 83.68 FEET TO A 3"x3" CONCRETE MONUMENT; THENCE N 80°44'00" E A DISTANCE OF 185.14 FEET TO A POINT; THENCE S 15°20'42" W A DISTANCE OF 180.89 FEET TO A 5/8" IRON REBAR; THENCE S 15°20'42" W A DISTANCE OF 182.30 FEET TO A 5/8" IRON REBAR; THENCE S 15°07'11" E A DISTANCE OF 613.33 FEET TO A 5/8" IRON REBAR; THENCE S 15°02'34" E A DISTANCE OF 214.89 FEET TO AN AXLE FOUND; THENCE N 76°31'03" E A DISTANCE OF 454.21 FEET TO A 3"x3" CONCRETE MONUMENT; THENCE S 04°49'43" E A DISTANCE OF 20.41 FEET TO A 3"x3" CONCRETE MONUMENT; THENCE S 04°34'21" E A DISTANCE OF 826.69 FEET TO A 4"x4" CONCRETE MONUMENT; THENCE S 08°25'00" W A DISTANCE OF 279.67 FEET TO A 4"x4" CONCRETE MONUMENT; THENCE S 86°32'37" W A DISTANCE OF 67.64 FEET TO A 4"x4" CONCRETE MONUMENT; THENCE S 86°32'37" W A DISTANCE OF 475.00 FEET TO A 3"x3" CONCRETE MONUMENT; THENCE N 27°23'57" W A DISTANCE OF 303.88 FEET TO A 3"x3" CONCRETE MONUMENT; THENCE S 83°25'02" W A DISTANCE OF 317.10 FEET TO A 3"x3" CONCRETE MONUMENT ALSO BEING THE POINT OF BEGINNING, HAVING AN AREA OF 1,002,790 SQUARE FEET OR 23.021 ACRES OF LAND.

THE AFORE DESCRIBED PROPERTY IS NOT THE SAME PROPERTY AS LISTED IN THAT CHICAGO TITLE INSURANCE COMPANY COMMITMENT NO. 2428746A, DATED DECEMBER 8, 2024. THE AFORE DESCRIBED IS A PROPOSED SUBDIVIDED PORTION OF THE COMMITMENT'S PROPERTY. THIS SURVEY DESCRIPTION DOES NOT CONSTITUTE AS A SUBDIVISION AND IS SUBJECT TO GOVERNING ORDINANCES OF THE CITY OF PORT WENTWORTH.

E JR., ETAL
 02037
 1, PAGE 376

N/F
 L.I.E STEELE PLACE, LLC
 PIN 70976 02007
 ED BOOK 2821, PAGE 57

N/F
 EDWARD DEAL
 PROPERTIES NO 2, LLC
 PIN 70976 02009
 DEED BOOK 335V, PAGE 288

N/F
 ZACHARY MUCHA
 PIN 70976 02008
 DEED BOOK 1740, PAGE 564

N/F LONNE L. OGLESBY
 PIN 70976 02045
 DEED BOOK 333, PAGE 453

N/F ROSETTA FOREMAN GRAHAM
 PIN 70976 02046

This d
 proper
 not ge
 this d
 TO TH

ALT
 TO:

THIS I
 ON W
 2021
 ALTA,
 ADOP
 ID, IS,
 WORK

MATTI
 GEOR
 LICEN

THIS P
 PARCE
 BOUND
 MAPS
 PARCE
 THIS J
 JURISD
 LOCAL
 ANY L
 UNDER
 COMPL
 PROPE
 AND R
 FOR P



AL

No. R

ps
 03/07

Arbor View Townhomes - Full Plan

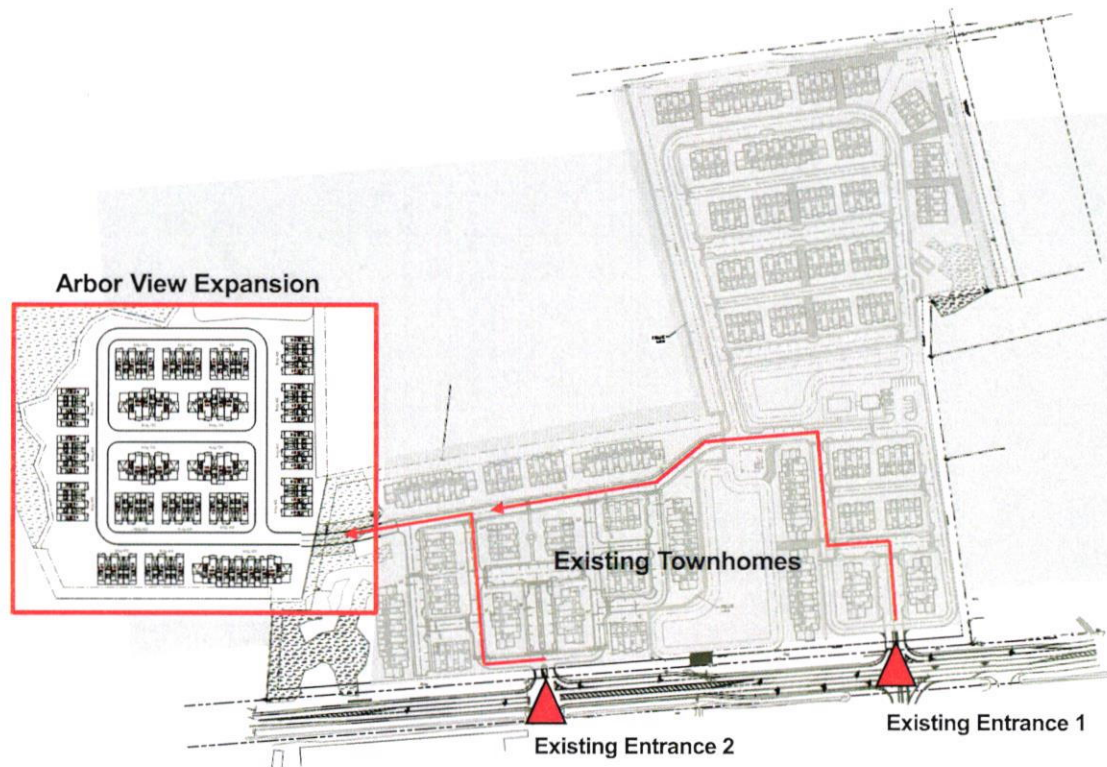

CONFIDENTIAL

RECEIVED
APR 17 2025
BY: _____

TMG 5

Arbor View Townhomes (UNDER CONSTRUCTION)

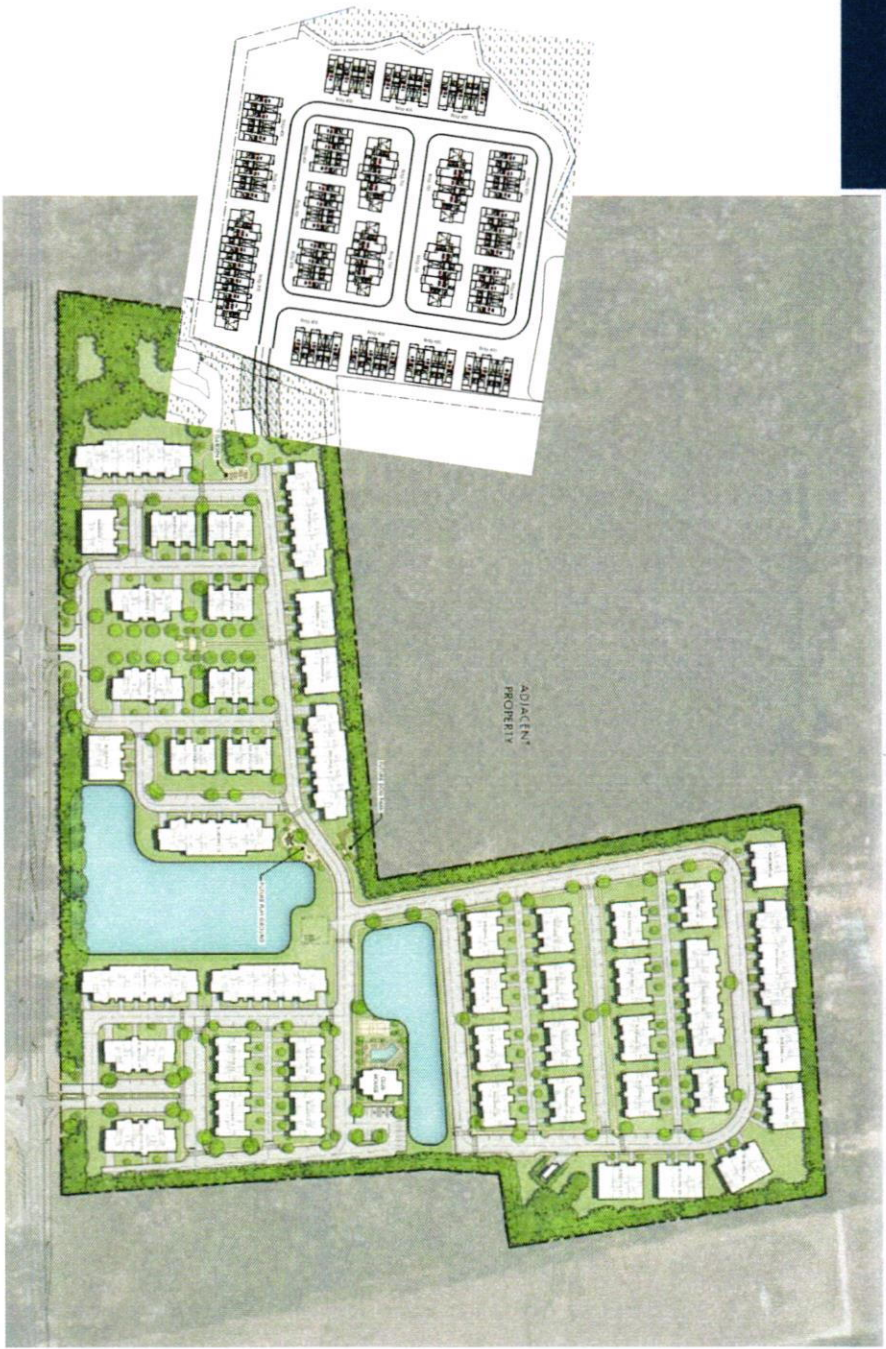

CONFIDENTIAL

RECEIVED
APR 17 2025
BY: _____

TMG 11



City Council
7224 GA Highway 21
Port Wentworth, GA 31407

Meeting: 08/21/25
Department: Development Services
Category: Ordinance
Prepared By: Katie Dunnigan
Department Head: Katie Dunnigan

SCHEDULED

AGENDA ITEM (ID)

DOC ID:

Phillip McCorkle, as Agent for SPH 21, LLC, requests the approval of a Concept Site Plan "Arbor View PH 2". PIN# 70976 02038 located off Highway 30 in the 1st Council District. Zoned R-1, proposed zoning R-4.

Issue/Item: Phillip McCorkle, as Agent for SPH 21, LLC, requests the approval of a Concept Site Plan "Arbor View PH 2". PIN# 70976 02038 located off Highway 30 in the 1st Council District. Zoned R-1, proposed zoning R-4.

Background:

- The applicant proposes to develop 63 townhomes as an extension of the existing Arbor View community.
- Access will be via connection to the existing development.
- A requisite neighborhood meeting was held for this project on April 30, 2025. Community input including discussion regarding wetlands, future property sales, and the desire for improvements to Berrien Road. No input submitted triggered alteration to the site plan.
- *Pursuant to The Code of the City of Port Wentworth Georgia, Zoning Ordinances, Section 13.20: "After review and recommendation by the Planning Commission, the City Council shall act upon all concept plans...required in Table 13.20."*

Facts and Finding:

- The Future Land Use Map identifies the subject parcel as residential.
- Proposed units will be consistent with the first phase of Arbor View.
- Amenities will be shared with the existing development.
- The developer will be preserving the 12+ acres of wetlands (of approximately 23 total) on site.
- A 2nd Reading for the rezoning of this parcel to R-4 will be held at the August 21, 2025 City Council meeting.

Suggested Action

During the July 7, 2025 meeting, the Planning Commission voted to recommend approval of this item, with the following condition:

1. Approval of the Concept Site Plan is contingent upon the successful rezoning of the subject property to R-4.

Funding: N/A

Recommendation:

City of Port Wentworth
7224 Highway 21 Port Wentworth Georgia 31407 912-999-2084

Site Plan Review Application



Site Plan Type (Check One): General / Concept Specific Development

Site Plan Address: 0 Saussy Road

PIN #(s): 7-0976-02-038

Zoning: R-1 Estimated Cost of Construction: \$

Type of Construction: Residential

Project Name: Expansion of Arbor View

Applicant's Name: Phillip McCorkle

Mailing Address: 319 Tattnall Street, Savannah, Georgia 31401

Phone #: (912) 232-7416 Email: prm@mccorklejohnson.com

Owner's Name (if Different form Applicant): SPH 21, LLC

Mailing Address: 5 Concourse Parkway, Suite 200, Atlanta, Georgia 30328

Phone #: (404) 358-1178 Email: chayes@crossgateconsulting.com

I hereby acknowledge that the above information is true and correct.

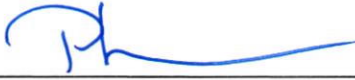
Applicant's Signature

5/22/25
Date

Owner's Signature (if Different form Applicant)

Date

Please see page 2 for required submittal checklist

Site Plan Review Application Submittal Checklist

Documentation below is required for a complete submittal.

- Signed and Completed Application
- 3 Full size sets of site plan civil drawings or concept plan (depending on type of site plan)
- 3 half size (11" X 17") sets of site plan civil drawings or concept plan (depending on type of site plan)
- 2 copies of hydrology reports (if applicable)
- Names, mailing address, and PIN number of all property owners within 250 feet of all property lines
- 1 8 ½" X 11" of site plan civil drawings or concept plan (depending on type of site plan)
- PDF of entire submittal on a flash drive or download link ONLY (NO CD'S)
- Other Engineering details or reports may be required once submittal has been received.
- If property owner and applicant are not the same, Authorization of Property Owner form.
- Site plan review fee check (*Please refer to the "Business User Fee Schedule" for the current year.*)
 - o Concept / General - Site Plan Fee + Admin Fee = Total
 - o Specific - Site Plan Fee + Admin Fee = Total

Additional Fee Statement: If engineer review cost to the City exceeds the site plan review fee that is paid at the time of initial application submittal, you may be required to pay additional review cost.

I have read and agree to the above additional fee statement



Applicant's Signature



Date

AUTHORIZATION OF PROPERTY OWNER

Application for Rezoning or Variance

I swear that I am the owner of the property which is the subject matter of the attached application, as is shown in the records of Port Wentworth, Georgia.

I authorize the person named below to act as applicant in the pursuit of a Concept Plan Approval for variance or for the ~~rezoning of~~ this property.

Name of Applicant: Phillip R. McCorkle

Address: 319 Tattnall Street, Savannah, Georgia 31401

Telephone Number: (912) 232-7416

SPH 21, LLC

By: 
Signature of Owner
Manager

Personally appeared before me

David G. Hanna

who swears that the information contained in this authorization is true and correct to the best of his or her knowledge and belief.

Kendra L Noyes
Notary Public

4-15-25
Date

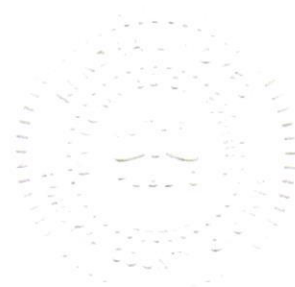
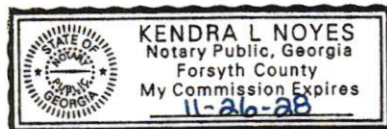

Property Owners Within 300 Feet

F3 GA HWY 30 BTR PROPERTY OWNER
LLC

PIN: 70976 02027

Parcel Address: 300 Highway 30, Port
Wentworth, Georgia 31407

Mailing Address: 3 Bethesda Metro Center,
Suite 1400, Bethesda, Maryland 20814

Estate of Alvin Williams

PIN: 70976 02005

Parcel Address: Berrien Ave, Port Wentworth,
Georgia 31407

Mailing Address: c/o Gary Heywood, 24
Litchfield Drive, Savannah, Georgia 31419

Rosetta Foreman Graham

PIN: 70976 02046

Parcel Address: Berrien Ave, Port Wentworth,
Georgia 31407

Mailing Address: 601 E. 7th Street, Vidalia,
Georgia 30474

Lonnie L. Oglesby

PIN: 700976 02045

Parcel Address: Berrien Ave, Port Wentworth,
Georgia 31407

Mailing Address: 1015 Elliott Avenue,
Savannah, Georgia 31415

Zachary D. Mucha

PIN: 70976 02008

Parcel Address: 250 Berrien Ave, Port
Wentworth, Georgia 31407

Mailing Address: 32 Silverstone Circle,
Savannah, Georgia 31406

EDWARD B. DEAL PROPERTIES NO. 2 LLC

PIN: 70976 02009

Parcel Address: Berrien Ave, Port Wentworth,
Georgia 31407

Mailing Address: 301 Oxford Lane, Savannah,
Georgia 31405

Raddie Jackson, Et Al.

PIN: 70976 02010

Parcel Address: Berrien Ave, Port Wentworth,
Georgia 31407

Mailing Address: 725 W. 46th Street, Savannah,
Georgia 31405

SPH 21, LLC

PIN: 70976 02037

Parcel Address: Saussy Road, Port Wentworth,
Georgia 31407

Mailing Address: 6 Concourse Parkway, Suite
200, Atlanta, Georgia 30328

Willie Steele Place, LLC

PIN: 70976 02007

Parcel Address: Punkin Bridge Road, Port
Wentworth, Georgia 31407

Mailing Address: 4 Marsh Harbor Drive N,
Savannah, Georgia 31401

Parkside Port Wentworth, LLC

PIN: 70976C01004

Parcel Address: 436 Highway 30, Port
Wentworth, Georgia 31407

Mailing Address: 3565 Piedmont Road NE,
Building One, Suite 200, Atlanta, Georgia 30305



50 PARK OF COMMERCE WAY
SAVANNAH, GA 31405 | 912.234.5300
WWW.THOMASANDHUTTON.COM

MEMORANDUM

TO: John Kent – GDOT
FROM: Nathan Long, P.E. – T&H Project Manager
DATE: May 16, 2025
RE: Arbor View – Additional Units Memo
J-28896.0005

INTRODUCTION

This memorandum serves to provide a level of service analysis to the Arbor View accesses with the inclusion of additional townhome units.

The approved and constructed Arbor View development (phase 1) includes a total of 162 townhome units and a clubhouse, the proposed expansion (phase 2) includes an additional 63 townhome units.

This memo evaluates level of service impacts to the site accesses of the additional 63 townhome units. A site plan is included in the Appendix.

METHOD

Counts are collected at the existing site access intersections in April 2025, at the time counts were collected, 27 townhomes were occupied. The proposed expansion anticipated to be completed in 2026. Counts are grown to 2026 with a 1.7% growth rate. The phase 1 build out condition and the phase 2 build out condition incorporate the grown count data. Eastbound left turn lanes and westbound right turn lanes are constructed on GA-30 for both accesses in the phase 1 condition and are included in analysis.

The proposed units generate an additional 27 AM peak hour trips and 34 PM peak hour trips, trip generation calculations are included in the appendix. Trips are assigned based on the distributions provided in the appendix, distributions follow the approved 2021 Noble Vines TIA and are modified for the proposed site layout. Level of service for the 2026 phase 1 build out conditions and the 2026 phase 2 build out conditions are shown below in table 1. Synchro Reports are included in the appendix.

Table 1: Future Build Out Levels of Service (2026 - Phase 1+2 & 3)											
Int #	Intersection	Approach	Control	Build Out Phase 1				Build Out Phase 2			
				LOS		Delay (sec)		LOS		Delay (sec)	
				AM	PM	AM	PM	AM	PM	AM	PM
1	GA-30 & Stop-N-Stor Driveway / Access Drive 1	GA-30 - EB lefts	Minor Stop	A	A	8	9	A	A	8	9
		GA-30 - WB lefts		A	A	0	8	A	A	0	8
		Stop-N-Store Dwy - NB		A	C	0	21	A	C	0	21
		Access Drive 1 - SB		D	C	34	21	E	C	38	22
2	GA-30 & Newport Boulevard / Access Drive 2	GA-30 - EB lefts	Minor Stop	A	A	8	9	A	A	8	9
		GA-30 - WB lefts		B	A	12	9	B	A	12	9
		Newport Boulevard - NB		E	C	39	20	E	C	40	21
		Access Drive 2 - SB		F	D	90	32	F	D	112	35

The additional trips trigger an increase in delay of 24% in the AM peak and 9% in the PM peak for Access Drive 2. Access Drive 1 increase in delay of 12% in the AM peak hour and 5% in the PM peak hour.

CONCLUSION

Phase 1 of the Arbor View development have been approved and are under construction, turn lanes are constructed for the ingress of both accesses in this phase. A proposed expansion adds an additional 63 units to the development. The 63 units generate an additional 27 AM peak hour trips and 34 PM peak hour trips. The additional trips provide a minimal increase in delay to the Arbor View site accesses and surrounding roadways. The turn lanes built in phase 1 will alleviate congestion concerns caused by the site on GA-30 and will provide sufficient storage for the proposed expansion.

Appendix

Site Location



Phase 1 Development

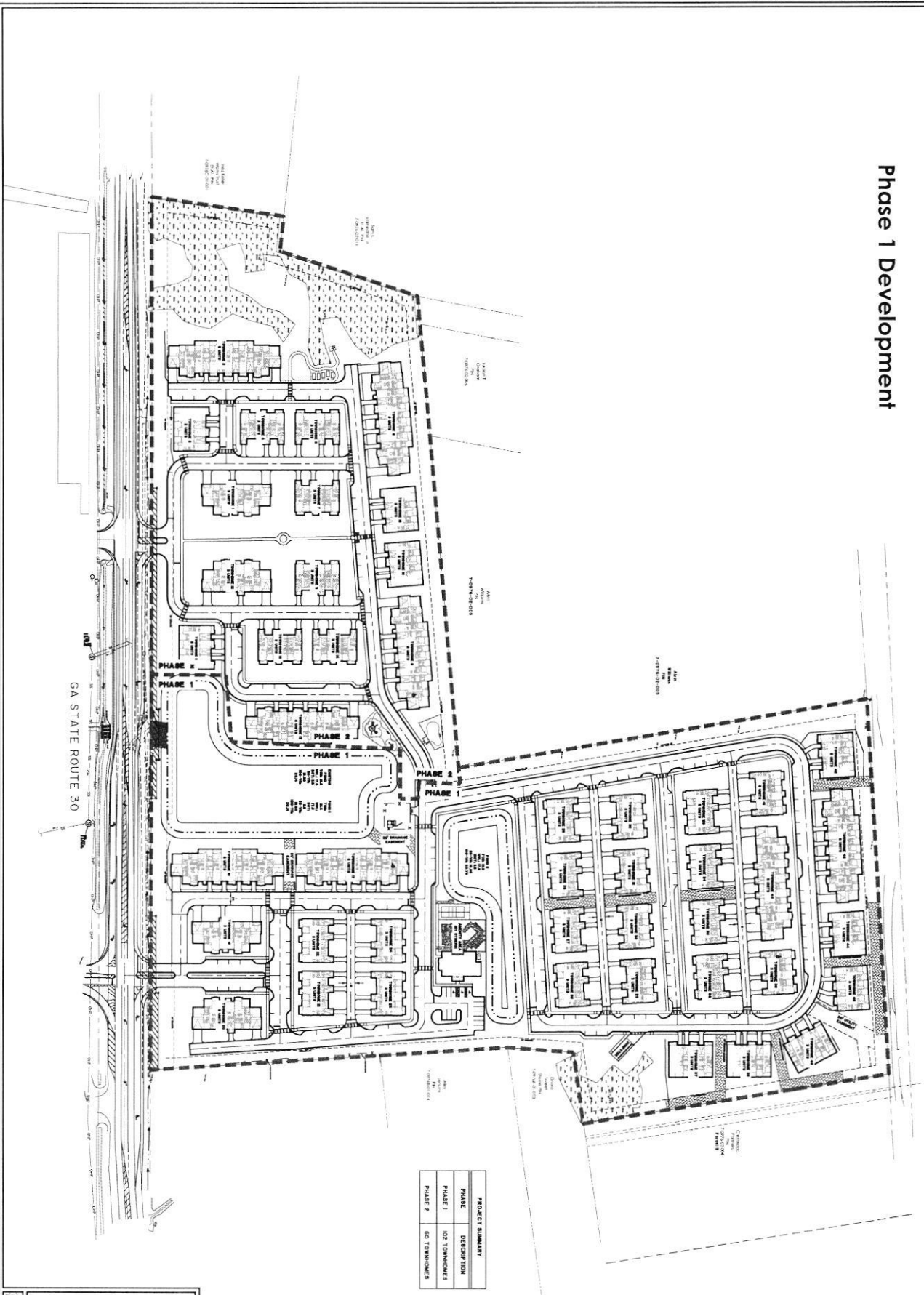

PROJECT SUMMARY	
PHASE	DESCRIPTION
PHASE 1	102 TOWNHOMES
PHASE 2	60 TOWNHOMES

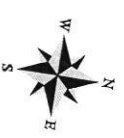

OVERALL LAYOUT EXHIBIT
ARBOR VIEW
 FORT WENTWORTH, GA
 PREPARED FOR:
 TMC
 PREPARED BY:
THOMAS HUTTON
 State of Georgia, Surveyor
 License No. 10000
 1000 Peachtree Street, N.E.
 Atlanta, Georgia 30309

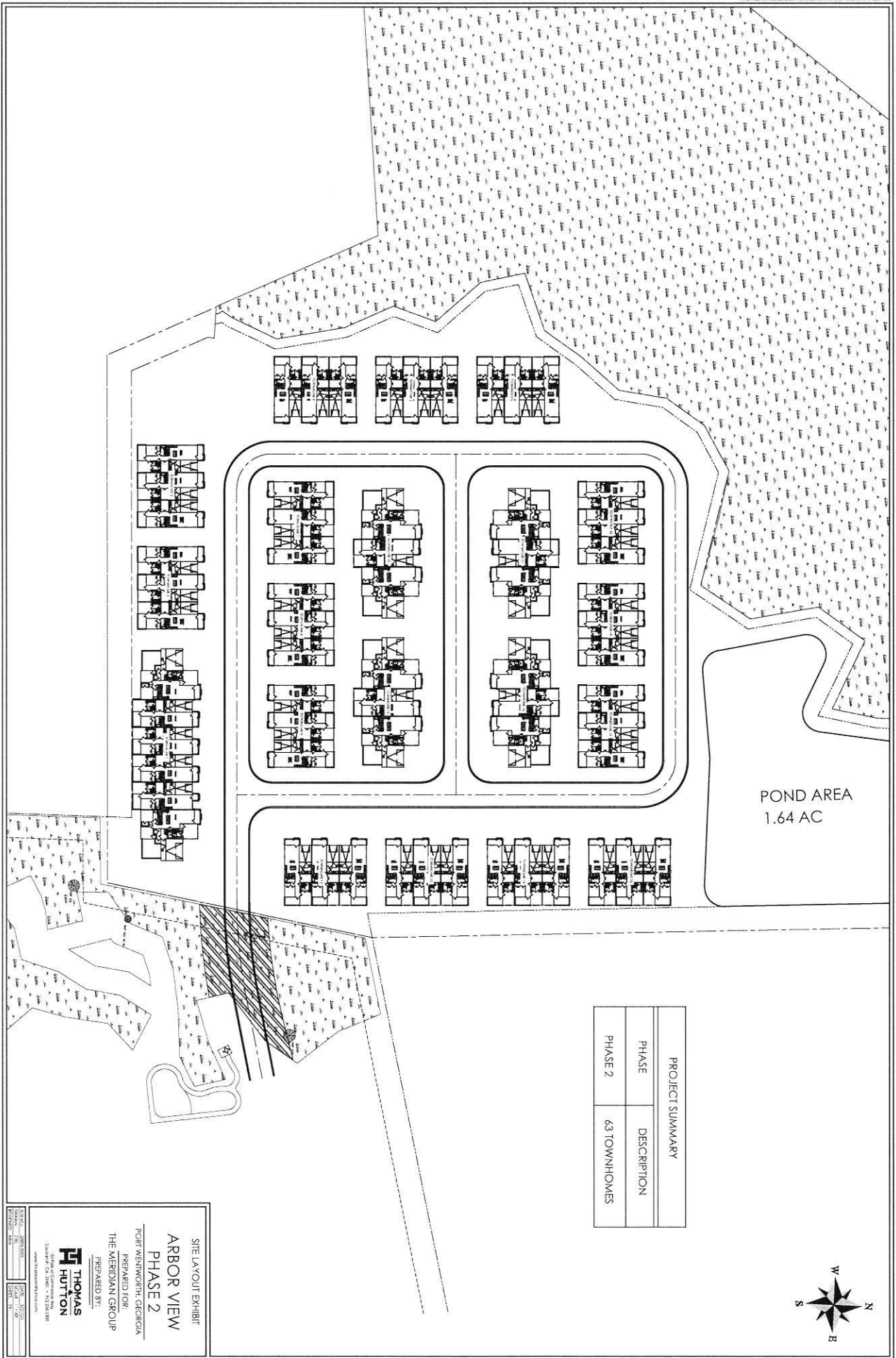

POND AREA
1.64 AC

PROJECT SUMMARY	
PHASE	DESCRIPTION
PHASE 2	63 TOWNHOMES



SITE LAYOUT EXHIBIT
ARBOR VIEW
PHASE 2
 FORT WENSWORTH, GEORGIA
 PREPARED FOR:
 THE MERIDIAN GROUP
 PREPARED BY:
THOMAS HUTTON
300 Peachtree Street, Suite 2000
 Atlanta, Georgia 30308
 www.thomashutton.com

DATE: 08/11/2011
 SCALE: AS SHOWN
 SHEET: 32

TRIP GENERATION CALCULATIONS - ARBOR VIEW ADDITIONAL UNITS MEMO

ARBOR VIEW - PHASE 1 ONLY												
ITE LAND USE CODE	SIZE		ADT		AM PEAK HOUR				PM PEAK HOUR			
			TRIP EQUATION	ADT	TRIP EQUATION	TOTAL TRIPS	TRIPS ENTER	TRIPS EXIT	TRIP EQUATION	TOTAL TRIPS	TRIPS ENTER	TRIPS EXIT
							25%	75%			59%	41%
215 - SINGLE FAMILY ATTACHED HOUSING	DWELLING UNITS	135	$T = 7.62 * (X) - 50.48$	978	$T = 0.52 * (X) - 5.70$	65	16	49	$T = 0.60 * (X) - 3.93$	77	45	32

ARBOR VIEW - PHASE 2 ONLY												
ITE LAND USE CODE	SIZE		ADT		AM PEAK HOUR				PM PEAK HOUR			
			TRIP EQUATION	ADT	TRIP EQUATION	TOTAL TRIPS	TRIPS ENTER	TRIPS EXIT	TRIP EQUATION	TOTAL TRIPS	TRIPS ENTER	TRIPS EXIT
							25%	75%			59%	41%
215 - SINGLE FAMILY ATTACHED HOUSING	DWELLING UNITS	63	$T = 7.62 * (X) - 50.48$	430	$T = 0.52 * (X) - 5.70$	27	7	20	$T = 0.60 * (X) - 3.93$	34	20	14

ARBOR VIEW - PHASE 1 & 2												
ITE LAND USE CODE	SIZE		ADT		AM PEAK HOUR				PM PEAK HOUR			
			ADT	TOTAL TRIPS	TRIPS ENTER	TRIPS EXIT	TOTAL TRIPS	TRIPS ENTER	TRIPS EXIT			
					25%	75%		59%	41%			
215 - SINGLE FAMILY ATTACHED HOUSING	DWELLING UNITS	198	1,408	92	23	69	111	65	46			

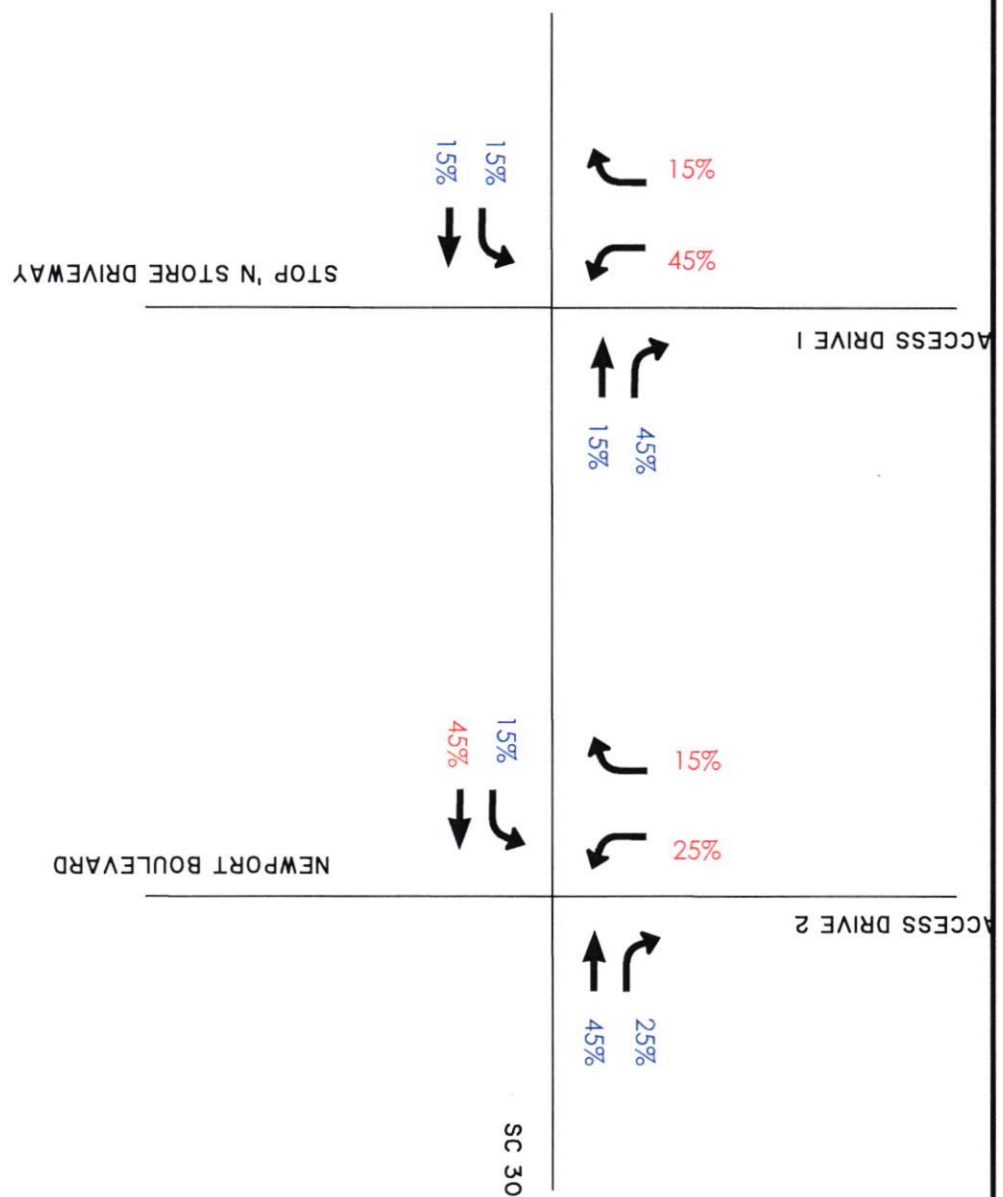

INBOUND %
OUTBOUND %

ARBOR VIEW
TRIP DISTRIBUTION

THOMAS & HUTTON

50 Park of Commerce Way
Savannah, GA 31405 • 912.234.5300
www.thomasandhutton.com

Intersection												
Int Delay, s/veh	0.8											
Movement	EBL	EBT	EBR	WBL	WBT	WBR	NBL	NBT	NBR	SBL	SBT	SBR
Lane Configurations	↖	↗		↖	↗	↖		↕			↕	
Traffic Vol, veh/h	3	1123	0	0	206	19	0	0	0	24	0	8
Future Vol, veh/h	3	1123	0	0	206	19	0	0	0	24	0	8
Conflicting Peds, #/hr	0	0	0	0	0	0	0	0	0	0	0	0
Sign Control	Free	Free	Free	Free	Free	Free	Stop	Stop	Stop	Stop	Stop	Stop
RT Channelized	-	-	None	-	-	Yield	-	-	None	-	-	None
Storage Length	310	-	-	310	-	250	-	-	-	-	-	-
Veh in Median Storage, #	-	0	-	-	0	-	-	0	-	-	0	-
Grade, %	-	0	-	-	0	-	-	0	-	-	0	-
Peak Hour Factor	97	97	97	97	97	97	97	97	97	97	97	97
Heavy Vehicles, %	0	2	0	0	8	0	0	0	0	0	0	0
Mvmt Flow	3	1158	0	0	212	20	0	0	0	25	0	8

Major/Minor	Major1	Major2	Minor1	Minor2
Conflicting Flow All	212	0	0	1158
Stage 1	-	-	-	-
Stage 2	-	-	-	-
Critical Hdwy	4.1	-	-	4.1
Critical Hdwy Stg 1	-	-	-	-
Critical Hdwy Stg 2	-	-	-	-
Follow-up Hdwy	2.2	-	-	2.2
Pot Cap-1 Maneuver	1370	-	-	611
Stage 1	-	-	-	-
Stage 2	-	-	-	-
Platoon blocked, %	-	-	-	-
Mov Cap-1 Maneuver	1370	-	-	611
Mov Cap-2 Maneuver	-	-	-	-
Stage 1	-	-	-	-
Stage 2	-	-	-	-

Approach	EB	WB	NB	SB
HCM Control Delay, s/v	0.02	0	0	34
HCM LOS			A	D

Minor Lane/Major Mvmt	NBLn1	EBL	EBT	EBR	WBL	WBT	WBR	SBLn1
Capacity (veh/h)	-	1370	-	-	611	-	-	157
HCM Lane V/C Ratio	-	0.002	-	-	-	-	-	0.211
HCM Control Delay (s/veh)	0	7.6	-	-	0	-	-	34
HCM Lane LOS	A	A	-	-	A	-	-	D
HCM 95th %tile Q(veh)	-	0	-	-	0	-	-	0.8

HCM 7th TWSC
 2: Newport Boulevard/Access Drive 2 & GA-30

05/14/2025

Intersection												
Int Delay, s/veh	5.1											
Movement	EBL	EBT	EBR	WBL	WBT	WBR	NBL	NBT	NBR	SBL	SBT	SBR
Lane Configurations	↖	↑	↗	↖	↑	↗		↖	↗		↕	
Traffic Vol, veh/h	7	1127	12	36	199	5	16	0	123	15	0	7
Future Vol, veh/h	7	1127	12	36	199	5	16	0	123	15	0	7
Conflicting Peds, #/hr	0	0	0	0	0	0	0	0	0	0	0	0
Sign Control	Free	Free	Free	Free	Free	Free	Stop	Stop	Stop	Stop	Stop	Stop
RT Channelized	-	-	Free	-	-	Yield	-	-	Yield	-	-	None
Storage Length	310	-	300	300	-	250	-	-	100	-	-	-
Veh in Median Storage, #	-	0	-	-	0	-	-	0	-	-	0	-
Grade, %	-	0	-	-	0	-	-	0	-	-	0	-
Peak Hour Factor	96	96	96	96	96	96	96	96	96	96	96	96
Heavy Vehicles, %	0	2	0	6	8	0	6	0	2	0	0	0
Mvmt Flow	7	1174	13	38	207	5	17	0	128	16	0	7

Major/Minor	Major1	Major2	Minor1	Minor2
Conflicting Flow All	207	0	1174	0
Stage 1	-	-	-	-
Stage 2	-	-	-	-
Critical Hdwy	4.1	-	4.16	-
Critical Hdwy Stg 1	-	-	-	-
Critical Hdwy Stg 2	-	-	-	-
Follow-up Hdwy	2.2	-	2.254	-
Pot Cap-1 Maneuver	1376	-	581	-
Stage 1	-	-	-	-
Stage 2	-	-	-	-
Platoon blocked, %	-	-	-	-
Mov Cap-1 Maneuver	1376	-	581	-
Mov Cap-2 Maneuver	-	-	-	-
Stage 1	-	-	-	-
Stage 2	-	-	-	-

Approach	EB	WB	NB	SB
HCM Control Delay, s/v	0.05	1.74	39.17	89.96
HCM LOS			E	F

Minor Lane/Major Mvmt	NBLn1	NBLn2	EBL	EBT	WBL	WBT	WBR	SBLn1
Capacity (veh/h)	95	234	1376	-	581	-	-	64
HCM Lane V/C Ratio	0.175	0.548	0.005	-	0.065	-	-	0.359
HCM Control Delay (s/veh)	50.8	37.7	7.6	-	11.6	-	-	90
HCM Lane LOS	F	E	A	-	B	-	-	F
HCM 95th %tile Q(veh)	0.6	3	0	-	0.2	-	-	1.3

HCM 7th TWSC

1: Stop-N-Stor Driveway/Access Drive 1 & GA-30

05/14/2025

Intersection												
Int Delay, s/veh	0.6											
Movement	EBL	EBT	EBR	WBL	WBT	WBR	NBL	NBT	NBR	SBL	SBT	SBR
Lane Configurations	↖	↗		↖	↗	↖		↕			↕	
Traffic Vol, veh/h	8	457	3	1	540	21	5	0	2	14	0	5
Future Vol, veh/h	8	457	3	1	540	21	5	0	2	14	0	5
Conflicting Peds, #/hr	0	0	0	0	0	0	0	0	0	0	0	0
Sign Control	Free	Free	Free	Free	Free	Free	Stop	Stop	Stop	Stop	Stop	Stop
RT Channelized	-	-	None	-	-	Yield	-	-	None	-	-	None
Storage Length	310	-	-	310	-	250	-	-	-	-	-	-
Veh in Median Storage, #	-	0	-	-	0	-	-	0	-	-	0	-
Grade, %	-	0	-	-	0	-	-	0	-	-	0	-
Peak Hour Factor	97	97	97	97	97	97	97	97	97	97	97	97
Heavy Vehicles, %	0	2	0	0	1	0	20	0	0	0	0	0
Mvmt Flow	8	471	3	1	557	22	5	0	2	14	0	5

Major/Minor	Major1			Major2			Minor1			Minor2		
Conflicting Flow All	557	0	0	474	0	0	1048	1048	473	1046	1049	557
Stage 1	-	-	-	-	-	-	489	489	-	559	559	-
Stage 2	-	-	-	-	-	-	559	559	-	488	491	-
Critical Hdwy	4.1	-	-	4.1	-	-	7.3	6.5	6.2	7.1	6.5	6.2
Critical Hdwy Stg 1	-	-	-	-	-	-	6.3	5.5	-	6.1	5.5	-
Critical Hdwy Stg 2	-	-	-	-	-	-	6.3	5.5	-	6.1	5.5	-
Follow-up Hdwy	2.2	-	-	2.2	-	-	3.68	4	3.3	3.5	4	3.3
Pot Cap-1 Maneuver	1024	-	-	1098	-	-	190	230	596	208	229	534
Stage 1	-	-	-	-	-	-	528	553	-	517	514	-
Stage 2	-	-	-	-	-	-	483	514	-	565	552	-
Platoon blocked, %	-	-	-	-	-	-	-	-	-	-	-	-
Mov Cap-1 Maneuver	1024	-	-	1098	-	-	187	228	596	206	227	534
Mov Cap-2 Maneuver	-	-	-	-	-	-	187	228	-	206	227	-
Stage 1	-	-	-	-	-	-	524	548	-	517	514	-
Stage 2	-	-	-	-	-	-	478	514	-	559	547	-

Approach	EB	WB	NB	SB
HCM Control Delay, s/v	0.15	0.01	20.98	20.95
HCM LOS			C	C

Minor Lane/Major Mvmt	NBLn1	EBL	EBT	EBR	WBL	WBT	WBR	SBLn1
Capacity (veh/h)	232	1024	-	-	1098	-	-	245
HCM Lane V/C Ratio	0.031	0.008	-	-	0.001	-	-	0.08
HCM Control Delay (s/veh)	21	8.5	-	-	8.3	-	-	21
HCM Lane LOS	C	A	-	-	A	-	-	C
HCM 95th %tile Q(veh)	0.1	0	-	-	0	-	-	0.3

Intersection												
Int Delay, s/veh	3											
Movement	EBL	EBT	EBR	WBL	WBT	WBR	NBL	NBT	NBR	SBL	SBT	SBR
Lane Configurations	↖	↑	↗	↖	↑	↗		↖	↗		↕	
Traffic Vol, veh/h	7	429	48	97	506	13	28	0	67	14	0	6
Future Vol, veh/h	7	429	48	97	506	13	28	0	67	14	0	6
Conflicting Peds, #/hr	0	0	0	0	0	0	0	0	0	0	0	0
Sign Control	Free	Free	Free	Free	Free	Free	Stop	Stop	Stop	Stop	Stop	Stop
RT Channelized	-	-	Free	-	-	Yield	-	-	Yield	-	-	None
Storage Length	310	-	300	300	-	250	-	-	100	-	-	-
Veh in Median Storage, #	-	0	-	-	0	-	-	0	-	-	0	-
Grade, %	-	0	-	-	0	-	-	0	-	-	0	-
Peak Hour Factor	91	91	91	91	91	91	91	91	91	91	91	91
Heavy Vehicles, %	0	2	0	0	2	0	0	0	2	0	0	0
Mvmt Flow	8	471	53	107	556	14	31	0	74	15	0	7

Major/Minor	Major1	Major2	Minor1	Minor2
Conflicting Flow All	556	0	471	0
Stage 1	-	-	-	-
Stage 2	-	-	-	-
Critical Hdwy	4.1	-	4.1	-
Critical Hdwy Stg 1	-	-	-	-
Critical Hdwy Stg 2	-	-	-	-
Follow-up Hdwy	2.2	-	2.2	-
Pot Cap-1 Maneuver	1025	0	1101	-
Stage 1	-	0	-	-
Stage 2	-	0	-	-
Platoon blocked, %	-	-	-	-
Mov Cap-1 Maneuver	1025	-	1101	-
Mov Cap-2 Maneuver	-	-	-	-
Stage 1	-	-	-	-
Stage 2	-	-	-	-

Approach	EB	WB	NB	SB
HCM Control Delay, s/v 0.14		1.36	20.27	32.37
HCM LOS			C	D

Minor Lane/Major Mvmt	NBLn1	NBLn2	EBL	EBT	WBL	WBT	WBR	SBLn1
Capacity (veh/h)	132	592	1025	-	1101	-	-	153
HCM Lane V/C Ratio	0.232	0.124	0.008	-	0.097	-	-	0.143
HCM Control Delay (s/veh)	40.2	11.9	8.5	-	8.6	-	-	32.4
HCM Lane LOS	E	B	A	-	A	-	-	D
HCM 95th %tile Q(veh)	0.9	0.4	0	-	0.3	-	-	0.5

Intersection												
Int Delay, s/veh	1.3											
Movement	EBL	EBT	EBR	WBL	WBT	WBR	NBL	NBT	NBR	SBL	SBT	SBR
Lane Configurations	↖	↗		↖	↗	↖		↕			↕	
Traffic Vol, veh/h	5	1124	0	0	209	22	0	0	0	34	0	12
Future Vol, veh/h	5	1124	0	0	209	22	0	0	0	34	0	12
Conflicting Peds, #/hr	0	0	0	0	0	0	0	0	0	0	0	0
Sign Control	Free	Free	Free	Free	Free	Free	Stop	Stop	Stop	Stop	Stop	Stop
RT Channelized	-	-	None	-	-	Yield	-	-	None	-	-	None
Storage Length	310	-	-	310	-	250	-	-	-	-	-	-
Veh in Median Storage, #	-	0	-	-	0	-	-	0	-	-	0	-
Grade, %	-	0	-	-	0	-	-	0	-	-	0	-
Peak Hour Factor	97	97	97	97	97	97	97	97	97	97	97	97
Heavy Vehicles, %	0	2	0	0	8	0	0	0	0	0	0	0
Mvmt Flow	5	1159	0	0	215	23	0	0	0	35	0	12

Major/Minor	Major1		Major2		Minor1		Minor2					
Conflicting Flow All	215	0	0	1159	0	0	1385	1385	1159	1385	1385	215
Stage 1	-	-	-	-	-	-	1169	1169	-	215	215	-
Stage 2	-	-	-	-	-	-	215	215	-	1169	1169	-
Critical Hdwy	4.1	-	-	4.1	-	-	7.1	6.5	6.2	7.1	6.5	6.2
Critical Hdwy Stg 1	-	-	-	-	-	-	6.1	5.5	-	6.1	5.5	-
Critical Hdwy Stg 2	-	-	-	-	-	-	6.1	5.5	-	6.1	5.5	-
Follow-up Hdwy	2.2	-	-	2.2	-	-	3.5	4	3.3	3.5	4	3.3
Pot Cap-1 Maneuver	1366	-	-	610	-	-	122	145	241	122	145	829
Stage 1	-	-	-	-	-	-	237	269	-	791	728	-
Stage 2	-	-	-	-	-	-	791	728	-	237	269	-
Platoon blocked, %	-	-	-	-	-	-	-	-	-	-	-	-
Mov Cap-1 Maneuver	1366	-	-	610	-	-	120	144	241	122	144	829
Mov Cap-2 Maneuver	-	-	-	-	-	-	120	144	-	122	144	-
Stage 1	-	-	-	-	-	-	237	268	-	791	728	-
Stage 2	-	-	-	-	-	-	780	728	-	237	268	-

Approach	EB	WB	NB	SB
HCM Control Delay, s/v 0.03		0	0	37.75
HCM LOS			A	E

Minor Lane/Major Mvmt	NBLn1	EBL	EBT	EBR	WBL	WBT	WBR	SBLn1
Capacity (veh/h)	-	1366	-	-	610	-	-	156
HCM Lane V/C Ratio	-	0.004	-	-	-	-	-	0.303
HCM Control Delay (s/veh)	0	7.6	-	-	0	-	-	37.8
HCM Lane LOS	A	A	-	-	A	-	-	E
HCM 95th %tile Q(veh)	-	0	-	-	0	-	-	1.2

Intersection												
Int Delay, s/veh	6.2											
Movement	EBL	EBT	EBR	WBL	WBT	WBR	NBL	NBT	NBR	SBL	SBT	SBR
Lane Configurations	↘	↗	↘	↘	↗	↘		↗	↘		↔	
Traffic Vol, veh/h	8	1137	12	36	202	7	16	0	123	21	0	11
Future Vol, veh/h	8	1137	12	36	202	7	16	0	123	21	0	11
Conflicting Peds, #/hr	0	0	0	0	0	0	0	0	0	0	0	0
Sign Control	Free	Free	Free	Free	Free	Free	Stop	Stop	Stop	Stop	Stop	Stop
RT Channelized	-	-	Free	-	-	Yield	-	-	Yield	-	-	None
Storage Length	310	-	300	300	-	250	-	-	100	-	-	-
Veh in Median Storage, #	-	0	-	-	0	-	-	0	-	-	0	-
Grade, %	-	0	-	-	0	-	-	0	-	-	0	-
Peak Hour Factor	96	96	96	96	96	96	96	96	96	96	96	96
Heavy Vehicles, %	0	2	0	6	8	0	6	0	2	0	0	0
Mvmt Flow	8	1184	13	38	210	7	17	0	128	22	0	11

Major/Minor	Major1		Major2			Minor1			Minor2			
Conflicting Flow All	210	0	-	1184	0	0	1486	1486	1184	1486	1486	210
Stage 1	-	-	-	-	-	-	1201	1201	-	285	285	-
Stage 2	-	-	-	-	-	-	285	285	-	1201	1201	-
Critical Hdwy	4.1	-	-	4.16	-	-	7.16	6.5	6.22	7.1	6.5	6.2
Critical Hdwy Stg 1	-	-	-	-	-	-	6.16	5.5	-	6.1	5.5	-
Critical Hdwy Stg 2	-	-	-	-	-	-	6.16	5.5	-	6.1	5.5	-
Follow-up Hdwy	2.2	-	-	2.254	-	-	3.554	4	3.318	3.5	4	3.3
Pot Cap-1 Maneuver	1372	-	0	576	-	-	100	126	230	104	126	835
Stage 1	-	-	0	-	-	-	222	260	-	726	679	-
Stage 2	-	-	0	-	-	-	713	679	-	228	260	-
Platoon blocked, %	-	-	-	-	-	-	-	-	-	-	-	-
Mov Cap-1 Maneuver	1372	-	-	576	-	-	92	117	230	43	117	835
Mov Cap-2 Maneuver	-	-	-	-	-	-	92	117	-	43	117	-
Stage 1	-	-	-	-	-	-	220	259	-	679	635	-
Stage 2	-	-	-	-	-	-	658	635	-	100	259	-

Approach	EB	WB	NB	SB
HCM Control Delay, s/v	0.05	1.72	40.2	112.49
HCM LOS			E	F

Minor Lane/Major Mvmt	NBLn1	NBLn2	EBL	EBT	WBL	WBT	WBR	SBLn1
Capacity (veh/h)	92	230	1372	-	576	-	-	63
HCM Lane V/C Ratio	0.181	0.556	0.006	-	0.065	-	-	0.525
HCM Control Delay (s/veh)	52.6	38.6	7.6	-	11.7	-	-	112.5
HCM Lane LOS	F	E	A	-	B	-	-	F
HCM 95th %tile Q(veh)	0.6	3	0	-	0.2	-	-	2.1

Intersection												
Int Delay, s/veh	0.8											
Movement	EBL	EBT	EBR	WBL	WBT	WBR	NBL	NBT	NBR	SBL	SBT	SBR
Lane Configurations	↖	↗		↖	↗	↖		↕			↕	
Traffic Vol, veh/h	11	461	3	1	542	31	5	0	2	21	0	7
Future Vol, veh/h	11	461	3	1	542	31	5	0	2	21	0	7
Conflicting Peds, #/hr	0	0	0	0	0	0	0	0	0	0	0	0
Sign Control	Free	Free	Free	Free	Free	Free	Stop	Stop	Stop	Stop	Stop	Stop
RT Channelized	-	-	None	-	-	Yield	-	-	None	-	-	None
Storage Length	310	-	-	310	-	250	-	-	-	-	-	-
Veh in Median Storage, #	-	0	-	-	0	-	-	0	-	-	0	-
Grade, %	-	0	-	-	0	-	-	0	-	-	0	-
Peak Hour Factor	97	97	97	97	97	97	97	97	97	97	97	97
Heavy Vehicles, %	0	2	0	0	1	0	20	0	0	0	0	0
Mvmt Flow	11	475	3	1	559	32	5	0	2	22	0	7

Major/Minor	Major1			Major2			Minor1			Minor2		
Conflicting Flow All	559	0	0	478	0	0	1060	1060	477	1059	1062	559
Stage 1	-	-	-	-	-	-	499	499	-	561	561	-
Stage 2	-	-	-	-	-	-	561	561	-	498	501	-
Critical Hdwy	4.1	-	-	4.1	-	-	7.3	6.5	6.2	7.1	6.5	6.2
Critical Hdwy Stg 1	-	-	-	-	-	-	6.3	5.5	-	6.1	5.5	-
Critical Hdwy Stg 2	-	-	-	-	-	-	6.3	5.5	-	6.1	5.5	-
Follow-up Hdwy	2.2	-	-	2.2	-	-	3.68	4	3.3	3.5	4	3.3
Pot Cap-1 Maneuver	1022	-	-	1094	-	-	187	226	592	204	225	533
Stage 1	-	-	-	-	-	-	521	547	-	516	513	-
Stage 2	-	-	-	-	-	-	482	513	-	558	546	-
Platoon blocked, %	-	-	-	-	-	-	-	-	-	-	-	-
Mov Cap-1 Maneuver	1022	-	-	1094	-	-	182	223	592	201	223	533
Mov Cap-2 Maneuver	-	-	-	-	-	-	182	223	-	201	223	-
Stage 1	-	-	-	-	-	-	515	541	-	515	513	-
Stage 2	-	-	-	-	-	-	475	513	-	550	540	-

Approach	EB	WB	NB	SB
HCM Control Delay, s/v	0.2	0.01	21.39	22.2
HCM LOS			C	C

Minor Lane/Major Mvmt	NBLn1	EBL	EBT	EBR	WBL	WBT	WBR	SBLn1
Capacity (veh/h)	227	1022	-	-	1094	-	-	238
HCM Lane V/C Ratio	0.032	0.011	-	-	0.001	-	-	0.121
HCM Control Delay (s/veh)	21.4	8.6	-	-	8.3	-	-	22.2
HCM Lane LOS	C	A	-	-	A	-	-	C
HCM 95th %tile Q(veh)	0.1	0	-	-	0	-	-	0.4

Intersection												
Int Delay, s/veh	3.2											
Movement	EBL	EBT	EBR	WBL	WBT	WBR	NBL	NBT	NBR	SBL	SBT	SBR
Lane Configurations	↖	↑	↗	↖	↑	↗		↖	↗		↕	
Traffic Vol, veh/h	10	436	48	97	515	19	28	0	67	18	0	8
Future Vol, veh/h	10	436	48	97	515	19	28	0	67	18	0	8
Conflicting Peds, #/hr	0	0	0	0	0	0	0	0	0	0	0	0
Sign Control	Free	Free	Free	Free	Free	Free	Stop	Stop	Stop	Stop	Stop	Stop
RT Channelized	-	-	Free	-	-	Yield	-	-	Yield	-	-	None
Storage Length	310	-	300	300	-	250	-	-	100	-	-	-
Veh in Median Storage, #	-	0	-	-	0	-	-	0	-	-	0	-
Grade, %	-	0	-	-	0	-	-	0	-	-	0	-
Peak Hour Factor	91	91	91	91	91	91	91	91	91	91	91	91
Heavy Vehicles, %	0	2	0	0	2	0	0	0	2	0	0	0
Mvmt Flow	11	479	53	107	566	21	31	0	74	20	0	9

Major/Minor	Major1	Major2	Minor1	Minor2
Conflicting Flow All	566	0	479	0
Stage 1	-	-	-	-
Stage 2	-	-	-	-
Critical Hdwy	4.1	-	4.1	-
Critical Hdwy Stg 1	-	-	-	-
Critical Hdwy Stg 2	-	-	-	-
Follow-up Hdwy	2.2	-	2.2	-
Pot Cap-1 Maneuver	1016	0	1094	-
Stage 1	-	0	-	-
Stage 2	-	0	-	-
Platoon blocked, %	-	-	-	-
Mov Cap-1 Maneuver	1016	-	1094	-
Mov Cap-2 Maneuver	-	-	-	-
Stage 1	-	-	-	-
Stage 2	-	-	-	-

Approach	EB	WB	NB	SB
HCM Control Delay, s/v	0.19	1.33	20.98	34.97
HCM LOS			C	D

Minor Lane/Major Mvmt	NBLn1	NBLn2	EBL	EBT	WBL	WBT	WBR	SBLn1
Capacity (veh/h)	126	587	1016	-	1094	-	-	148
HCM Lane V/C Ratio	0.243	0.126	0.011	-	0.097	-	-	0.193
HCM Control Delay (s/veh)	42.4	12	8.6	-	8.6	-	-	35
HCM Lane LOS	E	B	A	-	A	-	-	D
HCM 95th %tile Q(veh)	0.9	0.4	0	-	0.3	-	-	0.7

SHORT COUNTS

Traffic Data Specialists

735 Maryland St
Columbia, SC 29201

We Can't say we're the Best, but you Can!

File Name : GA 30 @ Stop N Stor (Storage)
Site Code :
Start Date : 04/09/2025
Page No : 1

Groups Printed- Passenger Vehicles - Heavy Vehicles - Buses

Start Time	Construction Area Southbound				GA 30 Westbound				Stop N Stor (Storage) Northbound				GA 30 Eastbound				Int. Total
	Left	Thru	Right	Peds	Left	Thru	Right	Peds	Left	Thru	Right	Peds	Left	Thru	Right	Peds	
07:00	0	0	0	0	0	47	4	0	0	0	0	0	0	288	0	0	339
07:15	1	0	0	0	0	38	3	0	0	0	0	0	0	298	0	0	340
07:30	1	0	0	0	0	54	2	0	0	0	0	0	0	264	0	0	321
07:45	0	0	1	0	0	56	2	0	0	0	0	0	1	252	0	0	312
Total	2	0	1	0	0	195	11	0	0	0	0	0	1	1102	0	0	1312
08:00	0	0	0	1	0	56	0	0	0	0	0	0	0	220	0	0	277
08:15	0	0	0	1	2	45	0	0	0	0	0	0	0	203	0	0	251
08:30	0	0	0	0	1	44	2	0	1	0	0	0	1	192	0	0	241
08:45	0	0	0	0	0	61	0	0	0	0	1	0	0	147	0	0	209
Total	0	0	0	2	3	206	2	0	1	0	1	0	1	762	0	0	978
16:00	2	0	2	0	0	139	0	0	0	0	1	0	1	89	0	0	234
16:15	1	0	2	0	0	127	0	0	0	0	0	0	0	109	0	0	239
16:30	0	0	0	0	0	139	0	0	0	0	0	0	0	105	0	0	244
16:45	2	0	0	0	1	100	2	0	0	0	1	0	0	107	0	0	213
Total	5	0	4	0	1	505	2	0	0	0	2	0	1	410	0	0	930
17:00	0	0	0	0	1	127	1	0	4	0	0	0	0	117	1	0	251
17:15	0	0	0	0	0	129	0	0	0	0	2	0	0	121	1	0	253
17:30	0	0	0	0	0	123	0	0	1	0	0	0	1	98	1	0	224
17:45	0	0	0	0	0	147	0	0	0	0	0	0	0	107	0	0	254
Total	0	0	0	0	1	526	1	0	5	0	2	0	1	443	3	0	982
Grand Total	7	0	5	2	5	1432	16	0	6	0	5	0	4	2717	3	0	4202
Apprch %	50	0	35.7	14.3	0.3	98.6	1.1	0	54.5	0	45.5	0	0.1	99.7	0.1	0	
Total %	0.2	0	0.1	0	0.1	34.1	0.4	0	0.1	0	0.1	0	0.1	64.7	0.1	0	
Passenger Vehicles	7	0	4	2	5	1366	14	0	5	0	5	0	4	2650	3	0	4065
% Passenger Vehicles	100	0	80	100	100	95.4	87.5	0	83.3	0	100	0	100	97.5	100	0	96.7
Heavy Vehicles	0	0	1	0	0	55	2	0	1	0	0	0	0	53	0	0	112
% Heavy Vehicles	0	0	20	0	0	3.8	12.5	0	16.7	0	0	0	0	2	0	0	2.7
Buses	0	0	0	0	0	11	0	0	0	0	0	0	0	14	0	0	25
% Buses	0	0	0	0	0	0.8	0	0	0	0	0	0	0	0.5	0	0	0.6

SHORT COUNTS

Traffic Data Specialists

735 Maryland St
 Columbia, SC 29201
 We Can't say we're the Best, but you Can!

File Name : GA 30 @ Stop N Stor (Storage)
 Site Code :
 Start Date : 04/09/2025
 Page No : 2

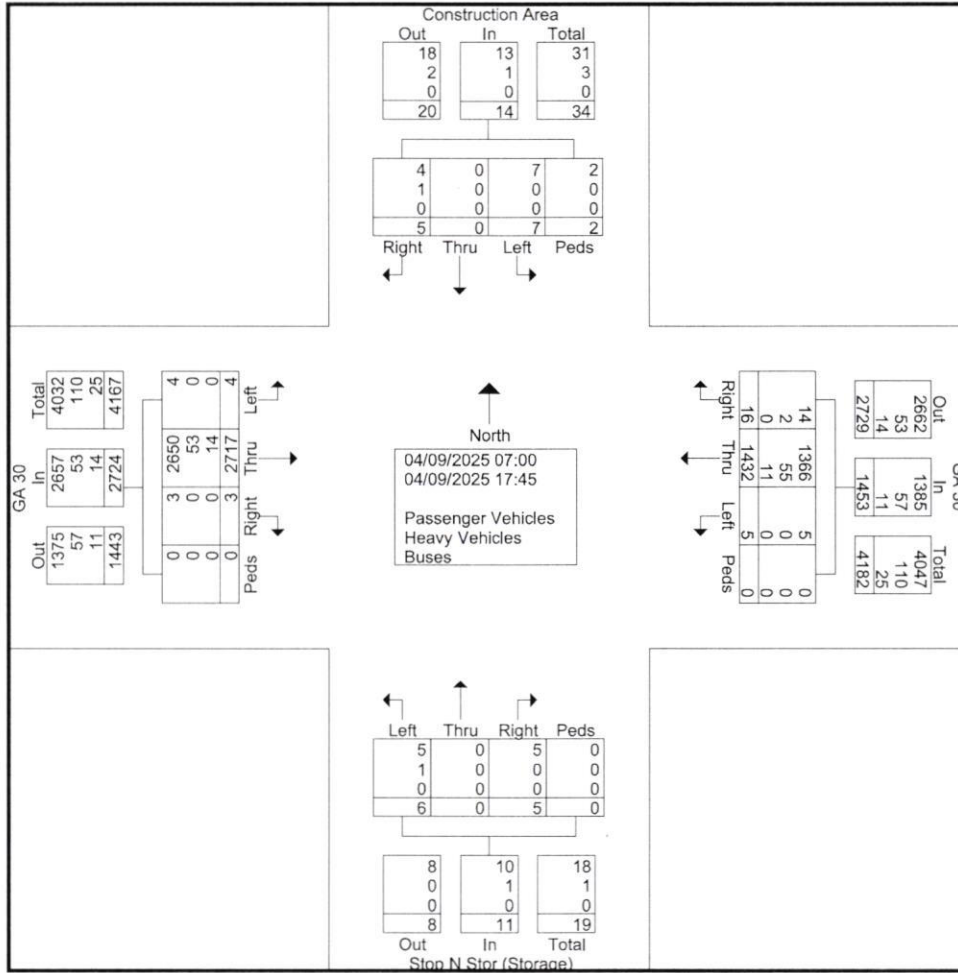

SHORT COUNTS

Traffic Data Specialists

735 Maryland St
Columbia, SC 29201

We Can't say we're the Best, but you Can!

File Name : GA 30 @ Stop N Stor (Storage)
Site Code :
Start Date : 04/09/2025
Page No : 3

Start Time	Construction Area Southbound					GA 30 Westbound					Stop N Stor (Storage) Northbound					GA 30 Eastbound					Int. Total
	Left	Thru	Right	Peds	App. Total	Left	Thru	Right	Peds	App. Total	Left	Thru	Right	Peds	App. Total	Left	Thru	Right	Peds	App. Total	
Peak Hour Analysis From 07:00 to 08:45 - Peak 1 of 1																					
Peak Hour for Entire Intersection Begins at 07:00																					
07:00	0	0	0	0	0	0	47	4	0	51	0	0	0	0	0	0	288	0	0	288	339
07:15	1	0	0	0	1	0	38	3	0	41	0	0	0	0	0	0	298	0	0	298	340
07:30	1	0	0	0	1	0	54	2	0	56	0	0	0	0	0	0	264	0	0	264	321
07:45	0	0	1	0	1	0	56	2	0	58	0	0	0	0	0	1	252	0	0	253	312
Total Volume	2	0	1	0	3	0	195	11	0	206	0	0	0	0	0	1	1102	0	0	1103	1312
% App. Total	66.7	0	33.3	0		0	94.7	5.3	0		0	0	0	0	0	0.1	99.9	0	0		
PHF	.500	.000	.250	.000	.750	.000	.871	.688	.000	.888	.000	.000	.000	.000	.000	.250	.924	.000	.000	.925	.965
Passenger Vehicles	2	0	1	0	3	0	179	10	0	189	0	0	0	0	0	1	1078	0	0		
% Passenger Vehicles	100	0	100	0	100	0	91.8	90.9	0	91.7	0	0	0	0	0	100	97.8	0	0	97.8	96.9
Heavy Vehicles	0	0	0	0	0	0	15	1	0	16	0	0	0	0	0	0	22	0	0	22	38
% Heavy Vehicles	0	0	0	0	0	0	7.7	9.1	0	7.8	0	0	0	0	0	0	2.0	0	0	2.0	2.9
Buses	0	0	0	0	0	0	1	0	0	1	0	0	0	0	0	0	2	0	0	2	3
% Buses	0	0	0	0	0	0	0.5	0	0	0.5	0	0	0	0	0	0	0.2	0	0	0.2	0.2

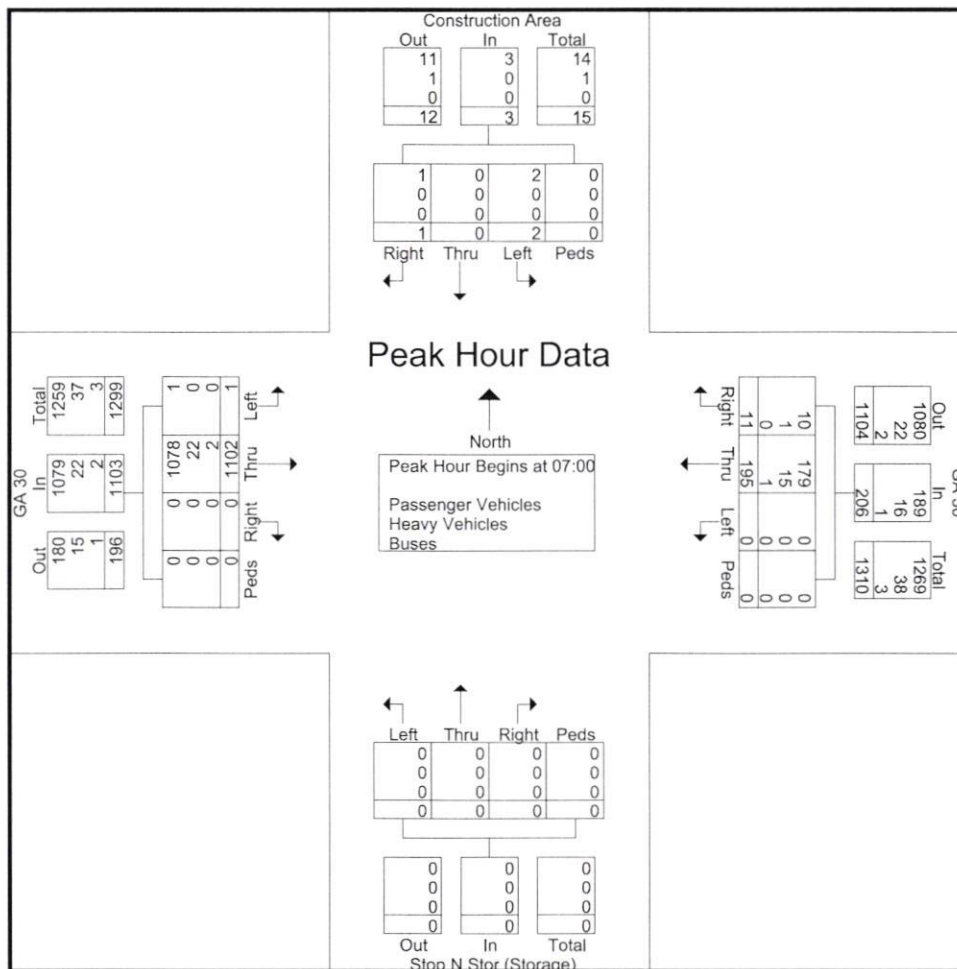

SHORT COUNTS

Traffic Data Specialists

735 Maryland St
Columbia, SC 29201
We Can't say we're the Best, but you Can!

File Name : GA 30 @ Stop N Stor (Storage)
Site Code :
Start Date : 04/09/2025
Page No : 4

Start Time	Construction Area Southbound					GA 30 Westbound					Stop N Stor (Storage) Northbound					GA 30 Eastbound					Int. Total
	Left	Thru	Right	Peds	App. Total	Left	Thru	Right	Peds	App. Total	Left	Thru	Right	Peds	App. Total	Left	Thru	Right	Peds	App. Total	
Peak Hour Analysis From 16:00 to 17:45 - Peak 1 of 1																					
Peak Hour for Entire Intersection Begins at 17:00																					
17:00	0	0	0	0	0	1	127	1	0	129	4	0	0	0	4	0	117	1	0	118	251
17:15	0	0	0	0	0	0	129	0	0	129	0	0	2	0	2	0	121	1	0	122	253
17:30	0	0	0	0	0	0	123	0	0	123	1	0	0	0	1	1	98	1	0	100	224
17:45	0	0	0	0	0	0	147	0	0	147	0	0	0	0	0	0	107	0	0	107	254
Total Volume	0	0	0	0	0	1	526	1	0	528	5	0	2	0	7	1	443	3	0	447	982
% App. Total	0	0	0	0	0	0.2	99.6	0.2	0		71.4	0	28.6	0		0.2	99.1	0.7	0		
PHF	.000	.000	.000	.000	.000	.250	.895	.250	.000	.898	.313	.000	.250	.000	.438	.250	.915	.750	.000	.916	.967
Passenger Vehicles	0	0	0	0	0	1	519	1	0	521	4	0	2	0	6	1	434	3	0	438	965
% Passenger Vehicles																					
Heavy Vehicles	0	0	0	0	0	0	7	0	0	7	1	0	0	0	1	0	6	0	0	6	14
% Heavy Vehicles	0	0	0	0	0	0	1.3	0	0	1.3	20.0	0	0	0	14.3	0	1.4	0	0	1.3	1.4
Buses	0	0	0	0	0	0	0	0	0	0	0	0	0	0	0	0	3	0	0	3	3
% Buses	0	0	0	0	0	0	0	0	0	0	0	0	0	0	0	0	0.7	0	0	0.7	0.3

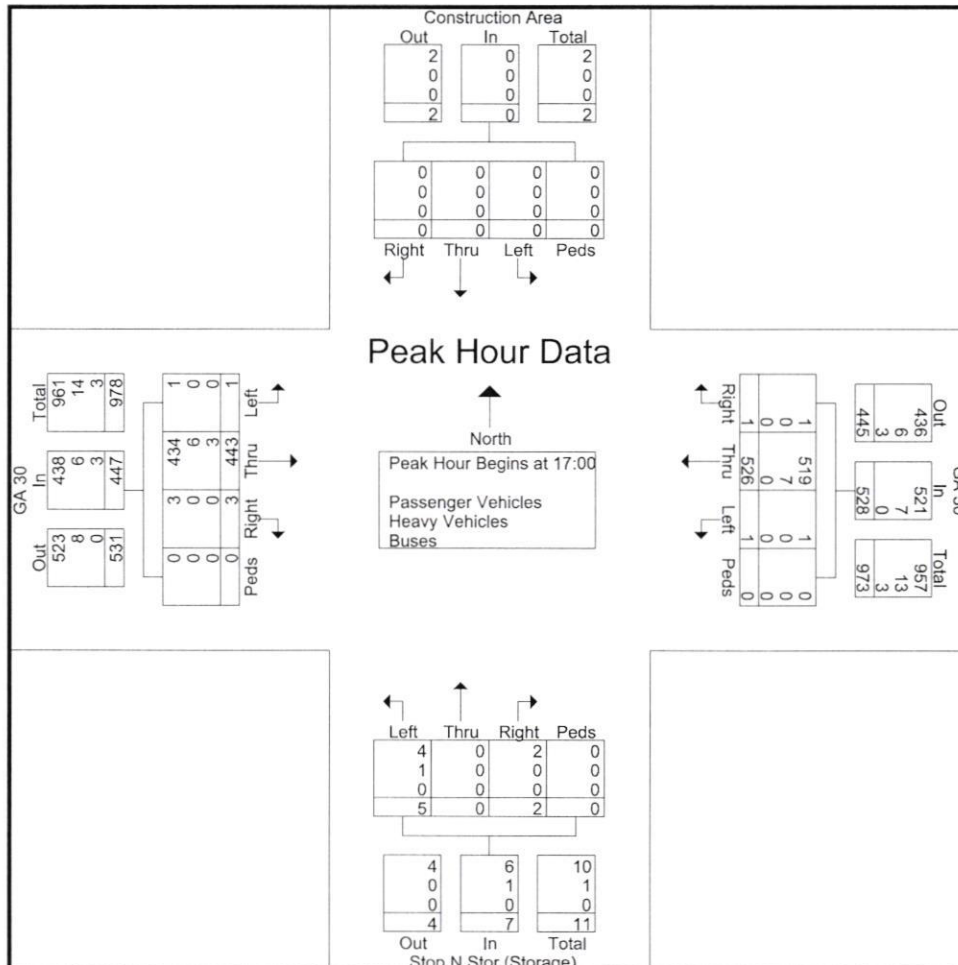

SHORT COUNTS

Traffic Data Specialists

735 Maryland St
Columbia, SC 29201
We Can't say we're the Best, but you Can!

SHORT COUNTS

Traffic Data Specialists

735 Maryland St
Columbia, SC 29201

We Can't say we're the Best, but you Can!

File Name : GA 30 @ Newport Blvd
Site Code :
Start Date : 04/09/2025
Page No : 1

Groups Printed- Passenger Vehicles - Heavy Vehicles - Buses

Start Time	New Rd Southbound				GA 30 Westbound				Newport Blvd Northbound				GA 30 Eastbound				Int. Total
	Left	Thru	Right	Peds	Left	Thru	Right	Peds	Left	Thru	Right	Peds	Left	Thru	Right	Peds	
07:00	0	0	0	0	7	44	0	0	7	0	41	0	0	277	5	0	381
07:15	1	0	0	0	5	42	0	0	1	0	29	0	0	297	3	0	378
07:30	1	0	0	0	9	52	1	0	2	0	29	0	2	273	2	0	371
07:45	1	0	0	0	14	50	0	0	6	0	22	0	2	239	2	0	336
Total	3	0	0	0	35	188	1	0	16	0	121	0	4	1086	12	0	1466
08:00	0	0	0	0	18	53	0	0	8	0	17	0	1	217	4	0	318
08:15	0	0	0	0	12	41	1	0	5	0	21	0	0	202	10	0	292
08:30	1	0	0	0	8	41	2	0	3	0	28	0	1	178	7	0	269
08:45	1	0	0	0	14	54	1	0	5	0	26	0	1	149	7	0	258
Total	2	0	0	0	52	189	4	0	21	0	92	0	3	746	28	0	1137
16:00	0	0	1	0	25	124	0	0	5	0	9	0	0	86	11	0	261
16:15	4	0	1	0	32	126	0	0	10	0	11	0	0	90	12	0	286
16:30	0	0	0	0	22	119	0	0	8	0	18	0	0	91	16	0	274
16:45	0	0	1	0	28	109	0	0	8	0	13	0	0	106	4	0	269
Total	4	0	3	0	107	478	0	0	31	0	51	0	0	373	43	0	1090
17:00	3	0	0	0	26	113	1	0	6	0	14	0	0	101	14	0	278
17:15	3	0	0	0	19	136	1	0	6	0	21	0	0	110	13	0	309
17:30	2	0	0	0	26	111	0	0	7	0	9	0	0	89	13	0	257
17:45	1	0	0	0	23	120	2	0	5	0	19	0	0	84	13	0	267
Total	9	0	0	0	94	480	4	0	24	0	63	0	0	384	53	0	1111
Grand Total	18	0	3	0	288	1335	9	0	92	0	327	0	7	2589	136	0	4804
Apprch %	85.7	0	14.3	0	17.6	81.8	0.6	0	22	0	78	0	0.3	94.8	5	0	
Total %	0.4	0	0.1	0	6	27.8	0.2	0	1.9	0	6.8	0	0.1	53.9	2.8	0	
Passenger Vehicles	18	0	3	0	277	1268	9	0	88	0	320	0	6	2519	135	0	4643
% Passenger Vehicles	100	0	100	0	96.2	95	100	0	95.7	0	97.9	0	85.7	97.3	99.3	0	96.6
Heavy Vehicles	0	0	0	0	3	59	0	0	2	0	1	0	1	58	0	0	124
% Heavy Vehicles	0	0	0	0	1	4.4	0	0	2.2	0	0.3	0	14.3	2.2	0	0	2.6
Buses	0	0	0	0	8	8	0	0	2	0	6	0	0	12	1	0	37
% Buses	0	0	0	0	2.8	0.6	0	0	2.2	0	1.8	0	0	0.5	0.7	0	0.8

SHORT COUNTS

Traffic Data Specialists

735 Maryland St
Columbia, SC 29201
We Can't say we're the Best, but you Can!

File Name : GA 30 @ Newport Blvd
Site Code :
Start Date : 04/09/2025
Page No : 2

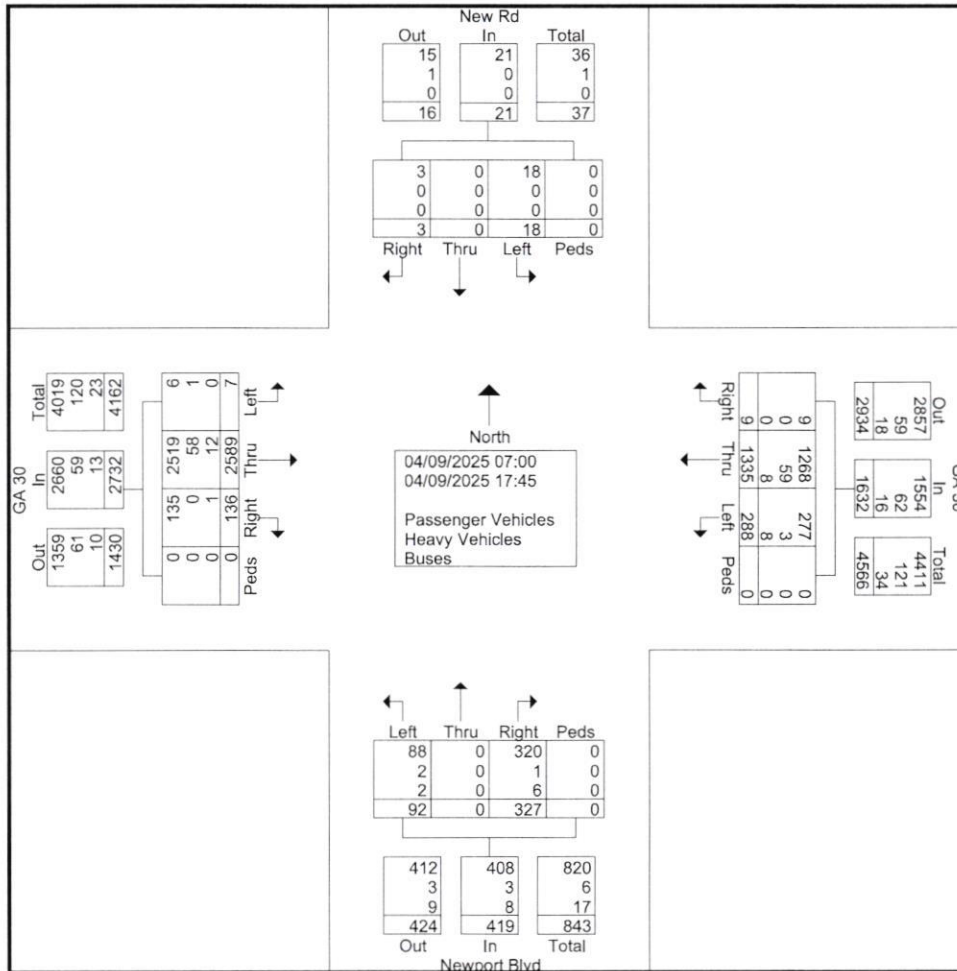

SHORT COUNTS

Traffic Data Specialists

735 Maryland St
Columbia, SC 29201
We Can't say we're the Best, but you Can!

File Name : GA 30 @ Newport Blvd
Site Code :
Start Date : 04/09/2025
Page No : 3

Start Time	New Rd Southbound					GA 30 Westbound					Newport Blvd Northbound					GA 30 Eastbound					Int. Total
	Left	Thru	Right	Peds	App. Total	Left	Thru	Right	Peds	App. Total	Left	Thru	Right	Peds	App. Total	Left	Thru	Right	Peds	App. Total	
Peak Hour Analysis From 07:00 to 08:45 - Peak 1 of 1																					
Peak Hour for Entire Intersection Begins at 07:00																					
07:00	0	0	0	0	0	7	44	0	0	51	7	0	41	0	48	0	277	5	0	282	381
07:15	1	0	0	0	1	5	42	0	0	47	1	0	29	0	30	0	297	3	0	300	378
07:30	1	0	0	0	1	9	52	1	0	62	2	0	29	0	31	2	273	2	0	277	371
07:45	1	0	0	0	1	14	50	0	0	64	6	0	22	0	28	2	239	2	0	243	336
Total Volume	3	0	0	0	3	35	188	1	0	224	16	0	121	0	137	4	1086	12	0	1102	1466
% App. Total	100	0	0	0		15.6	83.9	0.4	0		11.7	0	88.3	0		0.4	98.5	1.1	0		
PHF	.750	.000	.000	.000	.750	.625	.904	.250	.000	.875	.571	.000	.738	.000	.714	.500	.914	.600	.000	.918	.962
Passenger Vehicles	3	0	0	0	3	33	173	1	0	207	15	0	119	0	134	3	1059	100	0	97.5	96.7
% Passenger Vehicles	100	0	0	0	100	94.3	92.0	100	0	92.4	93.8	0	98.3	0	97.8	75.0	97.5	100	0	97.5	96.7
Heavy Vehicles	0	0	0	0	0	2	14	0	0	16	1	0	1	0	2	1	26	0	0	27	45
% Heavy Vehicles	0	0	0	0	0	5.7	7.4	0	0	7.1	6.3	0	0.8	0	1.5	25.0	2.4	0	0	2.5	3.1
Buses	0	0	0	0	0	0	1	0	0	1	0	0	1	0	1	0	1	0	0	1	3
% Buses	0	0	0	0	0	0	0.5	0	0	0.4	0	0	0.8	0	0.7	0	0.1	0	0	0.1	0.2

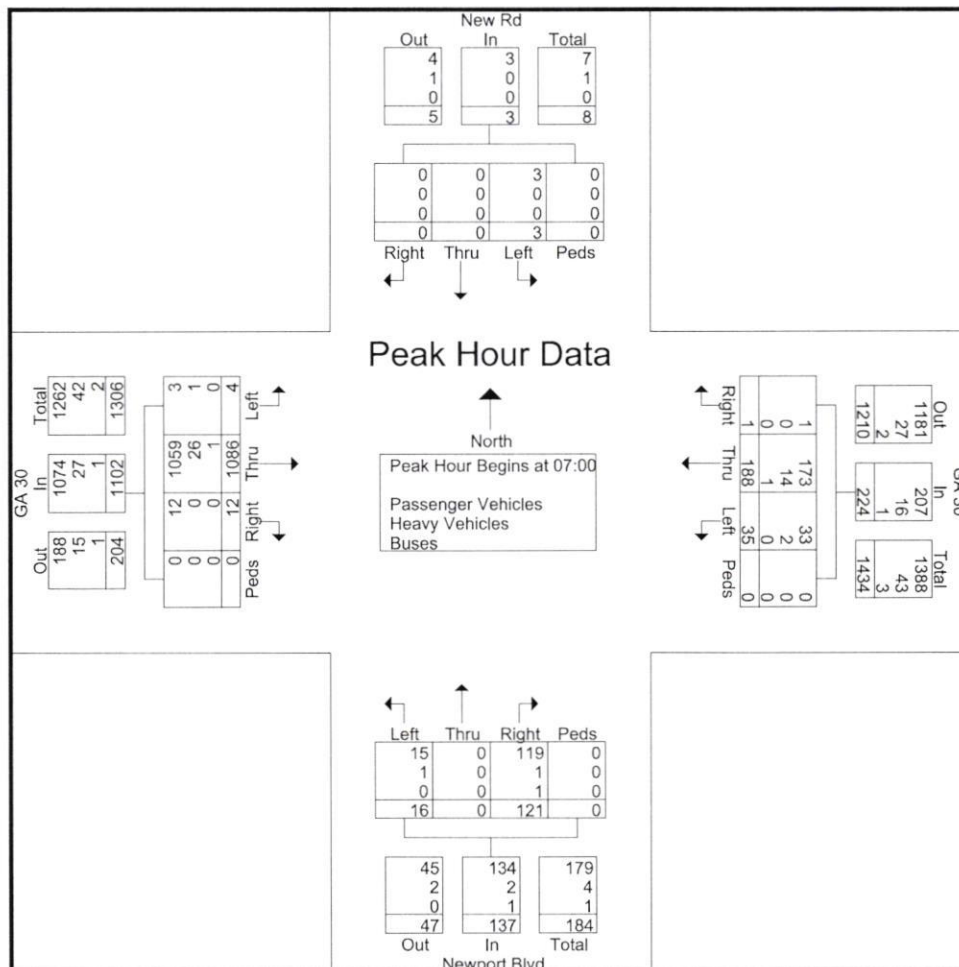

SHORT COUNTS

Traffic Data Specialists

735 Maryland St
Columbia, SC 29201
We Can't say we're the Best, but you Can!

File Name : GA 30 @ Newport Blvd
Site Code :
Start Date : 04/09/2025
Page No : 4

Start Time	New Rd Southbound					GA 30 Westbound					Newport Blvd Northbound					GA 30 Eastbound					Int. Total
	Left	Thru	Right	Peds	App. Total	Left	Thru	Right	Peds	App. Total	Left	Thru	Right	Peds	App. Total	Left	Thru	Right	Peds	App. Total	
Peak Hour Analysis From 16:00 to 17:45 - Peak 1 of 1																					
Peak Hour for Entire Intersection Begins at 16:30																					
16:30	0	0	0	0	0	22	119	0	0	141	8	0	18	0	26	0	91	16	0	107	274
16:45	0	0	1	0	1	28	109	0	0	137	8	0	13	0	21	0	106	4	0	110	269
17:00	3	0	0	0	3	26	113	1	0	140	6	0	14	0	20	0	101	14	0	115	278
17:15	3	0	0	0	3	19	136	1	0	156	6	0	21	0	27	0	110	13	0	123	309
Total Volume	6	0	1	0	7	95	477	2	0	574	28	0	66	0	94	0	408	47	0	455	1130
% App. Total	85.7	0	14.3	0		16.6	83.1	0.3	0		29.8	0	70.2	0		0	89.7	10.3	0		
PHF	.500	.000	.250	.000	.583	.848	.877	.500	.000	.920	.875	.000	.786	.000	.870	.000	.927	.734	.000	.925	.914
Passenger Vehicles	6	0	1	0	7	95	467	2	0	564	28	0	65	0	93	0	398	47	0	445	1109
% Passenger Vehicles																					
Heavy Vehicles	0	0	0	0	0	0	9	0	0	9	0	0	0	0	0	0	6	0	0	6	15
% Heavy Vehicles	0	0	0	0	0	0	1.9	0	0	1.6	0	0	0	0	0	0	1.5	0	0	1.3	1.3
Buses	0	0	0	0	0	0	1	0	0	1	0	0	1	0	1	0	4	0	0	4	6
% Buses	0	0	0	0	0	0	0.2	0	0	0.2	0	0	1.5	0	1.1	0	1.0	0	0	0.9	0.5

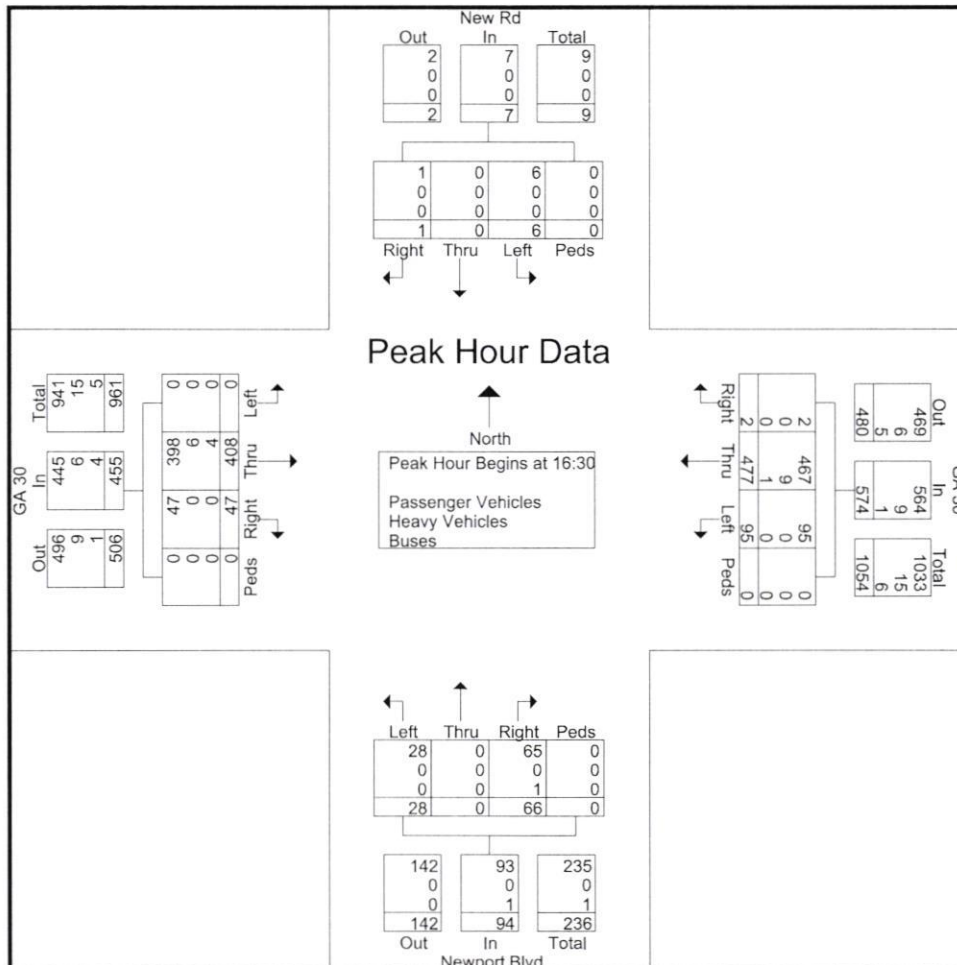

SHORT COUNTS

Traffic Data Specialists

735 Maryland St
Columbia, SC 29201
We Can't say we're the Best, but you Can!

Site Data Table

Total Units:	63 Units
2BD:	53
3BD:	10
Total Buildings:	20
Site Area Total/Usable:	22.39/10.99 acres
Parking:	95 (1.5/unit)

LEGEND

- PROPOSED SEWER MANHOLE ●
- EXISTING SEWER MANHOLE ●
- PROPOSED 8" GRAVITY SEWER —
- PROPOSED CONNECTION TO EXISTING WATER MAIN ●
- PROPOSED 8" WATER —
- PROPOSED OUTFALL ●
- PROPOSED DRAINAGE - - - - -

NOTE: THIS DESIGN IS PRELIMINARY. ARBOR VIEW - PHASE 2 GRAVITY SEWER WILL FLOW TO THE PUMP STATION LOCATED IN PHASE 1.

ALL WATER MAINS FOR ARBOR VIEW - PHASE 2 ARE PROPOSED AS 8" AND WILL TIE INTO THE EXISTING 8" WATER MAIN LOCATED IN ARBOR VIEW - PHASE 1.

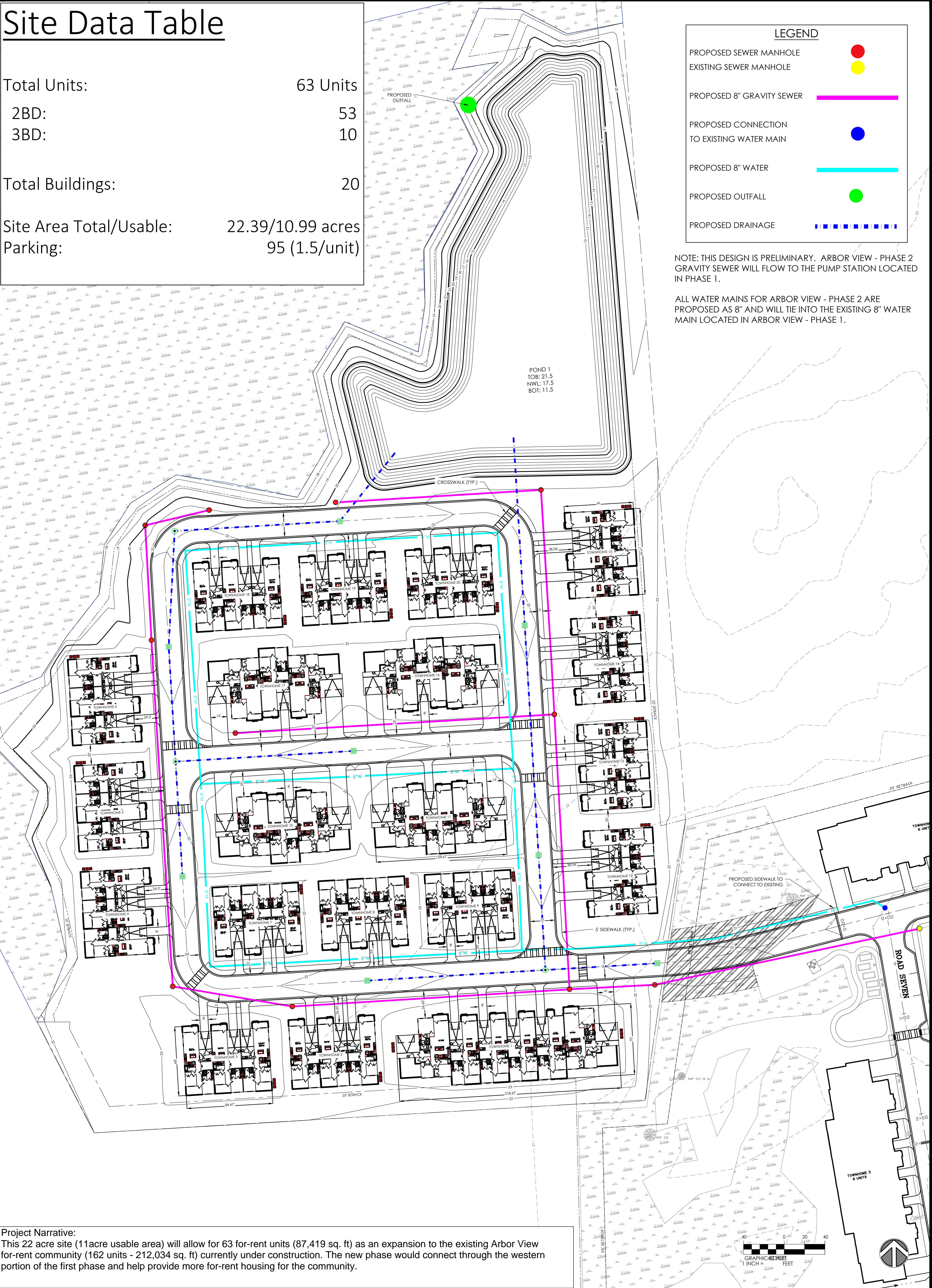

Project Narrative:
 This 22 acre site (11acre usable area) will allow for 63 for-rent units (87,419 sq. ft) as an expansion to the existing Arbor View for-rent community (162 units - 212,034 sq. ft) currently under construction. The new phase would connect through the western portion of the first phase and help provide more for-rent housing for the community.



THE MERIDIAN GROUP

MASTER CONCEPT PLAN ARBOR VIEW PHASE 2 PORT WENTWORTH, GEORGIA

June 24, 2025



This map illustrates a general plan of the development which is for discussion purposes only, does not limit or bind the owner/developer, and is subject to change and revision without prior written notice to the holder. Dimensions, boundaries and position locations are for illustrative purposes only and are subject to an accurate survey and property description.

COPYRIGHT © 2020 THOMAS & HUTTON

Arbor View Expansion
 Concept Plan Submission – May 2025
 Façade Elevation
 Façade Material: fiber cement lap siding or vinyl lap siding





City Council
7224 GA Highway 21
Port Wentworth, GA 31407

Meeting: 08/21/25
Department: Administration
Category: Agreement
Prepared By: Zahnay Smoak
Department Head:

SCHEDULED

AGENDA ITEM (ID)

DOC ID:

Engineering Services for the expansion of the Wastewater Treatment Plant

Issue/Item: Engineering services for the expansion of the Wastewater Treatment Plant.

Background:

The current WWTP was designed to handle a maximum flow of 2 MGD (million gallons per day), which is approaching 68% of capacity due to increasing population and commercial development.

Facts and Finding: The existing Wastewater Treatment Plant (WWTP) was originally designed to accommodate a maximum flow capacity of 2 million gallons per day (MGD). Due to increasing demand and projected future growth, there is a need to expand the capacity to ensure it continues to meet current and anticipated service requirements, maintain regulatory compliance, and support long-term operational sustainability.

Turnipseed Engineers has submitted a proposal to provide comprehensive engineering and inspection services for the WWTP expansion project. The scope of work includes design, technical reporting, bidding assistance, and construction phase services for the expansion. These services will be delivered for a fixed lump sum fee of \$1.75 million.

Funding: Budgeted Line Item

Recommendation: Approve



ATLANTA
AUGUSTA
ST. SIMONS ISLAND

December 10, 2024

Mr. Omar Senati-Martinez
Deputy City Manager
City of Port Wentworth
7224 GA-21
Port Wentworth, Georgia 31407

Re: City of Port Wentworth
Water Pollution Control Plant Expansion

Dear Mr. Senati-Martinez:

As requested, we are pleased to submit our proposal for providing engineering services for expanding the City's Water Pollution Control Plant. We understand the City is considering increasing the plant capacity from 2 million gallons per day to 4 million gallons per day. The scope of services we propose to provide include the following:

Design

1. Meet with City of Port Wentworth personnel to discuss the proposed project.
2. Prepare a preliminary design with cost estimate and alternatives and present to the City for approval.
3. Perform any necessary surveys.
4. Prepare detailed construction drawings, specifications, bid documents and contract documents for the construction of the project according to the final scope selected by the City. We will meet with the City during the design phase to discuss progress, material and equipment selection and other possible items.
5. Submit plans and specifications to the Environmental Protection Division and City for review and approval.

Reports

1. Complete an anti-degradation review for submittal to EPD as required by the Clean Water Act.
2. Prepare the Design Development Report (DDR) as required by EPD, which will describe the existing treatment facilities and the proposed expansion. Included in the

Mr. Omar Senati-Martinez
City of Port Wentworth

December 10, 2024
Page 2

report will be site plans, schematic drawings, preliminary hydraulic data, equipment and unit process sizing and a discussion of the construction schedule. During preparation of the DDR, meetings will be held with the plant operating staff to discuss proposed alternatives, treatment processes, equipment performances, etc.

3. Prepare an Environmental Information Document (EID) as required by EPD, which will evaluate the environmental impacts of the proposed expansion.
4. Prepare the NPDES permit and submit to EPD.
5. Prepare the Operations and Maintenance manual (O&M) for the expanded plant.

Bidding Services

1. Assist the City in obtaining construction bids on the project, be present at the bid opening, tabulate bids received and make recommendations for award of the construction contract.

Construction Services

1. Conduct a preconstruction conference and issue a notice to proceed to the contractor.
2. Perform periodic site visits during construction, review contractor pay requests and submit to the County, approve construction schedules and shop drawings, prepare change orders as required and answer any questions concerning the drawings or specifications.
3. Perform a final inspection and submit a statement of completion.
4. Submit a detailed set of record drawings for the project.

For the above scope of services, we propose the following fee schedule:

Basic Services:	A Fixed Fee Lump Sum of \$1.75 Million (Equals 7.0% of the estimated construction cost of \$25 Million)	
Inspection Services:	\$85 per hour	
Additional Services:	Anti-Degradation Review	\$15,000 Lump Sum
	Design Development Report	\$15,000 Lump Sum
	EID Report	\$10,000 Lump Sum
	O&M Report	\$25,000 Lump Sum
	Other (If Requested)	Actual Payroll x 1.97

Turnipseed Engineers has experience assisting cities with securing and managing various funding sources, including bonds and federal and state funding agencies. We would be happy to assist the City by providing funding services as desired.

Mr. Omar Senati-Martinez
City of Port Wentworth

December 10, 2024
Page 3

We appreciate the opportunity to provide this proposal to the City of Port Wentworth. We will be glad to meet with you at your convenience to discuss any questions you might have concerning our proposal.

Yours truly,

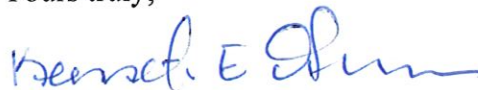

Kenneth E. Green, P. E., *President*
Turnipseed Engineers

KEG:jf
Enclosures: General Conditions

**AUTHORIZATION TO PROCEED
WATER POLLUTION CONTROL PLANT EXPANSION**

CITY OF PORT WENTWORTH, GEORGIA

Authorized Signature

Date

Printed Name

Title



GENERAL CONDITIONS OF AGREEMENT

1. COORDINATION WITH THE OWNER:

The Engineer shall hold periodic conferences with the Owner, or his representatives, to the end that the Project, as it progresses shall have benefit of the Owner's experience and knowledge of existing needs and facilities, and be consistent with the Owner's current policies and construction standards. To implement this coordination, the Owner shall make available to the Engineers, for use in planning the Project, all existing plans, maps, field notes, statistics, computations and other data in his possession relative existing facilities and to the Project.

2. FEES

Unless otherwise specified, fees shall be paid the Engineer in accordance with monthly billings based upon work performed and expenses incurred during that month. Any payments not made within thirty (30) days on statements rendered shall be subject to charge for interest at a rate of one and one-half percent (1-1/2%) per month, beginning 30 days after date of the statement, and failure to make payments when due will entitle the Engineer to suspend services. The Engineer's final payment is due and payable upon completion of the Engineers services. The final payment to the Engineer shall not be withheld, due to refusal of the Contractor to perform a check list item, or because of disputes with the Contractor over liquidated damages, Contractor's performance, etc., since the Engineer cannot and does not serve as surety for the Contractor's performance.

3. OWNERSHIP OF DOCUMENTS AND RECORDS

It is understood that the Engineer is preparing documents for a specific installation, rather than standard documents for repetitive multiple use. Therefore, all documents, including original drawings, estimates, specifications, field notes and data are and remain the property of the engineer as instruments of service. The Owner may obtain, upon payment of fees due the Engineer, reproducible copies of drawings, and copies of other documents, in consideration of which it is mutually agreed that the Owner will use them solely in connection with the project, and shall not authorize their use on other projects, except by written agreement with the Engineer. The Engineer shall retain all pertinent records relating to the services performed hereunder for a period of three years after completion thereof. The Owner shall have access to such records at all reasonable times during such period as may be required for audit of reimbursable items.

4. MODIFICATIONS DURING DESIGN

The Engineer shall retain discretion as to whether changes made by the Owner or his representatives during the design phase shall constitute additional services. Minor modifications and dimensional adjustments are considered to be normal design development. Relocation of sites, relocation of structures, parking areas, and roadways may result in additional services if such changes result in loss of completed design work required.

5. TERMINATION; SUSPENSION OF WORK:

The Owner may at its discretion, terminate the work or indefinitely suspend the work under this Agreement, by giving a seven-day written notice. In such event, the Owner shall assume all obligations, commitments, and claims that the Engineer may have theretofore in good faith undertaken or incurred in connection with the Project. The Engineer shall be equitable paid for services rendered prior to effective termination notice date and for reasonable termination expenses.

6. PROFESSIONAL RESPONSIBILITIES

All services hereunder will be performed in accordance with sound and generally accepted principles by personnel experienced in the applicable technical fields.

The Engineers scope of authority does not include the expenditure of the Owner's funds through changes, disbursement powers, or supervision of the Construction Contractor's men or his subcontractors. The Engineer shall not be responsible for construction methods, techniques, sequences or procedures, safety precautions and programs in connection with activities of the Construction Contractor. As to the warranty or guaranty of, or patent indemnity on, items or machinery, equipment or other products manufactured by others, or work of construction contractor's, subcontractors or manufacturers, the Engineer's responsibility with respect thereto is limited to the assignment by the Engineer to the Owner of the manufacturer's or construction contractor's warranty or guaranty and/or patent indemnity, and the Engineer agrees to cooperate with the Owner in the enforcement thereof. The Engineer shall use reasonable and acceptable methods in establishing basis for cost estimates, but cannot guarantee that the construction contractor's bid basis or costs will not vary above or below such estimates. The Engineer shall be included as additional insured, where construction is involved, on the Builder's Risk Policy and on the Contractor's General Liability Policy. In no event shall the liability of the Engineer for damages exceed \$50,000 or the total compensation received by the Engineer for services rendered hereunder, whichever is greater.

7. SUCCESSORS AND ASSIGNMENTS

The Owner and the Engineer each binds himself and his partners, successors, executors, administrators and assigns to the other party of the Agreement and to the partners, successors, executors, administrators and assigns of such other party, in respect to all covenants, of the Agreement; except as above, neither the Owner nor the Engineer shall assign, sublet, or transfer his interest in the Agreement without the written consent of the other, and they further agree that the Agreement represents the entire understanding of the Owner and the Engineer and cannot be changed, added to or modified in any way except by an instrument in writing signed by the Owner and by the Engineer. The Owner and Engineer agree to the full performance of the covenants contained herein.

END OF GENERAL CONDITIONS OF AGREEMENT



ADDENDUM NO. ONE

to

Turnipseed Engineers Proposal
dated December 10, 2024

For the City of Port Wentworth
Water Pollution Control Plant Expansion

The following terms and conditions are hereby incorporated into the subject proposal.

1. Invoice the City on a quarterly basis
2. Billing not-to-exceed \$750,000 in FY2026 (07/01/2025 – 06/30/2026)
3. Balance invoiced in FY2027 (07/01/2026 – 06/30/2027)

Payment Schedule as follows:

<i>Quarterly Billing</i>	<i>Payment Schedule</i>
<i>September 2025</i>	<i>\$187,500</i>
<i>December 2025</i>	<i>\$187,500</i>
<i>March 2026</i>	<i>\$187,500</i>
<i>June 2026</i>	<i>\$187,500</i>
<i>September 2026</i>	<i>\$250,000</i>
<i>December 2026</i>	<i>\$250,000</i>
<i>March 2027</i>	<i>\$250,000</i>
<i>June 2027</i>	<i>\$250,000</i>

Accepted by:

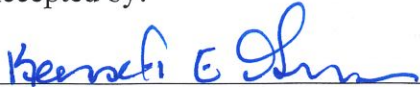

 Kenneth E. Green, *President*
 Turnipseed Engineers

8/19/25

 Date

Authorized Signature

Date

Printed Name

Title



City Council
7224 GA Highway 21
Port Wentworth, GA 31407

Meeting: 08/21/25
Department: Administration
Category: Agreement
Prepared By: Zahnay Smoak
Department Head:

SCHEDULED

AGENDA ITEM (ID)

DOC ID:

Right of Way Maintenance

Issue/Item: Tidewater Landscape Management to provide Right of Way Maintenance for The City of Port Wentworth.

Background: This ROW maintenance includes Highway 21 from city limit to city limit, Highway 30 from Highway 21 to Benton Boulevard, and Benton Boulevard from the Highway 30 roundabout to the city limits. All associated roundabouts are also included in the maintenance scope. Work will consist of mowing, edging, debris removal, and landscaping where needed. These efforts will improve the overall appearance and upkeep of the city's main travel routes. Maintaining these areas to a higher standard will enhance the city's image and contribute to a cleaner, more welcoming environment for residents and visitors.

Facts and Finding: The City of Port Wentworth is not responsible for the ROW maintenance along state roadways, however, the City feels it is their duty to upkeep the ROW and its image to provide a more welcoming environment for the residents and visitors. Tidewater Landscape Management was selected from multiple bids submitted. The selection was based on pricing and the scope of work provided by each bidder. Tidewater Landscape Management has been vetted and is insured as required. Tidewater Landscape Management will oversee all avenues of Right of Way Maintenance, which includes all ROWs and adjacent areas as listed.

Funding: \$130,200.00

Recommendation: Approve



This agreement is made and entered into by and between **City of Pt. Wentworth ROW**, with office located at _____ (hereinafter referred to as “Customer”), and Tidewater Landscape Management, Inc., a Georgia company, with a registered address located at 1329 Heidt Ave. Garden City, Georgia 31408 (hereinafter referred to as “Contractor”).

Whereas, Contractor and Customer desire to enter into a relationship in which Contractor will provide grounds management services.

Now, therefore, in consideration of the premises, and of the mutual promises and undertakings herein contained, the parties, do hereby agree as follows:

1. STATEMENT OF WORK

Contractor shall perform services as set forth in the Statement of Work-attached hereto as Attachment A- issued against and subject to the terms and conditions of this Agreement.

Services requested to be performed outside of the Statement of Work will be submitted by the Contractor in the form of a Proposal. Services will commence upon receipt of the signed proposal.

2. TERM

The term of this Agreement shall commence on _____(Date), and shall continue thereafter until _____, or terminated in writing by one of the parties as provided in Section 7 below.

3. INVOICING FORMAT AND PROCEDURES

Contractor shall provide Customer with monthly invoicing as agreed to in the Statement of Work using the Contractor’s standard invoice format and billing procedure. Customization of invoicing outside of the standard format and procedure will incur a surcharge based on the time required to meet the needs of customization

Initial

and/or costs incurred by our software designers. Customer agrees that all requests may not be met given any limitations of the Contractor's billing system. Additionally, any request to utilize a customer's portal or vendor management system will require additional fees to the customer for time incurred for set-up, management and continued use of these systems along with reimbursement by the Customer for any annual dues or membership fees associated with these systems. A quote of additional fees will be provided to the customer in advance of any changes listed in this section for approval prior to continuing. In the event an agreement is not reached on the terms of this section, the Contractor will continue with the standard billing procedure.

4. TERMS OF PAYMENT

a. PRICE. Services will be performed on a firm fixed price basis or a time and materials basis, as indicated in the applicable Statement of Work. Any additional or unscheduled Services to be provided by Contractor outside of the Statement of Work must be mutually agreed upon in writing signed by both parties.

b. TAXES. All prices include applicable taxes.

c. PAYMENT SCHEDULE IN-CONTRACT SERVICES. Customer will receive invoices based upon the billing/payment schedule contained in Attachment B – Price and Payment Schedule. Invoices will contain a description of the Services agreed to and will be sent to the contact listed on the Customer Questionnaire. Invoices are due and payable within 30 days of Contractor's invoice date. Interest may be charged on all amounts unpaid after 45 days at the annual rate of 1-1/2 percent per month or the highest legal rate, whichever is lower. If any invoice is not paid when due, Contractor may suspend provision of Services and/or Deliverables without liability or penalty until final resolution of the matter.

d. PAYMENT SCHEDULE ADDITIONAL SERVICES. Customer at times may request additional services to be performed outside of contracted services. Invoices will contain a description of the services performed and will be sent to the contact listed on the Customer Questionnaire. Invoices are due and payable within 30 days of Contractor's invoice date. Interest may be charged on all amounts unpaid after 45 days at the annual rate of 1-1/2 percent per month or the highest legal rate, whichever is lower. If any invoice is not paid when due, Contractor may suspend provision of Services and/or Deliverables without liability or penalty until final resolution of the matter.

e. METHODS OF PAYMENT. Contractor accepts Cash, Checks, Money orders, Certified Checks or direct ACH as payment for services.

f. CUSTOMER PURCHASE ORDERS. It is the responsibility of the Customer to provide purchase orders to Contractor prior to monthly invoices being generated on the first. Failure of the Customer to provide purchase orders in a timely manner does not relieve Customer of responsibility for on-time payment.

Initial

5. LIMITATION OF LIABILITY

The total liability of Contractor to Customer from any cause whatsoever, will be limited to the lesser of Customer's actual damages or the service price paid to Contractor for those services. In no event will either party be liable for SPECIAL, INDIRECT, CONSEQUENTIAL, OR INCIDENTAL DAMAGES, including but not limited to loss of profits, revenues, data or power, damage to or loss of the use of products, damage to property, claims of third parties, including personal injury or death, suffered as a result of provision of Services or use of Deliverables.

Time for Claims. All claims against Contractor must be brought immediately upon damage occurrence by the Contractor. Claims for damages received 24 hours after occurrence will be denied. Please see Attachment C – Notifications for method of advising Contractor of Damages. Customer waives any statute of limitations which might apply by operation of law or otherwise. Contractor Certificate of Insurance is Attachment D.

6. FORCE MAJEURE

Neither party shall be liable for failure to perform, nor be deemed to be in default, under this Agreement for any delay or failure in performance resulting from causes beyond its reasonable control, including but not limited to failure of performance by the other party, acts of state or governmental authorities, acts of terrorism, natural catastrophe, fire, storm, flood, earthquake, riot, insurrection, civil disturbance, sabotage, embargo, blockade, acts of war, or power failure. In the event of such delay, the date of delivery or time of completion will be extended by a period of time reasonably necessary to overcome the effect of any such delay.

7. TERMINATION

Termination of Services. Either party reserves the right to terminate Services in whole or in part, upon 60 days written notice to the other party. In the event the Service is terminated by Customer, Contractor shall not undertake further work, incur additional expenses, or enter into further commitments with regard to the Services after receiving such notice of termination from Customer, except as mutually agreed upon by the parties. In the event of termination of Services as described above, Contractor shall be entitled to compensation as follows:

- a. All payments due and owing under this Agreement at the time of Contractor's receipt of the written notice of termination for work completed and in progress;
- b. Reimbursement for any non-cancelable services and commitments entered into by Contractor, in connection with the Services being terminated, provided Contractor provides Customer with documentation of completion of work or expenses incurred.

c. Customer will advise Contractor immediately of any change in ownership, responsibility or possession of any property included in this agreement. Failure to provide notice of changes affecting the continuation of services or payment of services by the responsible party in this agreement does not relieve Customer of responsibility for payment of continued services.

Failure by either party to comply in any material respect with any of its obligations in this Agreement shall entitle the other party to give notice to the party in default requiring it to cure such default. If such default is not cured within 30 days after receipt of such notice, the notifying party shall be entitled to terminate this Agreement by giving notice of such termination to take effect immediately. The right of either party to terminate this Service Contract, as herein provided, shall not be affected in any way by its waiver of, or failure to take action with respect to, any previous default.

8. DELAY OR SUSPENSION OF WORK

If Customer's acts or failure to act causes Contractor to delay or suspend performance of Services, Contractor and Customer will mutually agree to one of the following remedies:

a. Contractor will use reasonable efforts to continue performance as practicable under the circumstances and Customer will continue to make all scheduled payments; or

b. Contractor will re-assign personnel to extend Contractor's work schedule without liability, and Customer will pay all additional costs, if any.

Notwithstanding the above, Contractor shall have the right to invoice Customer for any work performed to date of suspension.

9. SUBCONTRACTING

Contractor may, at its option, subcontract work under a Statement of Work but Contractor's use of subcontractors shall not affect its responsibilities under the applicable Statement of Work. Moreover, Contractor shall be fully responsible for work done by its subcontractors within the scope of the applicable Statement of Work as it is for work done by its own employees. Contractor shall have written agreement(s) with its subcontractors that contain, at a minimum, clauses that are the same as or comparable to the sections of this Agreement regarding ownership rights and confidentiality of Customer's materials.

10. GENERAL TERMS

a. This Service Contract shall be deemed to have been made, executed and delivered in the State of Georgia and shall be construed in accordance with the laws of the State of Georgia.

b. NOTICES. Notices to be given by either party under this Agreement shall be sent by certified mail, express overnight delivery, or telecopy to the attention of the other party at the addresses of the parties as indicated in Attachment C – Notifications.

c. SEVERABILITY AND ASSIGNMENT. The invalidity or unenforceability, in whole or in part, of any provision in this Agreement shall not affect in any way the remainder of the provisions herein. This Agreement may not be assigned by Customer without Contractor’s consent.

d. ENTIRE AGREEMENT. This Agreement, together with any other materials referenced in or expressly made a part of the Agreement, constitutes the final and entire Agreement between Contractor and Customer and supersedes all prior and contemporary agreements, oral or written.

e. COUNTERPARTS. The Parties hereto agree that facsimile signatures shall be as effective as if originals. This Agreement may be executed via facsimile in any number of counterparts, all of which taken together shall constitute one and the same agreement.

In Witness Whereof, this Agreement is duly executed by the duly authorized representatives of the parties as set forth below:

Tidewater Landscape Management, Inc.

Signature

Date

Name

Title

Customer

Signature

Date

Name

Title

Initial

ATTACHMENT A

STATEMENT OF WORK

This "Statement of Work" is entered into by and between _____ and Tidewater Landscape Management, Inc. pursuant to the Service Contract entered into by the parties as of (date) _____.

In-Contract Services

Initial Clean up- This is to come in and bush hog and line trim the entire ROW to get it standards of how it should look. This is billed upon completion. Regular service would start the following week to save from having to double cut the clean up.

TOTAL: \$10,800.00 This is billed upon completion.

Grounds Maintenance - \$119,400.00 per year. (\$9,950.00 per month)

Bi weekly Service April-September 30th- 1 time a month October through March 30th. Mowing, edging, String Trimming, blowing off of entire property. crack weeds through out the property. **This also includes 5 aqdditional litter pick ups during the off season of Mowing service.**

ATTACHMENT B

PRICE AND PAYMENT SCHEDULE

In-Contract Services will be billed monthly at 1/12th the annual contract price as indicated in Attachment A Statement of Work. Statements are mailed monthly reflecting all outstanding invoices as of the date of the statement.

See the schedule below for specific billing dates, amounts and due dates based on your Agreement:

MONTHLY BILLING DATE		AMOUNT	DUE DATE	
JANUARY	1ST	9950.00	JANUARY	30TH
FEBRUARY	1ST	9950.00	FEBRUARY	30TH
MARCH	1ST	9950.00	MARCH	30TH
APRIL	1ST	9950.00	APRIL	30TH
MAY	1ST	9950.00	MAY	30TH
JUNE	1ST	9950.00	JUNE	30TH
JULY	1ST	9950.00	JULY	30TH
AUGUST	1ST	9950.00	AUGUST	30TH
SEPTEMBER	1ST	9950.00	SEPTEMBER	30TH
OCTOBER	1ST	9950.00	OCTOBER	30TH
NOVEMBER	1ST	9950.00	NOVEMBER	30TH
DECEMBER	1ST	9950.00	DECEMBER	30TH
TOTAL		\$119,400.00		

Although Contractor invoices at 1/12th the annual service agreement price, services are performed based on the seasonal needs of the property. There are times during the year when services performed have exceeded the payment received on the monthly billing cycle. Should this Agreement be cancelled prior to the end of the term of the agreement (and the full year of billing) all performed but unpaid services will be due in-full. A schedule of those services and balances will be billed upon termination of the Agreement.

Initial

ATTACHMENT C

NOTIFICATIONS

Notifications to Contractor

Corporate office is open 8 a.m. to 5 p.m. Monday through Friday and closed daily for lunch noon to 1 p.m.

Tidewater Landscape Management, Inc.

Corporate Office
1329 Heidt Ave.
Garden City, GA 31408

Billing:

Office - (912) 966-7391
Email - billing@tidewaterusa.com

Payments:

Tidewater Landscape Mangement, Inc.
PO Box 7571
Garden City, GA 31418

Damages:

Office (912) 966-7391
Email accountspayable@tidewaterusa.com

Service Needs:

Office (912) 966-7391

Official Notifications

Tidewater Landscape Management, Inc.
PO Box 7571
Garden City, GA
31418

Customer Official Notifications Address:

Initial

Client#: 1988727

ATTACHMENT D

595TIDEWLAN

ACORD™

CERTIFICATE OF LIABILITY INSURANCE

DATE (MM/DD/YYYY)
3/29/2021

THIS CERTIFICATE IS ISSUED AS A MATTER OF INFORMATION ONLY AND CONFERS NO RIGHTS UPON THE CERTIFICATE HOLDER. THIS CERTIFICATE DOES NOT AFFIRMATIVELY OR NEGATIVELY AMEND, EXTEND OR ALTER THE COVERAGE AFFORDED BY THE POLICIES BELOW. THIS CERTIFICATE OF INSURANCE DOES NOT CONSTITUTE A CONTRACT BETWEEN THE ISSUING INSURER(S), AUTHORIZED REPRESENTATIVE OR PRODUCER, AND THE CERTIFICATE HOLDER.

IMPORTANT: If the certificate holder is an ADDITIONAL INSURED, the policy(ies) must have ADDITIONAL INSURED provisions or be endorsed. If SUBROGATION IS WAIVED, subject to the terms and conditions of the policy, certain policies may require an endorsement. A statement on this certificate does not confer any rights to the certificate holder in lieu of such endorsement(s).

PRODUCER McGriff Insurance Services 7391 Hodgson Memorial Drive Savannah, GA 31406 912 544-5050	CONTACT NAME: Georgia Certificate Team	
	PHONE (A/C, No, Ext): FAX (A/C, No): 877-657-1559	
	E-MAIL ADDRESS: certificatesga@mcgriff.com	
INSURED Tidewater Landscape Management, Inc. P. O. Box 7571 Garden City, GA 31418	INSURER(S) AFFORDING COVERAGE	NAIC #
	INSURER A: Liberty Mutual Fire Insurance Company	23035
	INSURER B: Liberty Insurance Corporation	42404
	INSURER C: Travelers Property Casualty Co of Amer	25674
	INSURER D:	
	INSURER E:	

COVERAGES CERTIFICATE NUMBER: REVISION NUMBER:

THIS IS TO CERTIFY THAT THE POLICIES OF INSURANCE LISTED BELOW HAVE BEEN ISSUED TO THE INSURED NAMED ABOVE FOR THE POLICY PERIOD INDICATED. NOTWITHSTANDING ANY REQUIREMENT, TERM OR CONDITION OF ANY CONTRACT OR OTHER DOCUMENT WITH RESPECT TO WHICH THIS CERTIFICATE MAY BE ISSUED OR MAY PERTAIN, THE INSURANCE AFFORDED BY THE POLICIES DESCRIBED HEREIN IS SUBJECT TO ALL THE TERMS, EXCLUSIONS AND CONDITIONS OF SUCH POLICIES. LIMITS SHOWN MAY HAVE BEEN REDUCED BY PAID CLAIMS.

INSR LTR	TYPE OF INSURANCE	ADDL INSR	SUBR WVD	POLICY NUMBER	POLICY EFF (MM/DD/YYYY)	POLICY EXP (MM/DD/YYYY)	LIMITS
A	<input checked="" type="checkbox"/> COMMERCIAL GENERAL LIABILITY <input type="checkbox"/> CLAIMS-MADE <input checked="" type="checkbox"/> OCCUR <input checked="" type="checkbox"/> PD Ded:2,500 GEN'L AGGREGATE LIMIT APPLIES PER: <input type="checkbox"/> POLICY <input type="checkbox"/> PRO-JECT <input type="checkbox"/> LOC OTHER:	X	X	TB2Z91471559021	04/01/2021	04/01/2022	EACH OCCURRENCE \$1,000,000 DAMAGE TO RENTED PREMISES (Ea occurrence) \$300,000 MED EXP (Any one person) \$5,000 PERSONAL & ADV INJURY \$1,000,000 GENERAL AGGREGATE \$2,000,000 PRODUCTS - COM/PROP AGG \$2,000,000 \$
A	AUTOMOBILE LIABILITY <input checked="" type="checkbox"/> ANY AUTO <input type="checkbox"/> OWNED AUTOS ONLY <input type="checkbox"/> SCHEDULED AUTOS <input checked="" type="checkbox"/> HIRED AUTOS ONLY <input checked="" type="checkbox"/> NON-OWNED AUTOS ONLY	X	X	AS2Z91471559011	04/01/2021	04/01/2022	COMBINED SINGLE LIMIT (Ea accident) \$1,000,000 BODILY INJURY (Per person) \$ BODILY INJURY (Per accident) \$ PROPERTY DAMAGE (Per accident) \$ \$
B	<input checked="" type="checkbox"/> UMBRELLA LIAB <input checked="" type="checkbox"/> OCCUR <input type="checkbox"/> EXCESS LIAB <input type="checkbox"/> CLAIMS-MADE DED <input checked="" type="checkbox"/> RETENTION \$10000			TH7Z91471559041	04/01/2021	04/01/2022	EACH OCCURRENCE \$5,000,000 AGGREGATE \$5,000,000 \$
A	WORKERS COMPENSATION AND EMPLOYERS' LIABILITY ANY PROPRIETOR/PARTNER/EXECUTIVE OFFICER/MEMBER EXCLUDED? <input type="checkbox"/> Y <input checked="" type="checkbox"/> N/A (Mandatory in NH) If yes, describe under DESCRIPTION OF OPERATIONS below		X	WC2Z91471559031	04/01/2021	04/01/2022	<input checked="" type="checkbox"/> PER STATUTE <input type="checkbox"/> OTHER E.L. EACH ACCIDENT \$500,000 E.L. DISEASE - EA EMPLOYEE \$500,000 E.L. DISEASE - POLICY LIMIT \$500,000
C	Leased/Rented	X		QT6602464M552TIL21	04/01/2021	04/01/2022	\$100,000

DESCRIPTION OF OPERATIONS / LOCATIONS / VEHICLES (ACORD 101, Additional Remarks Schedule, may be attached if more space is required)
 *see forms attached
 LC2058 0117 CGL AI Enhance for Contractors
 LC0443 0117 Commercial General Liability Enhancement For Contractors
 CG2010 0413 AI Blanket
 CG2037 0413 AI Blanket Completed Ops
 (See Attached Descriptions)

CERTIFICATE HOLDER	CANCELLATION
	SHOULD ANY OF THE ABOVE DESCRIBED POLICIES BE CANCELLED BEFORE THE EXPIRATION DATE THEREOF, NOTICE WILL BE DELIVERED IN ACCORDANCE WITH THE POLICY PROVISIONS. AUTHORIZED REPRESENTATIVE 

CUSTOMER QUESTIONNAIRE

Customer preferred contact for service needs:

Name _____

Title _____ Phone Number _____

Email _____

Customer preferred contact for billing needs:

Name _____

Title _____ Phone Number _____

Email _____

Customer billing address:

Customer invoices shall be mailed to the following address if different than above:

Customer Invoices shall be emailed to the following address:

Please confirm preferred method of invoicing: _____ Mail or _____ Email

**All statements are mailed regardless of preferred invoicing method.*

Do you have any special invoicing needs? Please explain



City Council
7224 GA Highway 21
Port Wentworth, GA 31407

Meeting: 08/21/25
Department: Administration
Category: Presentation
Prepared By: Zahnay Smoak
Department Head:

SCHEDULED

AGENDA ITEM (ID)

DOC ID:

**Update to the FY 2026 Fee Schedule- 1st Reading
Public Hearing**

•

Issue/Item: Update to the FY 2026 Fee Schedule.

Background: The FY 2026 Fee Schedule was adopted by City Council on 6/26/2025 and became effective 7/01/2025.

Facts and Finding: The FY 2026 Fee Schedule as adopted, has five different Aid to Construction fee districts (City of Port Wentworth / \$4,894.06, Georgia Highway 21/Crossgate / \$7,012.89, I-95 and Highway 21 / \$8,361.38, Rice Hope Service District / \$8,401.59, and Lake Shore / \$5,481.27). Due to new development and the added utility service areas along Highway 30, three new Aid to Construction service districts have been created to replace all existing districts. The districts are I-95 South / \$7,012.89, I-95 North / \$8,361.26 and Highway 30 West / \$10,706.38

Funding: N/A

Recommendation: Approve



FY2026 Fee Schedule

Adopted by the City Council on 06/26/2025
Effective 07/01/2025

ALCOHOL BEVERAGE LICENSE FEES

Description	Rate	Fee
Distilled Spirits consumption on premises within the Central Business District	Annual	\$1,631.09
Distilled Spirits consumption on premises outside the Central Business District	Annual	\$4,349.59
Distilled Spirits – Wholesale	Annual	\$2,174.79
Distilled Spirits – Manufacturer	Annual	\$4,349.59
Distilled Spirits by the package Retail	Annual	\$5,436.99
Wine Package Retail	Annual	\$543.70
Wine consumption on premises	Annual	\$326.22
Wine – Wholesale	Annual	\$271.85
Wine – Manufacturer	Annual	\$271.85
Wine – Importer	Annual	\$217.48
Malt Beverage Package Retail	Annual	\$543.70
Malt Beverage consumption on premises	Annual	\$543.70
Malt Beverage – Wholesale	Annual	\$ 271.85
Malt Beverage – Manufacturer	Annual	\$815.55
Advertisement Fee	Initial Fee	Varies (contact clerk)
Returned Check	Each	\$50.00
Administrative Fee	Flat	\$50.00



FY2026 Fee Schedule

Adopted by the City Council on 06/26/2025
Effective 07/01/2025

OCCUPATIONAL TAXES

Number of Employees	Rate Calendar Year 2026 Paid Before January 31,2026 <i>\$50.00 Administrative Fee included</i>	Rate Calendar Year 2026 paid After January 31,2026 <i>20% penalty included</i>
1	\$201.77	\$242.13
2	\$247.58	\$297.10
3	\$293.20	\$351.84
4	\$347.67	\$417.21
5	\$356.99	\$428.38
6	\$403.14	\$483.77
7	\$430.76	\$516.91
8	\$441.59	\$529.90
9	\$458.28	\$549.93
10 to 99	\$458.28 +46.61 per employee in excess of 9	\$549.93 +46.61 per employee in excess of 9
100 to 499	\$4,656.96 +36.66 per employee in excess of 99	\$5,588.36 +36.66 per employee in excess of 99
500 and over	\$19327.09 +29.50 per employee in excess of 499	\$23,192.51 +29.50 per employee in excess of 499
Unrestricted	Insurance Company (Flat)	\$76.88



FY2026 Fee Schedule

*Adopted by the City Council on 06/26/2025
Effective 07/01/2025*

SPECIAL EVENT FEES

Description	Rate	Fee
Permit Filing Fee	Flat	\$25.63
Beverage Caterers - Beer & Wine	Flat	\$30.75
Beverage Caterers – Distilled Spirits	Flat	\$51.25
Temporary for Special Event with sales	Each	\$51.25 per day up to \$2050.00 Max
Temporary for Special Event without sales	Each	\$51.25 per day up to \$2050.00 Max
*Certification of Liability must be provided along with application.		

FILM PRODUCTION FEES

Description	Rate	Fee
Film Permit – Professional	Flat	\$25.63
Film Permit - Student	Flat	\$0.00
*Professional Productions Registration Form must be complete with the Savannah Regional Film Commission		



FY2026 Fee Schedule

Adopted by the City Council on 06/26/2025
Effective 07/01/2025

LEISURE SERVICES

FACILITY RENTAL FEES			
Description	Current Resident	Non-Resident	Deposit
Community House	\$159.13 Full Day	N/A	\$53.04
P.B. Edwards, JR. Gym	\$68.96 per hour	\$90.18	\$53.04(resident)/ \$106.88 (non-resident)
	\$530.44 Full Day	\$721.40 Full Day	\$53.04(resident)/ \$106.88 (non-resident)
Houston Church	\$159.13 Full Day	\$265.22 Full Day	\$53.04
Lewis Mobley Park	\$63.65 per hour includes lights (2- hr minimum)	\$90.18 per hour (2-hr minimum)	\$53.04(resident)/ \$106.88 (non-resident)
	\$1,007.83 Full Day	\$1,166.96 Full Day	\$212.18
	\$1,962.62 Weekend	\$2,333.93 Weekend	\$212.18
	\$106.09 Concessions Full Day	\$159.13 Concessions Full Day	\$212.18
Lions Ball Park / Sonny Dixon Field	\$68.96 per hour (2- hr minimum)	\$90.18 per hour (2- hr minimum)	\$53.04
	\$530.44 Full Day	\$689.57 Full Day	\$265.22
	\$106.09 Full Day Concessions	\$159.13 Full Day Concessions	\$265.22
	\$79.57 club house only (2-hr minimum)	\$100.78 per hour (2-hr minimum)	\$265.22
	\$106.09 per hour to rent Park & Club	\$185.66 per hour to rent Park & Club	\$265.22
	\$1,166.96 Weekend Tournament Rental	\$1,591.31 Weekend Tournament Rental	\$265.22
HEALTH WELLNESS & RECREATION SESSIONS			
Yoga, Fitness, Aerobics & Zumba etc.	Prices determined by Director	Prices determined by Director	N/A
<i>Continued next page</i>			



FY2026 Fee Schedule

Adopted by the City Council on 06/26/2025
Effective 07/01/2025

CURRENT SPORTS AND LEISURE PROGRAMS			
Basketball, Baseball, Softball, T-Ball Football, Cheerleading, Volleyball, Soccer	\$68.96 per season	\$90.18 per season	N/A
INDIVIDUAL AND DUAL SPORTS & ACTIVITIES			
Gymnastics, Dance and Camps	Prices determined by Director	Prices determined by Director	Prices determined by Director
Summer Clinics and Camps	Prices determined by Director	Prices determined by Director	Prices determined by Director



FY2026 Fee Schedule

Adopted by the City Council on 06/26/2025
Effective 07/01/2025

DEVELOPMENT SERVICES

DEVELOPMENT SERVICES		
Description		Rate
Administrative Fee		\$84.56
Re-inspection Fee – Building Inspector	First	\$55.00
	Second	\$84.56
	Third	\$112.75
Re-Inspection Fee – Fire Marshal		\$56.38
Permits not completed by original applicant	Per inspection	\$56.38
CDM		\$112.75
Expired Permit Re-approval		\$112.75
Development Fees		
Master Plan Review	(Major Subdivision)	\$338.25
Preliminary Plat	(Major Subdivision)	\$563.75
	Plus, per lot	\$56.38
Preliminary Plat	(Minor Subdivision and “Exempt”)	\$451.00
Final Plat	(Major or Minor Subdivision)	\$451.00
	per page	\$11.28
	per lot	\$56.38
Site Plan	Revision to PUD Specific Development	\$1127.50
Site Plan	General/Concept	\$338.25
Zoning Board of Appeals		338.25
Zoning Map Amendment		\$563.75
	Plus, per acre	\$56.38
Special Use Permit		\$338.25
Copy of Zoning Ordinance		\$112.75
Copy of Zoning Ordinance Map		\$112.75
Engineering Fees	Per Page	
	Varies by Bill	
BUILDING PERMIT FEES (Vertical Construction)		
Permit fees		
Project Valuation \$1.00 - \$200,000		\$11.28 per thousand
Project Valuation \$200,001 - \$500,000	First 200,000	\$2,255.00 Plus \$10.15 for each additional



FY2026 Fee Schedule

Adopted by the City Council on 06/26/2025
Effective 07/01/2025

		thousand
<i>Continued next page</i>		

Project Valuation \$500,001 and up	First 500,000	\$5,299.25 Plus \$3.95 for each additional thousand
Plan Check Fee		One half of building fee
Residential pools	(Single-family)	\$112.75
Multifamily or public pools		\$225.50
Docks	Single Family	\$112.75
Docks	Multifamily and Commercial	\$197.31
Permanent Sign	Per square foot	\$7.89 per square foot or 200 minimum
Billboard Sign		\$1,691.25
Temporary Sign		\$225.50
Sign Electrical Fee		\$112.75
Moving of building or structures		\$338.25
Demolition of building or structures	Less than 400 square feet	\$112.75
Demolition of building or structures	Greater than 400 square feet	\$225.50
Well installation	Shallow well less than 44 ft	\$112.75
Well installation	Deep Well	\$112.75
Landfills, mining, ponds		\$225.50
Fence		\$112.75
Driveway Pipe Application		\$56.38
	Plus, per square foot for pipe	\$28.19
Electrical		\$112.75
Plumbing		\$112.75
Mechanical		\$112.75
New Underground tank installation per tank inspection	Per tank inspection	\$56.38
Leak detection system installation, per inspection	Per inspection	\$56.38
New integral piping system installation,	Per inspection	\$56.38
Zoning Verification Letter		\$112.75



FY2026 Fee Schedule

Adopted by the City Council on 06/26/2025
Effective 07/01/2025

Permit Contractor Change		\$84.56
Stop work order fee		\$563.75

<i>Continued Building Permit Fees</i>		
--	--	--

Work with no permit fee		\$563.75
Extend permit for (6) six months fee		\$281.88
Occupancy Change Permit		\$338.25
Fire Marshal Review	All Projects	\$281.88
Occupy Building without a Certification of Occupancy fee		\$563.75
¾ inch water meters from public works	Each	\$873.81
Zoning Board of Appeals Application		\$338.25
Public Hearing schedule change request		\$281.88

TAP FEES		
-----------------	--	--

Hotel, Motels, Inns	Initial Connection Expansion	\$7,610.63
---------------------	---------------------------------	------------

Office, retail shops, commercial, and industrial		
---	--	--

Three-fourths inch by five-eighths inch meter		\$507.38
One-inch meter		\$633.66
Two-inch meter		\$845.63
Three-inch meter		\$2,113.55
Four-inch meter		\$4,228.13
Six-inch meter		\$7,948.88



FY2026 Fee Schedule

Adopted by the City Council on 06/26/2025
Effective 07/01/2025

Eight-inch meter		\$9,809.25
FIRE PROTECTION TAP – Any residential, commercial, institutional/industrial structure		
Three-inch meter		\$2,114.06



FY2026 Fee Schedule

Adopted by the City Council on 06/26/2025
Effective 07/01/2025

<i>Continued Fire Protection Tap</i>		
Four-inch meter		\$4,228.13
Six-inch meter		\$7,948.88
Eight-inch meter		\$9,809.25
Locate, initial open trench and final		\$87.64
Omni Marker		\$14.09
AID TO CONSTRUCTION		
I-95 South	Per ERU	\$7,012.89
I-95 North	Per ERU	\$8,361.26
Highway 30 West	Per ERU	\$10,706.38



FY2026 Fee Schedule

Adopted by the City Council on 06/26/2025
Effective 07/01/2025

LIFE AND SAFETY INSPECTIONS		
Description	Rate	Fee
Inspection	Annual	\$102.50
Apartment and Hotel Room Inspections	TBD	\$102.50
Single Family Home Inspections	TBD	\$102.50
Apartment Transition Inspection	TBD	\$51.25
FIRE OPERATION FEES		
Description	Rate	Fee
Vehicle Fires	TBD	\$768.75
Commercial Vehicle Fires	TBD	\$1,537.50
Accidents/Vehicle Clean Up	TBD	\$768.75



FY2026 Fee Schedule

Adopted by the City Council on 06/26/2025
Effective 07/01/2025

TECHNOLOGY DEPARTMENT

CLIC – CONFERENCE SPACE		
Description		Rate
CLIC – Conference Room 2600 sq ft. Up to 32 guests 16 computers (2) 4k Projector w/Screens Wireless Internet Coffee Bar Available (must supply coffee)	Public Government Entities Full Day	\$153.75 (3-hr minimum) \$102.50 \$615.00 + 76.88 per hour (afterhours)
Cleaning Fee	Full Day Booking Only	\$287.00



City Council
7224 GA Highway 21
Port Wentworth, GA 31407

Meeting: 08/21/25
Department: Administration
Category: Resolution
Prepared By: Zahnay Smoak
Department Head:

SCHEDULED

AGENDA ITEM (ID)

DOC ID:

Resolution Establishing a Port Wentworth Youth Council

Issue/Item: Establishing a Youth Council in the City of Port Wentworth to provide young residents with a formal platform for civic engagement, leadership development, and participation in community decision-making.

Background: The City of Port Wentworth, like many growing communities, is experiencing rapid demographic, economic, and cultural changes. As the population expands, so does the need for inclusive civic engagement that represents all age groups. Currently, youth voices are often underrepresented in local decision-making processes, despite young residents making up a significant portion of the city’s population. In addition to building a stronger connection between young residents and their local government, youth councils can enhance community pride, increase volunteerism, and help cultivate the next generation of civic leaders. Port Wentworth’s commitment to strategic growth and community development positions it well to benefit from such an initiative.

Facts and Finding:

Benefits of Youth Councils in Comparable Cities

- Studies from the National League of Cities (NLC) show that cities with youth councils report higher levels of youth civic engagement and increased collaboration between students, schools, and city government.
- Peer municipalities in Georgia, such as Savannah, and other sister Cities have successfully implemented youth councils, resulting in stronger community connections and youth-driven community projects.

Leadership Development & Civic Education

- Youth councils provide structured opportunities for leadership skill development, public speaking, project management, and policy research.
- They can function as a practical extension of civic education, allowing students to experience governance beyond the classroom.

Community Engagement & Volunteerism

- A Youth Council can mobilize young residents to participate in city events, volunteer initiatives, and outreach programs, helping meet community service goals.
- Involving youth in city-led initiatives has been shown to increase family participation and community turnout.

Alignment with City Goals

- Establishing a Youth Council supports Port Wentworth's vision of fostering an inclusive, engaged, and forward-looking community.
- It aligns with strategic priorities of building leadership pipelines, enhancing quality of life, and encouraging civic responsibility among all residents.

Funding:

Recommendation:

STATE OF GEORGIA
COUNTY OF CHATHAM
CITY OF PORT WENTWORTH

A RESOLUTION TO ESTABLISH THE PORT WENTWORTH YOUTH COUNCIL

WHEREAS, the Mayor and City Council of the City of Port Wentworth recognize the importance of engaging young residents in the processes of local government; and

WHEREAS, fostering civic engagement among youth encourages leadership development, community service, and a stronger understanding of municipal governance; and

WHEREAS, the City of Port Wentworth seeks to provide structured opportunities for high school-aged residents to contribute ideas, voice concerns, and participate in shaping the community's future; and

WHEREAS, the creation of a Youth Council will allow students to serve as a voice for the youth to the Mayor and City Council, offering a youth perspective on issues that affect the City; and

WHEREAS, the establishment of such a council aligns with the City's mission to promote inclusive participation and to invest in the development of its next generation of leaders;

NOW, THEREFORE, BE IT RESOLVED by the Mayor and Council of the City of Port Wentworth, as follows:

Section 1. Creation and Purpose

There is hereby established a "Port Wentworth Youth Council" to serve as an advisory body, providing recommendations, perspectives, and initiatives on matters affecting youth in the community.

Section 2. Membership

- a) The Youth Council shall consist of up to 12 members representing a diverse cross-section of the City's youth population.
- b) Members shall be residents of the City of Port Wentworth and shall be high school-aged students.
- c) Terms of service, appointment procedures, and any application requirements shall be set forth in administrative guidelines adopted by the Clerk of Council's office.

Section 3. Duties and Responsibilities

The Youth Council shall:

- a) Meet regularly to discuss topics relevant to the City and youth interests.
- b) Assist in planning and promoting youth-related programs, events, and initiatives.
- c) Participate in volunteer opportunities through community service.
- d) Serve as ambassadors for civic engagement among their peers.

Section 4. Support and Administration

- a) The Youth Council shall be supported by designated City staff who will serve as liaisons and provide administrative assistance.
- b) The City shall provide meeting space and reasonable resources to allow the Youth Council to fulfill its mission.

Section 5. Effective Date

This Resolution shall become effective immediately upon its adoption by the Mayor and City Council of the City of Port Wentworth, Georgia.

SO RESOLVED this 21st day of August, 2025.

Approved:

Gary Norton, Mayor

Attest:

Zahnay Smiley, Clerk of Council